

# Submittal of Annual Reports and Other Compliance Documents for Municipal Separate Storm Sewer System (MS4) Permits

NOTE: Missing or incomplete fields are highlighted at the bottom of each page. You may save, close and return to your draft permit as often as necessary to complete your application. After 120 days your draft is **deleted**.

--	--	--	--	--	--	--	--	--	--

Form 3400-224(R8/2021)

## Reporting Information :

Will you be completing the Annual Report or other submittal type?  Annual Report  Other

**Project Name:** 2023 Annual Report

**County:** Waukesha

**Municipality:** Mukwonago, Village

**Permit Number:** S050075

**Facility Number:** 35717

**Reporting Year:** 2023

Is this submittal also satisfying an Urban Nonpoint Source Grant funded deliverable?  Yes  No

## Required Attachments and Supplemental Information

Please complete the contents of each tab to submit your MS4 permit compliance document. The information included in this checklist is necessary for a complete submittal. A complete and detailed submittal will help us review about your MS4 permit document. To help us make a decision in the shortest amount of time possible, the following information must be submitted:

### Annual Report

- Review related web site and instructions for [Municipal storm water permit eReporting \[Exit Form\]](#)
- Complete all required fields on the annual report form and upload required attachments
- Attach the following other supporting documents as appropriate using the attachments tab above
  - Public Education and Outreach Annual Report Summary
  - Public Involvement and Participation Annual Report Summary
  - Illicit Discharge Detection and Elimination Annual Report Summary
  - Construction Site Pollution Control Annual Report Summary
  - Post-Construction Storm Water Management Annual Report Summary
  - Pollution Prevention Annual Report Summary
    - Leaf and Yard Waste Management
    - Municipal Facility (BMP) Inspection Report
    - Municipal Property SWPPP
    - Municipally Property Inspection Report
    - Winter Road Maintenance
  - Storm Sewer Map Annual Report Attachment
  - Storm Water Quality Management Annual Report Attachment

- TMDL Attachment
  - Storm Water Consortium/Group Report
  - Municipal Cooperation Attachment
  - Other Annual Report Attachment
- Attach the following permit compliance documents as appropriate using the attachments tab above
    - Storm Water Management Program
      - Public Education and Outreach Program
      - Public Involvement and Participation Program
      - Illicit Discharge Detection and Elimination Program
      - Construction Site Pollutant Control Program
      - Post-Construction Storm Water Management Program
      - Pollution Prevention Program
        - Municipal Storm Water Management Facility (BMP) Inventory
        - Municipal Storm Water Management Facility (BMP) Inspection and Maintenance Plan
    - Total Maximum Daily Load documents (*\*If applicable, see permit for due dates.*)
      - TMDL Mapping\*
      - TMDL Modeling\*
      - TMDL Implementation Plan\*
      - Fecal Coliform Screening Parameter \*
      - Fecal Coliform Inventory and Map (*S050075-03 general permittees Appendix B B.5.2 – document due to the department by March 31, 2022*)
      - Fecal Coliform Source Elimination Plan (*S050075-03 general permittees Appendix B - document due to the department by October 31, 2023*)
- Sign and Submit form

**Municipal Contact Information- Complete**

**Notice:** Pursuant to s. NR 216.07(8), Wis. Adm. Code, an owner or operator of a Municipal Separate Storm Sewer System (MS4) is required to submit an annual report to the Department of Natural Resources (Department) by March 31 of each year to report on activities for the previous calendar year ("reporting year"). This form is being provided by the Department for the user's convenience for reporting on activities undertaken in each reporting year of the permit term. Personal information collected will be used for administrative purposes and may be provided to the extent required by Wisconsin's Open Records Law [ss. 19.31-19.39, Wis. Stats.].

**Note:** Compliance items must be submitted using the Attachments tab.

**Municipality Information**

**Name of Municipality** Mukwonago, Village

**Facility ID # or (FIN):** 35717

**Updated Information:**  Check to update mailing address information

**Mailing Address:** 440 River Crest Court

**Mailing Address 2:**

**City:** Mukwonago, Village

**State:** WI

**Zip Code:** 53149                      xxxxx or xxxxx-xxxx

**Primary Municipal Contact Person (Authorized Representative for MS4 Permit)**

The "Authorized Representative" or "Authorized Municipal Contact" includes the municipal official that was charged with compliance and oversight of the permit conditions, and has signature authority for submitting permit documents to the Department (i.e., Mayor, Municipal Administrator, Director of Public Works, City Engineer).

Select to **create new** primary contact

**First Name:** Ron

**Last Name:** Bittner

Select to **update** current contact information

**Title:** DPW Director

**Mailing Address:** 440 River Crest Ct

**Mailing Address 2:**

**City:** Mukwonago

**State:** WI

**Zip Code:** 53149                      xxxxx or xxxxx-xxxx

**Phone Number:** 262-363-6447                      Ext:                      xxx-xxx-xxxx

**Email:** rbittner@villageofmukwonago.gov

**Additional Contacts Information (Optional)**

I&E Program

- Individual with responsibility for:**  
**(Check all that apply)**
- IDDE Program
  - IDDE Response Procedure Manual
  - Municipal-wide Water Quality Plan
  - Ordinances
  - Pollution Prevention Program
  - Post-Construction Program
  - Winter roadway maintenance

**First Name:**

**Last Name:**

**Title:**

**Mailing Address:**

**Mailing Address 2:**

**City:**

**State:**

**Zip Code:**

xxxxx or xxxxx-xxxx

**Phone Number:**

Ext:

xxx-xxx-xxxx

**Email:**

### Municipal Billing Contact Person (Authorized Representative for MS4 Permit)

- Select to **create new** Billing contact

**First Name:** Ron

**Last Name:** Bittner

- Select to **update** current contact information

**Title:** Public Works Director

**Mailing Address:** 440 River Crest Ct.

**Mailing Address 2:**

**City:** Mukwoango

**State:** WI

**Zip Code:** 53149

xxxxx or xxxxx-xxxx

**Phone Number:** 262-363-6447

Ext:

xxx-xxx-xxxx

**Email:** rbittner@villageofmukwonago.gov

1. Does the municipality rely on another entity to satisfy some of the permit requirements?

- Yes  No

Public Education and Outreach Waukesha County

Public Involvement and Participation Waukesha County

Illicit Discharge Detection and Elimination

Construction Site Pollutant Control Rukert & Mielke

Post-Construction Storm Water Management

Pollution Prevention

2. Has there been any changes to the municipality's participation in group efforts towards permit compliances (i.e., the municipality has added or dropped consortium membership)?

Yes  No

### Missing Information

Do not close your work until you **SAVE**.

Note: For the minimum control measures, you must fill out all questions in sections 1 through 7.

Form 3400-224 (R8/2021)

**Minimum Control Measures- Section 1 : Complete**

**1. Public Education and Outreach**

- a. Does MS4 conduct any educational efforts or events independently (not with a group)  Yes  No
- b. How many total educational events were held during the reporting year: **2**
- c. Were any of the public education and outreach delivery mechanisms conducted during the reporting year active or interactive?  Yes  No
- d. Please select all storm water topics, target audiences, and delivery mechanisms used in the reporting year

Public Education and Outreach Delivery Mechanisms (Active and Passive)	
Active/Interactive Mechanisms	Passive Mechanisms
<input checked="" type="checkbox"/> Education activities (school presentations, summer camps) <input checked="" type="checkbox"/> Information booth at event <input checked="" type="checkbox"/> Targeted group training (contractors, consultants, etc.) <input checked="" type="checkbox"/> Government event (public hearing, council meeting) <input checked="" type="checkbox"/> Workshops <input checked="" type="checkbox"/> Tours <input checked="" type="checkbox"/> Other: Community engagement	<input checked="" type="checkbox"/> Passive print media (brochures at front desk, posters, etc.) <input checked="" type="checkbox"/> Distribution of print media (mailings, newsletters, etc.) via mail or email. <input checked="" type="checkbox"/> Media offerings (radio and TV ads, press release, etc.) <input checked="" type="checkbox"/> Social media posts <input checked="" type="checkbox"/> Signage <input checked="" type="checkbox"/> Website <input checked="" type="checkbox"/> Other: Community engagement

Topics Covered	Target Audience
<input checked="" type="checkbox"/> Illicit discharge detection and elimination <input checked="" type="checkbox"/> Household hazardous waste disposal/pet waste management/vehicle washing <input checked="" type="checkbox"/> Yard waste management/pesticide and fertilizer application <input checked="" type="checkbox"/> Stream and shoreline management <input checked="" type="checkbox"/> Residential infiltration <input checked="" type="checkbox"/> Construction sites and post-construction storm water management <input checked="" type="checkbox"/> Pollution prevention <input checked="" type="checkbox"/> Green infrastructure/low impact development <input type="checkbox"/> Other:	<input checked="" type="checkbox"/> General Public <input checked="" type="checkbox"/> Public Employees <input checked="" type="checkbox"/> Residents <input checked="" type="checkbox"/> Businesses <input checked="" type="checkbox"/> Contractors <input checked="" type="checkbox"/> Developers <input checked="" type="checkbox"/> Industries <input checked="" type="checkbox"/> Public Officials <input type="checkbox"/> Other:

- e. Will additional information/summary of these education events be attached to the annual report?  
 Yes  No

If no, please provide additional comment in the brief explanation box below. *Limit response to 250 characters and/or attach supplemental information on the attachments page.*

A booth was displayed at National Night Out on stormwater education. Met with the Fox River View HOA board to discuss BMP maintenance. The village contracts with Waukesha County for PE & OR.

## Missing Information

Do not close your work until you **SAVE**.

Note: For the minimum control measures, you must fill out all questions in sections 1 through 7

Form 3400-224 (R8/2021)

## Minimum Control Measures - Section 2 : Complete

### 2. Public Involvement and Participation

a. Permit Activities. Select all of the following topics the Permittee did to engage public participation and involvement.

Topics Covered	Target Audience	Estimated People Reached (Optional)	Regional Effort (Optional)
<input checked="" type="checkbox"/> MS4 Annual Report <input checked="" type="checkbox"/> Storm Water Management Program <input checked="" type="checkbox"/> Storm Water related ordinance <input type="checkbox"/> Other:	<input checked="" type="checkbox"/> General Public <input checked="" type="checkbox"/> Public Employees <input checked="" type="checkbox"/> Residents <input checked="" type="checkbox"/> Businesses <input checked="" type="checkbox"/> Contractors <input checked="" type="checkbox"/> Developers <input checked="" type="checkbox"/> Industries <input type="checkbox"/> Public Officials <input type="checkbox"/> Other	101 +	<input checked="" type="radio"/> Yes <input type="radio"/> No

b. Volunteer Activities. Select all of the following audiences targeted for volunteer involvement and participation related to storm water.

NA (Individual Permittee)

Topics Covered	Target Audience	Estimated People Reached (Optional)	Regional Effort (Optional)
Volunteer Opportunity	<input checked="" type="checkbox"/> General Public <input checked="" type="checkbox"/> Public Employees <input checked="" type="checkbox"/> Residents <input checked="" type="checkbox"/> Businesses <input checked="" type="checkbox"/> Contractors <input checked="" type="checkbox"/> Developers <input checked="" type="checkbox"/> Industries <input checked="" type="checkbox"/> Public Officials <input type="checkbox"/> Other	101 +	<input checked="" type="radio"/> Yes <input type="radio"/> No

c. Brief explanation on Public Involvement and Participation reporting. *Limit response*

to 250 characters and/or attach supplemental information on the attachments page.

The annual report was presented to the village board at the 3/15/23 meeting. Adopt a Drain participants are asked to clean twice per month and report quantiles. Stream bank monitors collect data for local waters. Residents conduct clam surveys.

## Missing Information

Do not close your work until you SAVE.

Note: For the minimum control measures, you must fill out all questions in sections 1 through 7

Form 3400-224 (R8/2021)

### Minimum Control Measures - Section 3 : Complete

#### 3. Illicit Discharge Detection and Elimination

- |   |     |
|---|-----|
| a. How many total outfalls does the municipality have?  | 141 |
| b. How many outfalls did the municipality evaluate as part of their routine ongoing field screening program?  | 24  |
| c. From the municipality's routine screening, how many were confirmed illicit discharges?   | 0   |
| d. How many illicit discharge complaints did the municipality receive?  | 3   |
| e. From the complaints received, how many were confirmed illicit discharges?  | 3   |
| f. How many of the identified illicit discharges did the municipality eliminate in the reporting year (from both routine screening and complaints)? | 3   |
- (If the sum of 3.c. and 3.e. does not equal 3.f., please explain below.)
- g. What types of regulatory mechanisms does the municipality have available to compel compliance with this program? Check all that are available and how many times each were used in the reporting year.
- |   |   |
|---|---|
| <input checked="" type="checkbox"/> Verbal Warning                    | 3 |
| <input checked="" type="checkbox"/> Written Warning (including email) | 3 |
| <input checked="" type="checkbox"/> Notice of Violation               | 3 |
| <input checked="" type="checkbox"/> Civil Penalty/ Citation           | 0 |

Additional Information:

- h. Brief explanation on Illicit Discharge Detection and Elimination reporting. *If you marked Unsure for any questions above, justify the reasoning. Limit response to 250 characters and/or attach supplemental information on the attachments page.*

Staff evaluate priority outfalls and one fifth of the major outfalls annually. Residents and businesses can report Illicit discharges via the website, email or phone.

## Missing Information



Note: For the minimum control measures, you must fill out all questions in sections 1 through 7

**Minimum Control Measures - Section 4 : Complete**

**4. Construction Site Pollutant Control**

- a. How many total construction sites with one acre or more of land disturbing construction activity were active at any point in the reporting year? 13
- b. How many construction sites with one acre or more of land disturbing construction activity did the municipality issue permits for in the reporting year? 2
- c. How many erosion control inspections did the municipality complete in the reporting year (at sites with one acre or more of land disturbing construction activity)? 141
- d. What types of regulatory mechanisms does the municipality have available to compel compliance with this program? Check all that are available and how many times each were used in the reporting year.
 

<input checked="" type="checkbox"/> Verbal Warning	69
<input checked="" type="checkbox"/> Written Warning (including email)	69
<input checked="" type="checkbox"/> Notice of Violation	0
<input checked="" type="checkbox"/> Civil Penalty/ Citation	0
<input checked="" type="checkbox"/> Stop Work Order	0
<input checked="" type="checkbox"/> Forfeiture of Deposit	0
<input type="checkbox"/> Other - Describe below	
- e. Brief explanation on Construction Site Pollutant Control reporting . *If you marked Unsure for any questions above, justify the reasoning. Limit response to 250 characters and/or attach supplemental information on the attachments page.*

The village contracts with R&M for CSP control inspections. Village staff receives copies of all inspections for review. Village staff monitor construction sites periodically while conduction village operations.

**Missing Information**

Note: For the minimum control measures, you must fill out all questions in sections 1 through 7

**Minimum Control Measures - Section 5 : Complete**

**5. Post-Construction Storm Water Management**

- a. How many new structural storm water management Best Management Practice (BMP) have received local approval ? 0  
 \*Engineered and constructed systems that are designed to provide storm water quality control such as wet detention ponds, constructed wetlands, infiltration basins, grassed swales, permeable pavement,
- b. Does the MS4 have procedures for inspecting and maintaining private storm water facilities?  Yes  No
- c. If Yes, how many privately owned storm water management facilities were inspected in the reporting year ? 31  
 Inspections completed by private landowners should be included in the reported number.
- d. Does the municipality utilize privately owned storm water management BMP in its pollutant reduction analysis?  Yes  No
- e. Does MS4 have maintenance authority on these privately owned BMPs?  
 Yes, via SWMA and ordinance.
- f. How many municipally operated (private) storm water management BMPs were inspected in the reporting year? 31
- g. What types of enforcement actions does the municipality have available to compel compliance with the regulatory mechanism? Check all that apply and enter the number of each used in the reporting year.
- |   |   |
|---|---|
| <input checked="" type="checkbox"/> Verbal Warning                    | 1 |
| <input checked="" type="checkbox"/> Written Warning (including email) | 1 |
| <input checked="" type="checkbox"/> Notice of Violation               | 0 |
| <input checked="" type="checkbox"/> Civil Penalty/ Citation           | 0 |
| <input checked="" type="checkbox"/> Forfeiture of Deposit             | 0 |
| <input checked="" type="checkbox"/> Complete Maintenance              | 0 |
| <input checked="" type="checkbox"/> Bill Responsible Party            | 0 |
| <input type="checkbox"/> Other - Describe below                       |   |

e. Brief explanation on Post-Construction Storm Water Management reporting . *If marked 'Unsure' on any questions above, justify your reasoning. Limit your response to 250 characters and/or attach supplemental information on the attachments page.*

Village staff inspect municipal BMPs. Private ponds are inspected by their owners per SWMA and ordinance guidelines.

### Missing Information

Do not close your work until you **SAVE**.

Note: For the minimum control measures, you must fill out all questions in sections 1 through 7

## Minimum Control Measures - Section 6 : Complete

### 6. Pollution Prevention

Storm Water Management Best Management Practice Inspections  Not Applicable

- a. Enter the total number of municipally owned or operated (i.e., privately owned BMPs) structural storm water management best management practices. 110
- b. How many new municipally owned storm water management best management practices were installed in the reporting year? 0
- c. How many municipally owned (public) storm water management best management practices were inspected in the reporting year? 16
- d. What elements are looked at during inspections (250 character limit)?  
Erosion, animal activity and burrows, invasive vegetation, structure damage and pool quality.
- e. How many of these facilities required maintenance? 5
- f. Brief explanation on Storm Water Management Best Management Practice inspection reporting. *If you marked Unsure for any questions above, justify the reasoning. Limit response to 250 characters and/or attach supplemental information on the attachments page.*

Village staff inspect municipal BMPs. Private ponds are inspected by their owners per SWMA and ordinance guidelines.

Public Works Yards & Other Municipally Owned Properties that require a stormwater pollution prevention plan (SWPPP)\*  Not Applicable

- g. How many municipal properties require a SWPPP? 1
- h. How many inspections of municipal properties have been conducted in the reporting year? 4
- i. Have amendments to the SWPPPs been made?  
 Yes  No
- j. If yes, describe what changes have been made. Limit response to 250 characters and/or attach supplemental information on the attachment page:
- k. Brief explanation on Storm Water Pollution Prevention Plan reporting. *If you marked Unsure for any questions above, justify the reasoning. Limit response to 250 characters and/or attach supplemental information on the attachments page.*  
The DPW facility is maintained daily with inspections conducted quarterly. Staff address issues when discovered. Staff rotate on inspections and new employee training is conducted during the process.

\* Any municipally owned property that has the potential to generate stormwater pollution should have a SWPPP. For example, if a municipal property stores compost piles, material storage, yard wastes, etc., outside and can contaminate stormwater runoff—a SWPPP is required.

Collection Services - Street Sweeping Program  Not Applicable

- l. Did the municipality conduct street sweeping during the reporting year?  
 Yes  No
- m. If known, how many tons of material was removed? 50
- n. Does the municipality have a low hazard exemption for this material?  Yes  No
- o. If street sweeping is identified as a storm water best management practice in the pollutant loading analysis, was street cleaning completed at the assumed frequency?  
 Yes - Explain frequency Urban street sections are swept four time a year.  
 No - Explain \_\_\_\_\_  
 Not Applicable

Collection Services - *Catch Basin Sump Cleaning Program*  Not Applicable

- p. Did the municipality conduct catch basin sump cleaning during the reporting year?  Yes  No
- q. How many catch basin sumps were cleaned in the reporting year? 275
- r. If known, how many tons of material was collected? 36
- s. Does the municipality have a low hazard exemption for this material?  Yes  No
- t. If catch basin sump cleaning is identified as a storm water best management practice in the pollutant loading analysis, was cleaning completed at the assumed frequency?  
 Yes- Explain frequency One of five zones are cleaned annually.  
 No - Explain \_\_\_\_\_  
 Not Applicable

Collection Services - *Leaf Collection Program*  Not Applicable

- u. Does the municipality conduct curbside leaf collection?  Yes  No
- v. Does the municipality notify homeowners about pickup?  Yes  No
- w. Where are the residents directed to store the leaves for collection?  
 Pile on terrace  Pile in street  Bags on terrace  
 Other - Describe \_\_\_\_\_
- x. What is the frequency of collection?  
 2 of the 8 yard waste collection target leaf collection.
- y. Is collection followed by street sweeping?  Yes  No
- z. Brief explanation on Collection Services reporting. *Limit response to 250 characters and/or attach supplemental information on the attachments page*

The village contracts with Johns Disposal for yard waste collections. Bags or reusable containers are placed on the terrace for collection. Leaves that collect naturally on the street are swept up by village staff.

Winter Road Management  Not Applicable

\*Note: We are requesting information that goes beyond the reporting year, answer the best you can.

aa. How many lane-miles of roadway is the municipality responsible for doing snow and ice control? (One mile of a two-way road equals two lane miles.) 93

ab. Provide amount of de-icing products used by month last winter season?  
Solids (tons) (ex. sand, or salt-sand)

Product	Oct	Nov	Dec	Jan	Feb	Mar
Salt	0	4	16	234	17	290

Liquids (gallons) (ex. brine)

	Oct	Nov	Dec	Jan	Feb	Mar
Brine	0	550	219	3546	3200	3524

ac. Was salt applying machinery calibrated in the reporting year?  Yes  No

ad. Have municipal personnel attended salt reduction strategy training in the reporting year?  Yes  No

Training Date	Training Name	# Attendance
11/6/2023	Calibration Day	6

ae. Brief explanation on Winter Road Management reporting. If you marked Unsure for any questions above, justify the reasoning. Limit response to 250 characters and/or attach supplemental information on the attachments page

Material is dispensed as needed to be effective for the operation. Staff participate in truck calibration. Each driver records transmission pulses, measures weights and volumes and enters the data into the controller.

### Internal (Staff) Education & Communication

af. Has the municipality provided an opportunity for internal training or education to staff implementing the municipality's procedures for each of the pollution prevention program element?  Yes  No

If yes, describe what training was provided (250 character limit):

SWPPP inspections, calibration day, pond inspections and street sweeper operations.

ag. Describe how the municipality has kept the following local officials and municipal staff aware of the municipal storm water discharge permit programs, procedures and pollution prevention program requirements.

Elected Officials

Village board and plan commission meetings, annual reports and staff meetings.

Municipal Officials

Village board and plan commission meetings, annual reports and staff meetings.

Appropriate Staff ( such as operators, Department heads, and those that interact with public)

Department meetings and training sessions

- a. Brief explanation on Internal Education reporting. *If you marked Unsure for any questions above, justify the reasoning. Limit response to 250 characters and/or attach supplemental information on the attachments page.*

Internal refresher and new employee training is conducted through the inspection process. Ordinance I and developments need to be approved by the village board.

## Missing Information

Do not close your work until you **SAVE**.

Note: For the minimum control measures, you must fill out all questions in sections 1 through 7

Form 3400-224 (R8/2021)

## Minimum Control Measures - Section 7 : Complete

### 7. Storm Sewer System Map

- a. Did the municipality update their storm sewer map this year?

Yes  No

If yes, check the areas the map items that got updated or changed:

Storm water treatment facilities

Storm pipes

Vegetated swales

Outfalls

Other - Describe below

- b. Brief explanation on Storm Sewer System Map reporting. *If you marked Unsure for an question for any questions above, justify the reasoning. Limit response to 250 characters and/or attach supplemental information on the attachments page.*

## Missing Information

Do not close your work until you SAVE.

Form 3400-224 (R8/2021)

### Final Evaluation - Complete

#### Fiscal Analysis

Complete the fiscal analysis table provided below. For municipalities that do not break out funding into permit program elements, please enter the monetary amount to your best estimate of what funding may be going towards these programs.

Annual Expenditure Reporting Year	Budget Reporting Year	Budget Upcoming Year	Source of Funds
-----------------------------------	-----------------------	----------------------	-----------------

#### Element: Public Education and Outreach

2304	2250	2250	<u>General revenue fund</u>
187	194	194	<u>Storm water utility</u>

#### Element: Public Involvement and Participation

2304	2250	2250	<u>General revenue fund</u>
187	194	194	<u>Storm water utility</u>

#### Element: Illicit Discharge Detection and Elimination

2801	4417	2865	<u>General revenue fund</u>
3743	5420	3882	<u>Storm water utility</u>

#### Element: Construction Site Pollutant Control

10000	7500	7500	<u>General revenue fund</u>
6500	6500	10000	<u>Permit fee and/or deposit/escrow</u>

#### Element: Post-Construction Storm Water Management

6023	4858	5984	<u>General revenue fund</u>
6550	12525	6794	<u>Storm water utility</u>

#### Element: Pollution Prevention

30392	30362	31941	<u>General revenue fund</u>
6550	12525	6794	<u>Storm water utility</u>

Other (describe)

Select...

Please provide a justification for a "0" entered in the Fiscal Analysis. *Limit response to 250 characters.*

### Water Quality

**a:** Were there any known water quality improvements in the receiving waters to which the municipality's storm sewer system directly discharges to?

Yes  No  Unsure      If Yes, explain below:

**b:** Were there any known water quality degradation in the receiving waters to which the municipality's storm sewer system directly discharges to?

Yes  No  Unsure      If Yes, explain below:

**c:** Have any of the receiving waters that the municipality discharges to been added to the impaired waters list during the reporting year?

Yes  No  Unsure

**d:** Has the municipality evaluated their storm water practices to reduce the pollutants of concern?

Yes  No  Unsure

### Storm Water Quality Management

**a.** Has the municipality completed or updated modeling in the reporting year (relating to developed urban area performance standards of s. NR 151.13(2)(b)1., Wis. Adm. Code)?  Yes  No

**b.** If yes, enter percent reduction in the annual average mass discharging from the entire MS4 to surface waters of the state as compared to implementing no storm water management controls:

Total suspended solids (TSS)

Total phosphorus (TP)

### Additional Information

Based on the municipality's storm water program evaluation, describe any proposed changes to the municipality's storm water program. *If your response exceeds the 250 character limit, attach supplemental information on the attachments page.*

The village is committed to their MS4 general permit and continues to provide the required financial support. The Illinois-Fox watershed TMDL will require updates to the stormwater plan. We are discussing project timing for possible grant planning.



## Missing Information

Do not close your work until you SAVE.

--	--	--	--	--	--	--

Form 3400-224 (R8/2021)

### Requests for Assistance on Understanding Permit Programs

Would the municipality like the Department to contact them about providing more information on understanding any of the Municipal Separate Storm Sewer Permit programs?

Please select all that apply:

- Public Education and Outreach
- Public Involvement and Participation
- Illicit Discharge Detection and Elimination
- Construction Site Pollutant Control
- Post-Construction Storm Water Management
- Pollution Prevention
- Storm Water Quality Management
- Storm Sewer System Map
- Water Quality Concerns
- Compliance Schedule Items Due
- MS4 Program Evaluation

Do not close your work until you **SAVE**.

Form 3400-224(R8/2021)

## Required Attachments and Supplemental Information

Any other MS4 program information for inclusion in the Annual Report may be attached on here. Use the Add Additional Attachments to add multiple documents.

Upload Required Attachments (15 MB per file limit) - [Help reduce file size and trouble shoot file uploads](#)

\*Required Item

Note: To replace an existing file, use the 'Click here to attach file ' link or press the to delete an item.

### Attach - Other Supporting Documents

#### AR EO

 File Attachment

[z Ledger-of-activities23.pdf](#)

#### AR IP

 File Attachment

[z Ledger-of-activities23.pdf](#)

#### AR IDDE

 File Attachment

[z Illicit Discharge Summary Report 2.pdf](#)

#### AR LeafYardMgmt

 File Attachment

[z Leaf and Yard Waste MAnagment AR.pdf](#)

#### AR MuniSWPPP

 File Attachment

[z Municipal Facility SWPPP AR.pdf](#)

#### AR BMPInspSum

 File Attachment

[z Municipal BMP Inspection Report.pdf](#)

#### AR PP

 File Attachment

[z Pollution Prevention AR Summary.pdf](#)

#### AR WintRdMain

 File Attachment

[z Winter Road Maintenance AR.pdf](#)

(To remove items, use your cursor to hover over the attachment section. When the drop down arrow appears, select remove item)

## Attach - Permit Compliance Documents

(To remove items, use your cursor to hover over the attachment section. When the drop down arrow appears, select remove item)

## Missing Information

Draft and Share PDF Report with the permittee's governing body or delegated representatives.

Press the button below to create a PDF. The PDF will be sent to the email address associated with the WAMS ID that is signed in. After the annual report has been reviewed by the governing body or delegated representative, return to the MS4 eReporting System to submit the final report to the DNR.

[Draft and Share PDF Report](#)

**Sign and Submit Your Application**

**Steps to Complete the signature process**

1. Read and Accept the Terms and Conditions
2. Press the Submit and Send to the DNR button

**NOTE:** For security purposes all email correspondence will be sent to the address you used when registering your WAMS ID. This may be a different email than that provided in the application. For information on your WAMS account click [HERE](#).

**Terms and Conditions**

**Certification:** I hereby certify that I am an authorized representative of the municipality covered under Mukwonago, Village MS4 Permit for which this annual report or other compliance document is being submitted, and that the information contained in this submittal and all attachments were gathered and prepared under my direction or supervision. Based on my inquiry of the person or persons under my direction or supervision involved in the preparation of this document, to the best of my knowledge, the information is true, accurate, and complete. I further certify that the municipality's governing body or delegated representatives have reviewed or been apprised of the contents of this annual report. I understand that Wisconsin law provides severe penalties for submitting false information.

Signee (must check current role prior to accepting terms and conditions)

- Authorized municipal contact using WAMS ID.
- Delegation of Signature Authority ( Form 3400-220 ) for agent signing on the behalf of the authorized municipal contact.
- Agent seeking to share this item with authorized municipal contact (authorized municipal contact must get WAMS id and complete signature).

**Name:** *Ronald R Bettner Ron BETTNER*  
**Title:** *PUBLIC WORKS DIRECTOR*

Authorized Signature.  
 I accept the above terms and conditions.

After providing the final authorized signature, the system will send an email to the authorized party and any agents. This email will include a copy to the final read only version of this application.

# INFORMATION AND EDUCATION LEDGER OF ACTIVITIES

Target - from workshop	Req #	req2	req3	Program Name	Activity	Column1	Date	Where	# People	Additional Description or Information
Teachers and Students	7			Nature Exploration	hike		1-5-23	Retzer	62	Nature Exploration program with Oconomowoc High School with water temperature investigation and discussion
General Public	7			Nature Exploration	presentation		1-23-23	Retzer	739	Statewide Salt Awareness Week webinar: Freshwater Salinization Syndrome
General Public	7			Nature Exploration	presentation		1-24-23	Retzer	387	SAW week webinar: Tracking Road Salt
General Public	7			Nature Exploration	presentation		1-25-23	Retzer	366	SAW week webinar: Salty Drinking Water
General Public	7			Nature Exploration	presentation		1-26-23	Retzer	255	SAW week webinar: DNR response to salt
General Public	7			Nature Exploration	presentation		1-27-23	Retzer	224	SAW week webinar: Be A Salt Champion
Teachers and Students	1	3	5	Glacial landscape	hike		1-27-23	Retzer	45	glacial program including soil formation and importance of organic matter for infiltration
Teachers and Students	1	3	5	career	presentation		1-27-23	Retzer	40	career day with Wales Elementary
General Public	1	3	5	career	displays and handouts		2-21-23	Waukesha	1261	display at Town of Waukesha primary elections covering yard waste management
General Public	1	3	5	career	displays and handouts		2-28-23	Waukesha	50	storm drain delivers to lakes and rivers message at United Way mini golf event for Waukesha County
General Public	1	3	5	career	presentation		3-1-23	Retzer	12	water cycle hike to learn about water moving through the environment
Teachers and Students	5	3	3	5 Live in	presentation		3-3-23	Retzer	155	recycling program covering composting and improving water capture with compost
Teachers and Students	1	3	5	5 Live in	presentation		3-6-23	Pewaukee	7	after school environmental club learned about water pollution and how they can prevent it
General Public	1	3	5	career	presentation		3-6-23	Retzer	12	training for Retzer volunteers to teach some talking points about water—talked about runoff, groundwater, storm drains and more
Teachers and Students	1	3	5	career	presentation		3-8-23	New Berlin	104	Career day for Ronald Reagan Elementary School
General Public	3			career	social media		3-15-23		2689	social media post about naturalizing the yard at Retzer—leaving dandelions and violets for pollinators and seeding clover to feed the grass
General Public	1			career	press release		3-22-23		92	press release about Adopt a Drain for World Water Day
Teachers and Students	1	3	5	career	presentation		3-24-23	New Berlin	25	appreciation event for Volunteer Stream Monitoring
General Public	9			rain gardens	presentation		4-1-23	Retzer	60	rain garden program for 2 classes at Montessori school in Waukesha
Teachers and Students	5	2	3	rain gardens	displays and handouts		4-4-23	Waukesha	1905	display for Town of Waukesha spring elections
General Public	1	2	3	rain gardens	displays and handouts		4-4-23	Waukesha	1072	storm drain display for Town of Brookfield spring elections
General Public	1	2	3	Live in	presentation		4-4-23	Brookfield	32	water program for Magee Elementary Science Day
Teachers and Students	3	5	5	Healthy Soils	presentation		4-6-23	Genesee	34	soils program for Magee Elementary Science Day
Teachers and Students	3	5	5	Healthy Soils	presentation		4-6-23	Genesee	55	presentation for Waukesha Public Library
General Public	2			Sustainable Yardenir stormwater wkshop	presentation		4-11-23	Waukesha	135	
Contractors, Dev & Consul	1			stormwater wkshop	presentation		4-12-23		135	
General Public	1			stormwater wkshop	presentation		4-13-23		155	
General Public	2	3	5	rain gardens and bar presentation	presentation		4-17-23	Retzer	13	talked about runoff pollution with girl scouts
General Public	2	3	5	rain gardens and bar presentation	presentation		4-18-23	Oconomowoc	4	Rain gardens and Rain Barrel program at Oconomowoc Library
Teachers and Students	5	2	3	glacial landscape	presentation		4-20-23	Retzer	15	watershed model for girl scouts working on Wonders of Water badge
General Public	1	2	3	career	displays and handouts		4-20-23	Oconomowoc	120	used watershed model at Parklawn Elementary STEM Night with parents and students
Teachers and Students	1	2	3	career	displays and handouts		4-21-23	Oconomowoc	140	cover soils and infiltration
General Public	1	2	3	career	displays and handouts		4-21-23	Mukwonago	45	used watershed model at Park View Middle School
General Public	1	2	3	career	displays and handouts		4-22-23	Retzer	163	used watershed model for earth day celebration in Elm Grove
General Public	1	2	3	rain gardens	presentation		4-22-23	Elm Grove	32	Rain Garden design and installation class for Pewaukee Library in conjunction with Pewaukee Green Team
General Public	2	3	5	rain gardens	presentation		4-25-23	Pewaukee	52	Healthy Soils program for Cushing Elementary 2nd grade
General Public	3	5	5	Healthy Soils	presentation		4-26-23	Retzer	1	met with Homeowners Association to discuss pond maintenance
General Public	6			WAV training	meeting		5-4-23	Muskego	10	Water Action Volunteers training day
General Public	1	2	3	WAV training	training		5-6-23	Genesee	60	composting as part of recycling program
Teachers and Students	5			pond	presentation		5-10-23	Retzer	77	watershed model with Pond program
Teachers and Students	1	2	3	pond	presentation		5-10-23	Retzer	2	benchmark on Oconomowoc River at Highway K
General Public	9			water resources	benchmark		5-11-23	Oconomowoc	200	presentation to 5th grade before trip to camp
Teachers and Students	1	2	3	water resources	benchmark		5-12-23	Pewaukee	2	benchmark visit for Pewaukee River at old SH164
General Public	9			pond	presentation		5-16-23	Pewaukee	19	Secrets of Stream Life program for Outdoor Classroom at Retzer
General Public	9			pond	presentation		5-17-23	Retzer	64	watershed model with pond program
Teachers and Students	1	5	5	pond	presentation		5-17-23	Retzer	4	benchmark visit for Bark River at Hwy 67
General Public	9			healthy soils	benchmark		5-19-23	Bark River	2	benchmark visit for Mill Brook
General Public	9			healthy soils	benchmark		5-20-23	Vernon	60	healthy soils program for Eagleville Elementary
Teachers and Students	3	5	5	healthy soils	benchmark		5-22-23	Retzer	9	site visit for Cocco Creek with Pewaukee Women's Club
General Public	9			lake study	benchmark		5-22-23	Pewaukee	2	benchmark for Oconomowoc River at Concord Rd
General Public	9			lake study	benchmark		5-22-23	Oconomowoc	2	benchmark for Oconomowoc River at Hwy 67
Teachers and Students	1	2	3	lake study	presentation		5-25-23	Camp Whitcomb	130	Lake study program for Pewaukee 5th graders
Teachers and Students	1	2	3	lake study	presentation		5-26-23	Camp Whitcomb	110	watershed model with pond program for Merton Elementary
Teachers and Students	1	2	3	stream study	presentation		6-2-23	Retzer	28	biotic index on Jericho Creek with Eagleville Elementary
Teachers and Students	1	2	3	stream study	presentation		6-2-23	Eagleville	60	stream study with pollution discussion with Saratoga Stem Middle School
Teachers and Students	1	2	3	stream study	presentation		6-5-23	Prairie Springs	15	watershed model with pond program
General Public	1	2	3	stream study	presentation		6-7-23	Retzer	42	watershed model with pond program for homeschool group
Teachers and Students	1	2	3	stream study	presentation		6-9-23	Retzer	150	stream study with pollution discussion with Eagleville Elementary Summer School program
Teachers and Students	1	2	3	stream study	presentation		6-13-23	Eagleville	2	benchmark monitoring for Bark River at Dorn Road
General Public	9			Environmental Science	benchmark		6-13-23	Retzer	20	soil and water portions of Environmental Science Merit Badge
General Public	1	3	5	Environmental Science	presentation		6-15-23	Merton	32	Sustainable Business program covering salt use and winter maintenance as well as green infrastructure management
General Public	7			Sustainable Business	presentation		6-20-23	Retzer	100	watershed model at Clean Water Festival
General Public	1	2	3	Sustainable Business	displays and handouts		6-20-23	Retzer	100	native plant roots display and rain garden information at Clean Water Festival
General Public	5	8	8	Sustainable Business	displays and handouts		6-24-23	Pewaukee	100	imperious surfaces display and fishing activity for Clean Water Festival
General Public	1	5	5	Sustainable Business	displays and handouts		6-24-23	Pewaukee	100	imperious surfaces display and fishing activity for Clean Water Festival
General Public	9			healthy soils	benchmark		6-29-23	Merton	2	Benchmark for Bark River at Dorn Rd
General Public	9			healthy soils	benchmark		6-29-23	Merton	300	unstaffed display for beer garden event
Teachers and Students	1	3	3	Live in a	displays and handouts		7-14-23	Wales	30	used watershed model as part of the pond program
Teachers and Students	1	2	3	Live in a	presentation		7-14-23	Retzer	40	program for Kettle Moraine Garden Club
General Public	1	2	3	Live in a	presentation		7-20-23	Delafield		

General Public	1	1	7-21-23	Pewaukee	50 outreach at Touch a Truck event at Pewaukee Library
General Public	1	2	7-21-23	Retzer	20 training for Master Naturalist program covering groundwater, water pollution, stream monitoring
General Public	9	3	7-25-23	Prairie Springs	8 training for habitat assessment in WAV
General Public	1		7-26-23	Hartland	400 outreach at Hartland Kids Fest
General Public	9		7-27-23	Mukwonago	10 Asian Clam survey on Mukwonago River
General Public	1		8-1-23	Mukwonago	200 storm drain display at National Night out event
General Public	1	3	8-1-23	Merton	200 display for National Night out event
General Public	1		8-2-23	Sussex	200 storm drain display at National Night out event
General Public	1		8-8-23	Oconomowoc	500 departmental outreach at Kids Fest event
General Public	1	2	8-9-23	Retzer	6 Sustainable Gardening presentation
General Public	1	2	8-9-23	Retzer	30 stormwater activities including rain gardens, impervious surfaces, water monitoring, watershed model and more
General Public	9		8-10-23	Hartland	4 Asian Clam survey on Bark River at Nixon Park
General Public	1	3	8-12-23	Wales	200 unstaffed display for beer garden event
General Public	9		8-19-23	Mukwonago	9 Snapshot Day search for invasive species
Teachers and Students	1		8-22-23	Retzer	80 program with aquatic invertebrates
General Public	5		8-22-23	Retzer	appearance on Fox 6 to promote rain gardens and Sustainability Fair
General Public	5		8-26-23	Retzer	7 demonstration on rain gardens at Sustainability Fair
General Public	1	2	8-26-23	Retzer	9 Sustainable Gardening program at Sustainability Fair
Teachers and Students	6	8	29-23	WCTC	13 Virtual program for WCTC Sustainable Building Class
General Public	2	3	9-6-23	The Morning Blend	Appearance on the Morning Blend on WTMJ covering storm drains and keeping them clean
General Public	1	3	9-8-23	Wales	40 unstaffed display for beer garden event
Teachers and Students	3	5	9-11-23	Waukesha	46 Hillcrest Elementary Healthy Soils—two classes
Teachers and Students	3	5	9-12-23	Waukesha	54 Prairie Elementary—two classes
Teachers and Students	3	5	9-13-23	Waukesha	108 healthy soils program for 4 classes at Rose Glen Elementary
Teachers and Students	1	7	9-14-23	Brookfield	25 stream monitoring with 7th grade from St. Mary's, Elm Grove
General Public	1	2	9-15 to 17	North Prairie	9 program using watershed model for Elmbrook Library
General Public	1	2	9-18-23	Pewaukee	500 display at Fall Festival event
Teachers and Students	3	5	9-20-23	Waukesha	8 Met with Pewaukee Ladies Club for fall monitoring
General Public	5		9-23-23	Retzer	20 Waukesha STEM at the old Whittier campus
Businesses	7		9-26-23	Muskego	1800 impervious surfaces display and fishing activity for Apple Harvest Fest
Teachers and Students	1	2	10-23	Waukesha	6 met with Badger Color Concentrates to review stormwater plan
Teachers and Students	1	3	10-23	Retzer	614 worked with Waukesha School district to have watershed model used with all 5th grade programs
Teachers and Students	1	2	10-5-23	Waukesha	10 Incredible Water Journey with class from Hamilton High School
Teachers and Students	1	2	10-9-23	Waukesha	60 3 classes of 5th graders at Hadfield Elementary talking about runoff pollution with watershed model
Teachers and Students	1	2	10-10-23	Eagleville	24 watershed program with model at Saratoga STEM academy
Teachers and Students	1	2	10-10-23	Pewaukee	37 water testing on Jericho Creek with Eagleville Elementary
Teachers and Students	1	2	10-12-23	Retzer	42 watershed model at career day at Pewaukee High School
Teachers and Students	1	2	10-20-23	WCTC	80 Watershed program for 3rd grade from Clarendon Ave Elementary from Mukwonago
Teachers and Students	6	8	11-1-23	WCTC	25 Virtual program for WCTC Sustainable Building Class
Contractors, Dev & Const	7		11-2-23	Retzer	38 Saltwise training for parking lots and sidewalks
General Public	1	2	11-4-23	Retzer	200 hands on activity table covering salt use at Science Fest
General Public	7	3	11-4-23	Retzer	64 presentation with the watershed model at Science Fest
Teachers and Students	1	5	11-16-23	Waukesha	21 horse management workshop to cover manure storage and spreading
General Public	2	3	11-28-23	Sussex	52 water testing for Sussex Hamilton AP students
Teachers and Students	1	2	12-5-23	Merton	300 display at annual tree lighting and community center open house
Teachers and Students	1	2	12-11-23	Wales	64 career day at Kettle Moraine High school
General Public	2	3	12-6-23	Pewaukee	300 display at City of Pewaukee through the end of the year during tax payment season

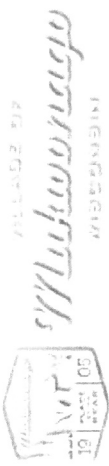

# Illicit Discharge Inspection Summary Report

## Illicit Discharge Flow Present? No

Work Order ID	Description	BMP Name	Location	Date
WO ID: 071423019	Outfall ID: Minors Dr and Fritz Way	705Monors Dr.		7/14/2023 8:00:00 AM
	Nearest Intersection: Minors Dr and Fritz Way	Flow Present? <input type="checkbox"/> No	Flow Description: <input type="text"/>	Inspector: Ron Bittner
	Odor? <input type="checkbox"/> False	Deposits? <input type="checkbox"/> False	Floatables? <input type="checkbox"/> False	Sample taken from: <input type="text"/>
	WO ID: 071423020	Outfall ID: Minors Dr and Fritz Way	641 Minors Dr.	7/14/2023 8:00:00 AM
	Nearest Intersection: Minors Dr and Fritz Way	Flow Present? <input type="checkbox"/> No	Flow Description: <input type="text"/>	Inspector: Ron Bittner
	Odor? <input type="checkbox"/> False	Color Issue? <input type="checkbox"/> False	Deposits? <input type="checkbox"/> False	Floatables? <input type="checkbox"/> False
	WO ID: 071423021	Outfall ID: Minors Dr and Fritz Way	633 Minors Dr.	7/14/2023 8:00:00 AM
	Nearest Intersection: Minors Dr and Fritz Way	Flow Present? <input type="checkbox"/> No	Flow Description: <input type="text"/>	Inspector: Ron Bittner
	Odor? <input type="checkbox"/> False	Color Issue? <input type="checkbox"/> False	Deposits? <input type="checkbox"/> False	Floatables? <input type="checkbox"/> False
	WO ID: 071423022	Outfall ID: Veterans Way East	603 Minors Dr.	7/14/2023 8:00:00 AM
	Nearest Intersection: Minors Dr and Fritz Way	Flow Present? <input type="checkbox"/> No	Flow Description: <input type="text"/>	Inspector: Ron Bittner
	Odor? <input type="checkbox"/> False	Color Issue? <input type="checkbox"/> False	Deposits? <input type="checkbox"/> False	Floatables? <input type="checkbox"/> False
	WO ID: 071423023	Outfall ID: N. Rochester St. and Veterans Way	Veterans Way East	7/14/2023 8:00:00 AM
	Nearest Intersection: N. Rochester St. and Veterans Way	Flow Present? <input type="checkbox"/> No	Flow Description: <input type="text"/>	Inspector: Ron Bittner
	Odor? <input type="checkbox"/> False	Color Issue? <input type="checkbox"/> False	Deposits? <input type="checkbox"/> False	Floatables? <input type="checkbox"/> False
	WO ID: 071423024	Outfall ID: McKenzie Dr and Fox St	730 Fox St.	7/14/2023 8:00:00 AM
	Nearest Intersection: McKenzie Dr and Fox St	Flow Present? <input type="checkbox"/> No	Flow Description: <input type="text"/>	Inspector: Ron Bittner
	Odor? <input type="checkbox"/> False	Color Issue? <input type="checkbox"/> False	Deposits? <input type="checkbox"/> False	Floatables? <input type="checkbox"/> False
	WO ID: 071423025	Outfall ID: Henry St. and Jefferson St.	211 Henry St.	7/14/2023 8:00:00 AM
	Nearest Intersection: Henry St. and Jefferson St.	Flow Present? <input type="checkbox"/> No	Flow Description: <input type="text"/>	Inspector: Ron Bittner
	Odor? <input type="checkbox"/> False	Color Issue? <input type="checkbox"/> False	Deposits? <input type="checkbox"/> False	Floatables? <input type="checkbox"/> False
	WO ID: 071423027	Outfall ID: 440 River Crest Court	440 River Crest Court	7/14/2023 8:00:00 AM

**Illicit Discharge** **Flow Present?** **No**

Nearest Intersection: Main St. and River Crest Ct. Flow Present?  No Flow Description:  Inspector:  Ron Bittner Temp:  Time:

Odor?  False Color Issue?  False Deposits?  False Floatables?  False Sample Collected?  Sample taken from:

WO ID: 071423031 Outfall ID:  Location: Dewey Dr East Termini Date: 7/14/2023 8:00:00 AM

Nearest Intersection: S Rochester St and Wolf Run E. Flow Present?  No Flow Description:  Inspector:  Ron Bittner Temp:  Time:

Odor?  False Color Issue?  False Deposits?  False Floatables?  False Sample Collected?  No Sample taken from:

WO ID: 071423033 Outfall ID:  Location: Wolf Run East Walmart Date: 7/14/2023 8:00:00 AM

Nearest Intersection: Wolf Run East and Maple Ave. Flow Present?  No Flow Description:  Inspector:  Ron Bittner Temp:  Time:

Odor?  False Color Issue?  False Deposits?  False Floatables?  False Sample Collected?  Sample taken from:

WO ID: 071423034 Outfall ID:  Location: 1007 Fox St. Date: 7/14/2023 8:00:00 AM

Nearest Intersection: Fox St and Holz Pkwy Flow Present?  No Flow Description:  Inspector:  Ron Bittner Temp:  Time:

Odor?  False Color Issue?  False Deposits?  False Floatables?  False Sample Collected?  No Sample taken from:

WO ID: 071423035 Outfall ID:  Location: Wolf Run East W/HD Date: 7/14/2023 8:00:00 AM

Nearest Intersection: Wolf Run East E Termini Flow Present?  No Flow Description:  Inspector:  Ron Bittner Temp:  Time:

Odor?  False Color Issue?  False Deposits?  False Floatables?  False Sample Collected?  Sample taken from:

WO ID: 071423036 Outfall ID:  Location: Lynch Automotive Group Date: 7/14/2023 8:00:00 AM

Nearest Intersection: Wolf Run East E Termini Flow Present?  No Flow Description:  Inspector:  Ron Bittner Temp:  Time:

Odor?  False Color Issue?  False Deposits?  False Floatables?  False Sample Collected?  Sample taken from:

WO ID: 071423037 Outfall ID:  Location: Boxhorn North Date: 7/14/2023 8:00:00 AM

Nearest Intersection: S Rochester St and Dewey Dr Flow Present?  No Flow Description:  Inspector:  Ron Bittner Temp:  Time:

Odor?  False Color Issue?  False Deposits?  False Floatables?  False Sample Collected?  Sample taken from:

WO ID: 071423038 Outfall ID:  Location: Super Products Date: 7/14/2023 8:00:00 AM

Nearest Intersection: Dewey Dr. and Hill Ct Flow Present?  No Flow Description:  Inspector:  Ron Bittner Temp:  Time:

Odor?  False Color Issue?  False Deposits?  False Floatables?  False Sample Collected?  Sample taken from:

WO ID: 071423039 Outfall ID:  Location: Banker Wire Date: 7/14/2023 8:00:00 AM



**Illicit Discharge**

**Flow Present? No**

Nearest Intersection: Dewey Dr and Hill Ct Flow Present?  No Flow Description:  Inspector:  Ron Bittner Temp:  51 Time:  12:23 PM

Odor?  False Color Issue?  False Deposits?  False Floatables?  False Sample Collected?  No Sample taken from:

WO ID: 071423040 Outfall ID:  Location: Touch Pad Date: 7/14/2023 8:00:00 AM

Nearest Intersection: S Rochester St and Boxhorn Dr. Flow Present?  No Flow Description:  Inspector:  Ron Bittner Temp:  51 Time:  12:26 PM

Odor?  False Color Issue?  False Deposits?  False Floatables?  False Sample Collected?  No Sample taken from:

WO ID: 101323001 Outfall ID:  Location: 705 Minors Dr. Date: 10/13/2023 8:00:00 AM

Nearest Intersection: Minors Dr West Termini Flow Present?  No Flow Description:  Inspector:  Ron Bittner Temp:  56 Time:  02:13 PM

Odor?  True Color Issue?  False Deposits?  False Floatables?  False Sample Collected?  No Sample taken from:

WO ID: 101323002 Outfall ID: 516 Location: Maple Ave WMH Date: 10/13/2023 8:00:00 AM  
ST361001 - Outfall - Minor - 2438

Nearest Intersection: Maple Ave and Wolf Run E Flow Present?  No Flow Description:  Inspector:  Ron Bittner Temp:  56 Time:  01:39 PM

Odor?  False Color Issue?  False Deposits?  False Floatables?  False Sample Collected?  No Sample taken from:

Work Order ID Description BMP Name Location Date

WO ID: 071423026 Outfall ID:  Location: STH 83 CNN Trestle Date: 7/14/2023 8:00:00 AM

Nearest Intersection: S Rochester and Front St. Flow Present?  Yes Flow Description:  Trickle Inspector:  Ron Bittner Temp:  46 Time:  08:24 AM

Odor?  False Color Issue?  True Deposits?  False Floatables?  False Sample Collected?  Yes Sample taken from:  Pool

WO ID: 071423028 Outfall ID:  Location: 106 McKenzie Rd. Date: 7/14/2023 8:00:00 AM

Nearest Intersection: McKenzie Rd and Plank Rd Flow Present?  Yes Flow Description:  Trickle Inspector:  Ron Bittner Temp:  49 Time:  10:53 AM

Odor?  False Color Issue?  False Deposits?  False Floatables?  False Sample Collected?  Yes Sample taken from:  Flow

WO ID: 071423029 Outfall ID:  Location: Milwaukee Tool Date: 7/14/2023 8:00:00 AM

Nearest Intersection: Holz Pkwy and Swan Dr Flow Present?  Yes Flow Description:  Trickle Inspector:  Ron Bittner Temp:  51 Time:  11:33 AM

Odor?  False Color Issue?  False Deposits?  False Floatables?  False Sample Collected?  Yes Sample taken from:  Flow

WO ID: 071423030 Outfall ID:  Location: 909 Perkins Date: 7/14/2023 8:00:00 AM

Nearest Intersection: Holz Pkwy and Perkins Dr. Flow Present?  Yes Flow Description:  Trickle Inspector:  Ron Bittner Temp:  51 Time:  11:19 AM

Odor?  False Color Issue?  False Deposits?  False Floatables?  False Sample Collected?  Yes Sample taken from:  Flow

**Illicit Discharge**      **Flow Present?**  **Yes**

WO ID: 071423032      Outfall ID:      Location: Dewey Dr. West Termini      Date: 7/14/2023 8:00:00 AM

Nearest Intersection: S. Rochester St. and Dewey Dr.      Flow Present?  Yes      Flow Description: Moderate      Inspector: Ron Bittner      Temp: 46      Time: 08:58 AM

Odor?  False      Color Issue?  False      Deposits?  False      Sample Collected?  Yes      Sample taken from: Flow



# NFIRS-1 Basic

**A**

67190	WI	02	09	2023	Mukwonago Fire Station 1 (1)	23-00197	0
FDID	State	Month	Day	Year	Station	Number	Exposure

**B Location Type**

Census tract: \_\_\_\_\_

Street Address  
 Intersection  
 In Front Of  
 Rear Of  
 Adjacent To  
 Directions  
 US National Grid

122		ARROWHEAD	DR-Drive	
Number	Prefix	Street or Highway	Street Type	Suffix

	Village of Mukwonago	WI	53149
Apt./Suite/Room	City	State	Zip Code

Cross Street: \_\_\_\_\_

**C Incident Type**

411-Gasoline or other flammable liquid spill

---

**D Aid Given Or Received**

_____	_____
Their FDID	Their State
_____	
Their Incident Number	

1 Mutual Aid Received  
 2 Auto. Aid Received  
 3 Mutual Aid Given  
 4 Auto. Aid Given  
 5 Other Aid Given  
 None

**E1 Dates and Times**

Alarm: 02 | 09 | 2023 | 15:38

Arrival: 02 | 09 | 2023 | 15:43

Controlled: | | | |

Last Unit Cleared: 02 | 09 | 2023 | 16:23

**E2 Shifts and Alarms**

Company 4 Daytime	0	MUF01
-------------------	---	-------

Shift or Platoon: \_\_\_\_\_ Alarms: \_\_\_\_\_ District: \_\_\_\_\_

---

**E3 Special Studies**

_____	_____
ID#	Value

<b>F Actions Taken</b>  <input type="checkbox"/> 43-Hazardous materials spill control and confinement  Primary Action Taken <input type="checkbox"/> 86-Investigate  Additional Action Taken <input type="checkbox"/> 81-Incident command  Additional Action Taken	<b>G1 Resources</b> <input checked="" type="checkbox"/> Apparatus or Personnel Module is used.  <table border="1"> <tr> <td></td> <td>Apparatus</td> <td>Personnel</td> </tr> <tr> <td>Suppression</td> <td><input type="text" value="2"/></td> <td><input type="text" value="3"/></td> </tr> <tr> <td>EMS</td> <td><input type="text" value="1"/></td> <td><input type="text" value="1"/></td> </tr> <tr> <td>Other</td> <td><input type="text" value="0"/></td> <td><input type="text" value="0"/></td> </tr> </table> <input type="checkbox"/> Resource counts include aid received resources.		Apparatus	Personnel	Suppression	<input type="text" value="2"/>	<input type="text" value="3"/>	EMS	<input type="text" value="1"/>	<input type="text" value="1"/>	Other	<input type="text" value="0"/>	<input type="text" value="0"/>	<b>G2 Estimated Dollar Losses and Values</b> <b>Losses:</b> Required for all fires if known. Optional for all non-fires. None Property: \$ <input type="text"/> <input checked="" type="checkbox"/> Contents: \$ <input type="text"/> <input checked="" type="checkbox"/> <b>Pre-Incident Values:</b> Optional None Property: \$ <input type="text"/> <input checked="" type="checkbox"/> Contents: \$ <input type="text"/> <input checked="" type="checkbox"/>
	Apparatus	Personnel												
Suppression	<input type="text" value="2"/>	<input type="text" value="3"/>												
EMS	<input type="text" value="1"/>	<input type="text" value="1"/>												
Other	<input type="text" value="0"/>	<input type="text" value="0"/>												

<b>Completed Modules</b> <input type="checkbox"/> 2 - Fire <input type="checkbox"/> 3 - Structure Fire <input type="checkbox"/> 4 - Civilian Fire Cas. <input type="checkbox"/> 5 - Fire Service Cas. <input type="checkbox"/> 6 - EMS <input type="checkbox"/> 7 - HazMat <input type="checkbox"/> 8 - Wildland Fire <input type="checkbox"/> 9 - Apparatus <input type="checkbox"/> 10 - Personnel <input type="checkbox"/> 11 - Arson	<b>H1 Casualties</b> <input checked="" type="checkbox"/> None <table border="1"> <tr> <td></td> <td>Deaths</td> <td>Injuries</td> </tr> <tr> <td>Fire Service</td> <td><input type="text" value="0"/></td> <td><input type="text" value="0"/></td> </tr> <tr> <td>Civilian</td> <td><input type="text" value="0"/></td> <td><input type="text" value="0"/></td> </tr> </table> <b>H2 Detector</b> Required for Confined Fires <input type="checkbox"/> 1 - Detector Alerted Occupants <input type="checkbox"/> 2 - Detector Did Not Alert Them <input checked="" type="checkbox"/> 3 - Unknown		Deaths	Injuries	Fire Service	<input type="text" value="0"/>	<input type="text" value="0"/>	Civilian	<input type="text" value="0"/>	<input type="text" value="0"/>	<b>H3 Hazardous Materials Release</b> <input type="checkbox"/> 1 - Natural Gas <input type="checkbox"/> 2 - Propane Gas <input type="checkbox"/> 3 - Gasoline <input type="checkbox"/> 4 - Kerosene <input type="checkbox"/> 5 - Diesel Fuel / Fuel Oil <input type="checkbox"/> 6 - Household Solvents <input type="checkbox"/> 7 - Motor Oil <input type="checkbox"/> 8 - Paint <input checked="" type="checkbox"/> 0 - Other <input type="checkbox"/> None	<b>I Mixed Use Property</b> <input checked="" type="checkbox"/> Not Mixed <input type="checkbox"/> 10 - Assembly Use <input type="checkbox"/> 20 - Education Use <input type="checkbox"/> 33 - Medical Use <input type="checkbox"/> 40 - Residential Use <input type="checkbox"/> 51 - Row Of Stores <input type="checkbox"/> 53 - Enclosed Mall <input type="checkbox"/> 58 - Business and Residential <input type="checkbox"/> 59 - Office Use <input type="checkbox"/> 60 - Industrial Use <input type="checkbox"/> 63 - Military Use <input type="checkbox"/> 65 - Farm Use <input type="checkbox"/> 00 - Other Mixed Use
	Deaths	Injuries										
Fire Service	<input type="text" value="0"/>	<input type="text" value="0"/>										
Civilian	<input type="text" value="0"/>	<input type="text" value="0"/>										

<b>J Property Use</b> <input type="checkbox"/> None <b>Structures</b> <input type="checkbox"/> 131 Church, Place of Worship <input type="checkbox"/> 161 Restaurant or Cafeteria <input type="checkbox"/> 162 Bar/Tavern or Nightclub <input type="checkbox"/> 213 Elementary School, Kindergarten <input type="checkbox"/> 215 High School, Junior High <input type="checkbox"/> 241 College, Adult Education <input type="checkbox"/> 311 Nursing Home <input type="checkbox"/> 331 Hospital	<input type="checkbox"/> 341 Clinic, Clinic-Type Infirmary <input type="checkbox"/> 342 Doctor/Dentist Office <input type="checkbox"/> 361 Prison or Jail, Not Juvenile <input type="checkbox"/> 419 1- or 2-Family Dwelling <input type="checkbox"/> 429 MultiFamily Dwelling <input type="checkbox"/> 439 Rooming/Boarding House <input type="checkbox"/> 449 Commerical Hotel or Motel <input type="checkbox"/> 459 Residential, Board and Care <input type="checkbox"/> 464 Dormitory/Barracks <input type="checkbox"/> 519 Food and Beverage Sales	<input type="checkbox"/> 539 Household Goods, Sales, Repairs <input checked="" type="checkbox"/> 571 Gas or Service Station <input type="checkbox"/> 579 Motor Vehicle/Boat Sales/Repairs <input type="checkbox"/> 599 Business Office <input type="checkbox"/> 615 Electric-Generating Plant <input type="checkbox"/> 629 Laboratory/Science Laboratory <input type="checkbox"/> 700 Manufacturing Plant <input type="checkbox"/> 819 Livestock/Poultry Storage (Barn) <input type="checkbox"/> 882 Non-Residential Parking Garage <input type="checkbox"/> 891 Warehouse
---	--	---

<b>Outside</b> <input type="checkbox"/> 124 Playground or Park <input type="checkbox"/> 655 Crops or Orchard <input type="checkbox"/> 669 Forest (Timberland) <input type="checkbox"/> 807 Outdoor Storage Area <input type="checkbox"/> 919 Dump or Sanitary Landfill <input type="checkbox"/> 931 Open Land or Field <input type="checkbox"/> 936 Vacant Lot	<input type="checkbox"/> 938 Graded/Cared for Plot of Land <input type="checkbox"/> 946 Lake, River, Stream <input type="checkbox"/> 951 Railroad Right-of-Way <input type="checkbox"/> 960 Other Street <input type="checkbox"/> 961 Highway/Divided Highway <input type="checkbox"/> 962 Residential Street/Driveway <input type="checkbox"/> 981 Construction Site <input type="checkbox"/> 984 Industrial Plant Yard	<b>Property Use:</b> <input type="text"/> Description Look up and enter a Property Use code and description only if you have NOT checked a Property Use box.
---	---	---

--

<b>K2</b>				
<b>Owner</b>				
<input type="text"/>	<input type="text"/>	<input type="text"/>	<input type="text"/>	<input type="text"/>
Local Option	Person/Entity Type	Business Name (if applicable)	Phone Number	
<input type="text"/>	<input type="text"/>	<input type="text"/>	<input type="text"/>	<input type="text"/>
Mr., Ms., Mrs.	First Name	MI	Last Name	Suffix
<input type="text"/>	<input type="text"/>	<input type="text"/>	<input type="text"/>	<input type="text"/>
Number	Prefix	Street or Highway	Street Type	Suffix
<input type="text"/>	<input type="text"/>	<input type="text"/>	<input type="text"/>	<input type="text"/>
Post Office Box	Apt./Suite/Room		City	
<input type="text"/>	<input type="text"/>		<input type="text"/>	
State	Zip Code			
<input type="text"/>	<input type="text"/>			

**L Remarks:**

Called on non-emergency line at the station by the BP Manager Adam Mueller 262-210-9766, stating there was a diesel fuel spill. He stated it was about 40-50 gallons and running down the lot towards the storm drain. He was advised to call 911 and MFD would be enroute. 3410, 3488, 3461 responded. 3401 requested dispatch contact WI DNR due to the size of the spill. 3410 on scene by diesel pump side and large amount of diesel fuel pooled by pump containment areas could see trails of diesel fuel going downhill the parking lot towards Arrowhead drive towards the storm drain at the entrance, assumed command. 3461 and 3488 staged on Arrowhead at the storm drain and applied a hazmat sock, oil dry to divert fuel from going into the storm drain. Village DPW Bittner and Utilities Castle contacted and responded to the site. Bittner applied sand to help divert. Command was in contact with driver of semi and WI DNR. Driver stated he pulled into pump 10 to refuel, had one pump into passenger side and one pump into the drivers side. When he was on the drivers side the handle came out of the passenger side without him knowing it. Manager stated it probably pumped for about 6-7 minutes unattended, estimated approximately 40-55 gallons of fuel on the ground. See pictures, Bittner DPW reports. WI DNR Jane Pfieffer 414-435-8021 was given driver information and contacted the driver to coordinate cleanup. MPD assisted with blocking area off to other traffic. Manager was advised to co...

Full primary narrative can be found in NFIRS 1S - Supplemental

**M Authorization**

02	Stien, Jeffrey	Fire Chief		02/09/2023
Officer In Charge ID	Signature	Position or Rank	Assignment	Date
02	Stien, Jeffrey	Fire Chief		02/09/2023
Member Making Report ID	Signature	Position or Rank	Assignment	Date

# NFIRS-7 HazMat

A	67190	WI	02	09	2023	Mukwonago Fire Station 1 (1)	23-00197	0
	FDID	State	Month	Day	Year	Station	Number	Exposure

B			
<b>HazMat ID</b>			
1202			Diesel fuel
UN #	DOT Hazard Classification	CAS Registration #	Chemical Name

<b>C1</b> <b>Container Type</b> <input type="checkbox"/> <input checked="" type="checkbox"/> None	<b>C2</b> <b>Estimated Container Capacity</b> <input type="checkbox"/>  <b>C3</b> <b>Units: Capacity</b> <table style="width: 100%;"> <tr> <td style="text-align: center;">Volume</td> <td style="text-align: center;">Weight</td> </tr> <tr> <td><input type="checkbox"/> 11 - Ounces</td> <td><input type="checkbox"/> 21 - Ounces</td> </tr> <tr> <td><input type="checkbox"/> 12 - Gallons</td> <td><input type="checkbox"/> 22 - Pounds</td> </tr> <tr> <td><input type="checkbox"/> 13 - Barrels</td> <td><input type="checkbox"/> 23 - Grams</td> </tr> <tr> <td><input type="checkbox"/> 14 - Liters</td> <td><input type="checkbox"/> 24 - Kilograms</td> </tr> <tr> <td><input type="checkbox"/> 15 - Cubic Feet</td> <td></td> </tr> <tr> <td><input type="checkbox"/> 16 - Cubic Meters</td> <td></td> </tr> </table>	Volume	Weight	<input type="checkbox"/> 11 - Ounces	<input type="checkbox"/> 21 - Ounces	<input type="checkbox"/> 12 - Gallons	<input type="checkbox"/> 22 - Pounds	<input type="checkbox"/> 13 - Barrels	<input type="checkbox"/> 23 - Grams	<input type="checkbox"/> 14 - Liters	<input type="checkbox"/> 24 - Kilograms	<input type="checkbox"/> 15 - Cubic Feet		<input type="checkbox"/> 16 - Cubic Meters		<b>D1</b> <b>Estimated Amount Released</b> <input type="text" value="55"/>  <b>D2</b> <b>Units: Released</b> <table style="width: 100%;"> <tr> <td style="text-align: center;">Volume</td> <td style="text-align: center;">Weight</td> </tr> <tr> <td><input type="checkbox"/> 11 - Ounces</td> <td><input type="checkbox"/> 21 - Ounces</td> </tr> <tr> <td><input checked="" type="checkbox"/> 12 - Gallons</td> <td><input type="checkbox"/> 22 - Pounds</td> </tr> <tr> <td><input type="checkbox"/> 13 - Barrels</td> <td><input type="checkbox"/> 23 - Grams</td> </tr> <tr> <td><input type="checkbox"/> 14 - Liters</td> <td><input type="checkbox"/> 24 - Kilograms</td> </tr> <tr> <td><input type="checkbox"/> 15 - Cubic Feet</td> <td></td> </tr> <tr> <td><input type="checkbox"/> 16 - Cubic Meters</td> <td></td> </tr> </table>	Volume	Weight	<input type="checkbox"/> 11 - Ounces	<input type="checkbox"/> 21 - Ounces	<input checked="" type="checkbox"/> 12 - Gallons	<input type="checkbox"/> 22 - Pounds	<input type="checkbox"/> 13 - Barrels	<input type="checkbox"/> 23 - Grams	<input type="checkbox"/> 14 - Liters	<input type="checkbox"/> 24 - Kilograms	<input type="checkbox"/> 15 - Cubic Feet		<input type="checkbox"/> 16 - Cubic Meters		<b>E1</b> <b>Physical State When Released</b> <input type="checkbox"/> 1 - Solid <input checked="" type="checkbox"/> 2 - Liquid <input type="checkbox"/> 3 - Gas <input type="checkbox"/> U - Undetermined  <b>E2</b> <b>Released Into</b> <input type="text" value="3-Ground"/>
Volume	Weight																														
<input type="checkbox"/> 11 - Ounces	<input type="checkbox"/> 21 - Ounces																														
<input type="checkbox"/> 12 - Gallons	<input type="checkbox"/> 22 - Pounds																														
<input type="checkbox"/> 13 - Barrels	<input type="checkbox"/> 23 - Grams																														
<input type="checkbox"/> 14 - Liters	<input type="checkbox"/> 24 - Kilograms																														
<input type="checkbox"/> 15 - Cubic Feet																															
<input type="checkbox"/> 16 - Cubic Meters																															
Volume	Weight																														
<input type="checkbox"/> 11 - Ounces	<input type="checkbox"/> 21 - Ounces																														
<input checked="" type="checkbox"/> 12 - Gallons	<input type="checkbox"/> 22 - Pounds																														
<input type="checkbox"/> 13 - Barrels	<input type="checkbox"/> 23 - Grams																														
<input type="checkbox"/> 14 - Liters	<input type="checkbox"/> 24 - Kilograms																														
<input type="checkbox"/> 15 - Cubic Feet																															
<input type="checkbox"/> 16 - Cubic Meters																															

<b>F1</b> <b>Released From</b> <input type="checkbox"/> Below Grade <input type="checkbox"/> 1 - Inside/On Structure <input checked="" type="checkbox"/> 2 - Outside of Structure	<b>F2</b> <b>Population Density</b> <input type="checkbox"/> 1 - Urban <input checked="" type="checkbox"/> 2 - Suburban <input type="checkbox"/> 3 - Rural	<b>G2</b> <b>Area Evacuated</b> <input type="checkbox"/> 1 - Square Feet <input checked="" type="checkbox"/> 2 - Blocks <input type="checkbox"/> 3 - Square Miles <input type="text" value=""/>	<b>H</b> <b>HazMat Actions Taken</b> <input type="text" value="13-HazMat spill control and confinement"/>
	<b>G1</b> <b>Area Affected</b> <input type="checkbox"/> 1 - Square Feet <input checked="" type="checkbox"/> 2 - Blocks <input type="checkbox"/> 3 - Square Miles <input type="text" value="2"/>	<b>G3</b> <b>Estimated Number of People Evacuated</b> <input type="text" value="0"/>	<b>I</b> <b>If Fire or Explosion Is Involved With a Release, Which Occurred First?</b> <input type="checkbox"/> 1 - Ignition <input type="checkbox"/> 2 - Release <input type="checkbox"/> 3 - Undetermined
		<b>G4</b> <b>Estimated Number of Buildings Evacuated</b> <input type="text" value="0"/>	

<b>J</b> <b>Cause of Release</b> <input type="checkbox"/> 1 - Intentional <input checked="" type="checkbox"/> 2 - Unintentional Release <input type="checkbox"/> 3 - Container/Containment Failure <input type="checkbox"/> 4 - Act of Nature <input type="checkbox"/> 5 - Cause Under Investigation <input type="checkbox"/> U - Cause Undetermined After Investigation	<b>K</b> <b>Factors Contributing To Release</b> <input type="text" value="73-Equipment unattended"/>	<b>L</b> <b>Factors Affecting Mitigation</b> <input type="text" value="47-Ice or snow conditions"/>
---	--	---

<p><b>M</b></p> <p><b>Equipment Involved In Release</b></p> <p><input type="text" value="344-Pump"/></p> <p>Equipment Involved In Release</p> <p><input type="checkbox"/> None</p> <p>Brand <input type="text"/></p> <p>Model <input type="text"/></p> <p>Serial <input type="text"/></p> <p>Year <input type="text"/></p>	<p><b>N</b></p> <p><b>Mobile Property Involved In Release</b></p> <p><input type="text"/></p> <p>Type <input type="text"/></p> <p><input type="text"/></p> <p>Make <input type="text"/></p> <p>Model <input type="text"/></p> <p>Year <input type="text"/></p> <p>License # <input type="text"/></p> <p>State <input type="text"/></p> <p>DOT/ICC # <input type="text"/></p>	<p><b>O</b></p> <p><b>HazMat Disposition</b></p> <p><input type="checkbox"/> 1 - Completed by Fire Service Only</p> <p><input type="checkbox"/> 2 - Completed w/Fire Service Present</p> <p><input type="checkbox"/> 3 - Released to Local Agency</p> <p><input type="checkbox"/> 4 - Released to County Agency</p> <p><input type="checkbox"/> 5 - Released to State Agency</p> <p><input checked="" type="checkbox"/> 6 - Released to Federal Agency</p> <p><input type="checkbox"/> 7 - Released to Private Agency</p> <p><input type="checkbox"/> 8 - Released to Property Owner or Manager</p> <hr/> <p><b>P</b></p> <p><b>HazMat Civilian Casualties</b></p> <p>Deaths <input type="text" value="0"/> Injuries <input type="text" value="0"/></p>
--	--	---

## NFIRS-9 Apparatus or Resources

**A**

67190	WI	02	09	2023	Mukwonago Fire Station 1 (1)	23-00197	0
FDID	State	Month	Day	Year	Station	Number	Exposure

Apparatus/Resource	Dates/Times	Sent	Number of People	Apparatus Use	Actions Taken
ID: <input type="text" value="3410"/> Type: <input type="text" value="92-Chief officer car"/>	Dispatch: <input type="text" value="02/09/2023"/> <input type="text" value="15:38"/> Arrival: <input type="text" value="02/09/2023"/> <input type="text" value="15:43"/> Clear: <input type="text" value="02/09/2023"/> <input type="text" value="16:23"/>	<input type="checkbox"/> Sent <input type="text" value="1"/>		<input checked="" type="checkbox"/> Suppression <input type="checkbox"/> EMS <input type="checkbox"/> Other	<input type="text" value="43-Hazardous materials spill control and confinement"/> <input type="text" value="86-Investigate"/> <input type="text" value="81-Incident command"/>
ID: <input type="text" value="3461"/> Type: <input type="text" value="11-Engine"/>	Dispatch: <input type="text" value="02/09/2023"/> <input type="text" value="15:38"/> Arrival: <input type="text" value="02/09/2023"/> <input type="text" value="15:47"/> Clear: <input type="text" value=""/> <input type="text" value=""/>	<input type="checkbox"/> Sent <input type="text" value="2"/>		<input checked="" type="checkbox"/> Suppression <input type="checkbox"/> EMS <input type="checkbox"/> Other	<input type="text" value="43-Hazardous materials spill control and confinement"/> <input type="text" value="86-Investigate"/>
ID: <input type="text" value="3488"/> Type: <input type="text" value="70-Medical &amp; rescue unit, other"/>	Dispatch: <input type="text" value="02/09/2023"/> <input type="text" value="15:42"/> Arrival: <input type="text" value="02/09/2023"/> <input type="text" value="15:43"/> Clear: <input type="text" value=""/> <input type="text" value=""/>	<input type="checkbox"/> Sent <input type="text" value="1"/>		<input type="checkbox"/> Suppression <input checked="" type="checkbox"/> EMS <input type="checkbox"/> Other	<input type="text" value="43-Hazardous materials spill control and confinement"/> <input type="text" value="86-Investigate"/>



# NFIRS-10 Personnel

A

67190	W	02	09	2023	Mukwonago Fire Station 1 (1)	23-00197	0
FDID	State	Month	Day	Year	Station	Number	Exposure

B Apparatus/Resource		Dates/Times	Sent	Number of People	Apparatus Use	Actions Taken	
ID:	3410	Dispatch:	02/09/2023 15:38	<input checked="" type="checkbox"/> Sent	1	<input checked="" type="checkbox"/> Suppression <input type="checkbox"/> EMS <input type="checkbox"/> Other	43- Hazardous materials spill control and confinement 86- Investigate 81-Incident command
Type:	92-Chief officer car	Arrival:	02/09/2023 15:43				
		Clear:	02/09/2023 16:23				
Personnel ID	Name	Rank	Role	Attend	Actions Taken		
02	Stien, Jeffrey	Fire Chief	5588001-Driver	<input type="checkbox"/>	43- Hazardous materials spill control and confinement 86- Investigate 81-Incident command		
ID:	3461	Dispatch:	02/09/2023 15:38	<input checked="" type="checkbox"/> Sent	2	<input checked="" type="checkbox"/> Suppression <input type="checkbox"/> EMS <input type="checkbox"/> Other	43- Hazardous materials spill control and confinement 86- Investigate
Type:	11-Engine	Arrival:	02/09/2023 15:47				
		Clear:	<input type="checkbox"/> <input type="checkbox"/>				
Personnel ID	Name	Rank	Role	Attend	Actions Taken		
586	Friesema, Dave	Firefighter / Critical Care Paramedic	5588002-Officer / Lead EMS Personnel	<input type="checkbox"/>	43- Hazardous materials spill control and confinement 86- Investigate		
528	Pierce, Amanda	Firefighter / EMT-Basic	5588001-Driver	<input type="checkbox"/>	43- Hazardous materials spill control and confinement 86- Investigate		
ID:	3488	Dispatch:	02/09/2023 15:42	<input checked="" type="checkbox"/> Sent	1	<input type="checkbox"/> Suppression <input checked="" type="checkbox"/> EMS <input type="checkbox"/> Other	43- Hazardous materials spill control and confinement 86- Investigate
Type:	70-Medical & rescue unit, other	Arrival:	02/09/2023 15:43				
		Clear:	<input type="checkbox"/> <input type="checkbox"/>				
Personnel ID	Name	Rank	Role	Attend	Actions Taken		
657	Ludwig, Michael	Firefighter/Critical Care	5588001-Driver	<input type="checkbox"/>	43- Hazardous materials spill control and confinement 86- Investigate		

# NFIRS-1S Supplemental

A

67190	WI	02	09	2023	Mukwonago Fire Station 1 (1)	23-00197	0
FDID	State	Month	Day	Year	Station	Number	Exposure

## Additional Narrative (#1 of 1):

US CELLULAR -088.32117X +42.849801 995 Greenwald Ct SE | DIESEL SPILL | Chief Complaint: Fuel spill  
 Problem: FUEL SPILL | Dispatch Code: 59D04 (Sewer/Drain)  
 Suffix: O (Outside)  
 Response Text: Delta  
 KQ Info: At loc (1st pty).  
 KQ Info: Direction of flow: NO MORE IS COMING OUT BUT FUEL IS STILL COMING // GOING INTO PUMP BAY  
 KQ Info: Fuel spill.  
 KQ Info: Spill spreading.  
 KQ Info: Outside spill.  
 KQ Info: Near sewer/drain.  
 KQ Info: LARGE spill. | Per: 3410 (3410) – WHEN THEY FIRST CALLED US AT THE STATION, THEY ADVISED 50 GALLONS WERE SPILLED / CONFIRM THATS THE CASE | Per: 3410 (3410) – IF THATS THE CASE, NOTIFY DNR | Response Text: Delta  
 KQ Info: Fuel from: PUMP #10  
 KQ Info: At loc (1st pty).  
 KQ Info: Direction of flow: NO MORE IS COMING OUT BUT FUEL IS STILL COMING // GOING INTO PUMP BAY  
 KQ Info: Unk container size.  
 KQ Info: Fuel spill.  
 KQ Info: Spill spreading.  
 KQ Info: Outside spill.  
 KQ Info: Near sewer/drain.  
 KQ Info: LARGE spill.  
 KQ Info: Diesel.  
 KQ Info: No one sick/inj. | Per: 3410 (3410) – I ALREADY CONTACTED VILLAGE DPW AND UTILITIES | Response Text: Delta | \*NO PAGE\* | ABT 40-50 ESTIMATED GALLONS | CALLING MUK | CALLING DNR | MUK AWARE AND SENDING PD | Per: 3410 (3410) – 23 / DIESEL SIDE / CONSIDERABLE AMOUNT SPILLED BY PUMPS, DRAINING TOWARDS THE DRAINS | DNR ADV | CHIEF STEIN CALLED IN REQ DNR CALL HIM DIRECT, TRUCK WAS UNATTENDED AT THE PUMP FOR APPROX 6 MINUTES AND 40-50 GALLOONS SPILED, POOLS WERE SPILLING TOWARDS THE ROADWAY, AND OIL DRY IS BEING USED TO PREVENT FUEL FROM GOING INTO THE STORM DRAINS | 10 MINS - Alarm Timer Extended: 10 | Alarm Timer Extended: 0 | CALLING DNR | CALLING DNR | Alarm Timer Extended: 0 | DNR GIVEN INFO, WILL GIVE THAT TO THEIR SPILL COORDINATOR WHO WILL THEN CALL CHIEF STEIN ON THE PERSONAL/DIRECT NUMBER HE GAVE | 20 MINS - Alarm Timer Extended: 10 | 30 MIN - Alarm Timer Extended: 30 | Per: 3410 (3410) – SPOKE TO DNR AND DNR SPOKE TO INDIVIDUAL / DNR WILL BE SETTING UP CLEAN UP PROCESS | Per: 3410 (3410) -- DRAINED FROM BP PUMPS DOWN THE DRIVEWAY AND INTO PUMP / NO ROAD CLOSURE | Per: 3410 (3410) – NEG INJ AND NEG DAMAGE | Per: 3410 (3410) – EVERYTHING TOT OWNER/ OPERATOR TO WORK WITH DNR // DPW PLACING DOWN MORE SAND TO DYKE AROUND STORM DRAIN

## Apparatus Narrative for 3461:

3461 arrived on scene to find what appeared to be a large amount of diesel fuel running from the area of the fuel pumps towards the road and storage drain. An absorbent boom was noted to have been placed between the spill and the storm sewer. MFD staff then placed an additional 3 bags of oil dry to divert the spill away from the storm sewer.

3461 was then cleared by command and returned to quarters.



# Village of Mukwonago Police

# Incident Report

Incident:  
**Administrative/Informational**

Incident Report Number:  
**23-005813**

Between: Date - Time

And/At: Date-Time

**2/9/23**

**15:39**

Incident Location:  
**122 Arrowhead Dr,A, Mukwonago, WI, 53149**

CFS Code-1:  
**9001**

CFS Code-2:

CFS Code-3:

Offense Code-4:

CFS Code-5:

CFS Code-6:

CFS Code-7:

CFS Code-8:

Name (Last, First, Middle)

DOB:

Race/Sex

Address: (Address, City, State, Zip)

Phone 1

Employer

Phone 2

Employer Address

Work Phone #

Name (Last, First, Middle)

DOB:

Race/Sex

Address: (Address, City, State, Zip)

Phone 1

Employer

Phone 2

Employer Address

Work Phone #

## SUMMARY

On the listed date and time, WCC advised the police department of a fuel spill at BP gas station. The subject fueling their vehicle stated the fuel handle displaced itself from the vehicle causing an approximate 40-50 gallon diesel spill. The fire department requested the DNR for cleanup. No further investigation is required.

Vehicle Information: (Year, Make, Model, Style, Color)

License Number:

State:

Expiration Year:

Vin:

Insurance Company:

Other Vehicle Information:

NCIC#

Reporting Officer(s):

**Pinkowski, Shaun**

Payroll Number :

**spin42**

Report Date:

**02/10/2023**

Time Received:

**15:39:38**

Time Cleared:

**17:10:31**

Unit(s) Assigned:

**1236, 1242**

Pages:

**1 Of 3**

Reviewed by:

**Kreiser, Robert S.**

Payroll Number :

**rkre39**

Copy To

Date:

**02/10/2023**

CFS Code-1: **9001**

Incident Report Number:

**23-005813**

**Village of Mukwonago Police**

**Continuation**

Incident Report Number  
23-005813

Incident Location:  
122 Arrowhead Dr,A, Mukwonago, WI, 53149

Incident Date:  
02/09/2023

**NAMES**

**Contact**

Hitt, Harvey L W/M-65 of 114 Audrea St, Moulton,AL,35650  
DOB: 03/09/1957  
Hair: Brown  
Eyes: Brown

**Caller**

Mueller, Adam James W/M-25 of W360S8585 Hwy 59, Eagle,WI,53119  
DOB: 09/05/1997  
HT: 604 WT: 160 Hair: Blonde or Strawberry  
Eyes: Blue  
  
Phone 1:(262) 210-9766

Reporting Officer(s):  
Pinkowski, Shaun

Payroll Number :  
spin42

Pages:  
2 Of 3

**Village of Mukwonago Police****Continuation**

Incident Report Number

23-005813

Incident Location:

122 Arrowhead Dr,A, Mukwonago, WI, 53149

Incident Date:

02/09/2023

**NARRATIVE**

On 2/09/23 at approximately 3:39pm, the Village of Mukwonago Police Department was contacted by Waukesha County Communications (WCC) to advise Mukwonago Fire Department was enroute to BP gas station for a fuel spill. When I arrived on scene, the fire department was investigating the spill which was at the diesel fuel pumps to the rear of the building. I observed the ground to to have an iridescent shine and green stained snow from the fuel.

I spoke with the manager of BP, Adam J. Mueller. Adam stated he observed the spill and stated the truck driver made the spill by accident. Adam pointed out the truck driver and I made contact with him. The truck driver identified himself by Alabama photo driver's license as Harvey L. Hitt. Harvey stated he went to fuel his semitruck, bearing Alabama registration 1189774, from the passenger side. He advised he bungee corded the fuel handle in position and briefly took his eyes off the pump. Harvey went on to state the fuel handle had displaced it self and spilled approximately 40-50 gallons of diesel fuel. Pictures of the scene are attached to this report.

Chief Stien of the Mukwonago Fire Department advised me that due to the size of the spill, he would request the Department of Natural Resources to do clean up. I went back to speak with Harvey once more to obtain liability insurance information because of the severity of the spill and provided me with Next Level Insurance as his provider. A copy of Harvey's statement form and insurance certificate are attached to this report.

Traffic cones were placed to block access to the spill area in the parking lot. DNR was notified for spill clean up. No further investigation is required.

Reporting Officer(s):

Pinkowski, Shaun

Payroll Number :

spin42

Pages:

3 Of 3



## Village of Mukwonago

---

440 River Crest Court, Mukwonago, Wisconsin 53149  
[www.villageofmukwonago.com](http://www.villageofmukwonago.com) | (262) 363-6447 | Fax: (262)363-7197

Date: July 24, 2023

RE: Illicit discharge of drilling fluid into the villages storm sewer system.

7/24/23

DPW received a call from a concerned citizen at 3:30 PM on July 24, 2023, about a boring company dumping drilling fluid into a catch basin. Staff responded to Bayview Road and Greenwald Court where an employee of U.U.C.INC. was sweeping the drilling fluid in the catch basin. The project was shut down at 3:45 PM. A co-owner of the company was on the scene as a working foreman and engage with staff about the legality and illicit discharge. The Mukwonago police department arrived at approximately 4:10 PM and took the necessary information to issue a citation if a site cleanup was not performed. U.U.C called in a vacuum trailer and cleaned the street and sidewalk area that evening.

7/24/23

A representative from Vision Telecommunications Inc., the initial ROW permit holder contacted DPW about cleaning the downstream storm sewer system. Vision provided additional equipment later in the day and along with U.U.C flushed and vacuumed the residual fluid.

Due to the cooperative and timely response of the two companies a citation was not issued for the violation.

Regards,

Village of Mukwonago

Ron Bittner

Public Works Director/Forester/Weed Commissioner

262-363-6447

### Right-of-Way Permit

**PERMIT #: PROW23-0020**

**ISSUED: 06/12/2023**

**EXPIRES: 06/11/2024**

LOCATION:	OWNER:	CONTRACTOR:
970 GREENWALD CT MUKV2014997012 Zoning:	SILKWORTH LLC 970 GREENWALD CT MUKWONAGO WI 53149  <b>Phone:</b> <b>Fax:</b>	Momentum Design, LLC 9000 W Chester St Milwaukee WI 53214  <b>Phone: (262) 672 5058</b> <b>Fax:</b>

**Work Description:** Bury fiber in new 2" conduit & place handholes

**Stipulations:**

Fee Description	Fee Category	Quantity	Item Total
Boring Utility - Not Under Pavement	Right-of-Way	8,915.00	2,674.50
Boring Utility - Under Pavement	Right-of-Way	328.00	328.00
Pull Box	Right-of-Way	13.00	390.00
Sidewalk Fee	Right-of-Way	20.00	35.00
<b>Fee Total:</b>			<b>\$3,427.50</b>
<b>Amount Paid:</b>			<b>\$3,427.50</b>
<b>Balance Due:</b>			<b>\$0.00</b>

#### REQUIRED INSPECTIONS (NON-CONCLUSIVE LIST):

**THE APPLICANT IS REQUIRED TO ARRANGE FOR INSPECTION APPOINTMENTS. For inspections, a 24 hour minimum notice is required. Call (262) 363-6419 for inspections or information, Monday through Friday, 8:00 AM to 9:30 AM.**



**Building Official**

By accepting this permit I hereby agree to construct the above described project in accordance with the plans and specifications submitted herewith, and in strict compliance with all the provisions of the Zoning Code and ordinances of the Village of Mukwonago. I agree to comply with all applicable code and statutes and ordinances and with the conditions of the permit: understanding the issuance of the permit creates no legal liability, expressed or implied, on the municipality; and certify that all the above and supplied information is accurate. If I am the owner applying for an erosion control or construction permit, I have read the cautionary statement regarding contractor financial responsibility. I expressly grant the Building Inspection Department permission to enter the premises for which this permit is sought at all reasonable hours and inspect the work being done. Any additional code violation found during the inspection will also have to be addressed for correction.



PROJECT: 074672-004  
 989 GREENWALD CT  
 1711A FIG. 23  
 MUKWONAGO, WI

Mchmeto  
 ACCESS TRANSMISSION SERVICES, LLC  
 989 GREENWALD CT  
 MUKWONAGO, WI  
 ILMI PROSPECT HUB - A  
 PLM VISA DISTRIBTION SHEET

DATE	5/10/2023
ENGINEER	MD
DRAWN BY	PB
REVISIONS	
DESCRIPTION	
INITIAL	
HORIZONTAL SCALE	1"=50'
VERTICAL SCALE	1"=50'
MP TO MP	
SHEET	31 OF 33
FILE	1711A FIG. 23.DWG

MUKWONAGO, WI  
 WAUKESHA COUNTY

**FLUSHED AND REMOVED ALL MUD  
 FROM STORM DRAINAGE SYSTEM**

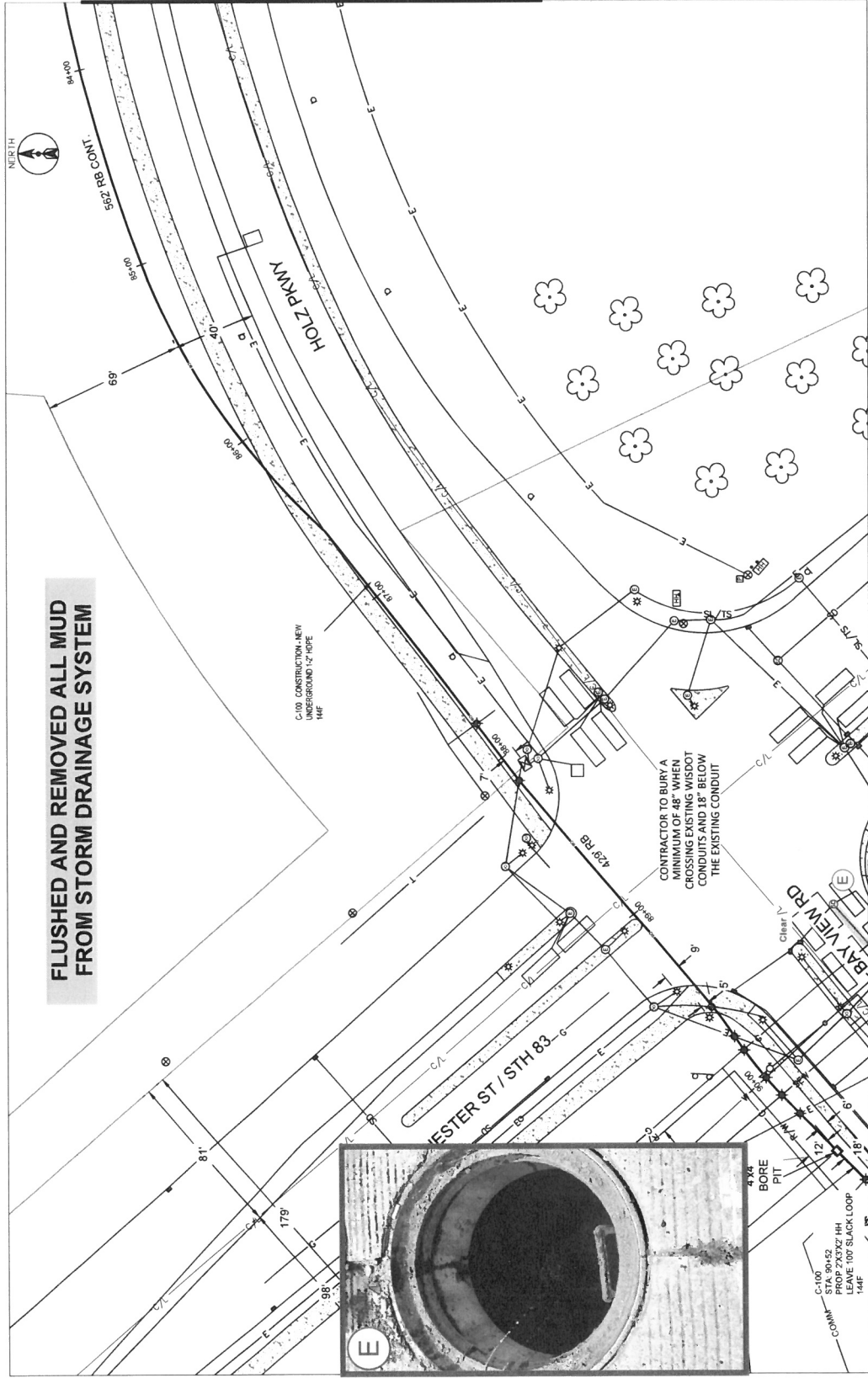

SEE SHEET 30 TO MATCH SURVEY STA. 83+61

SEE SHEET 31 TO MATCH SURVEY STA. 90+71



UNIDENTIFIED FIBER, TELEPHONE, CATV, GAS, ELECTRIC, WATER, SANITARY SEWER, & STORM SEWER FACILITIES IN CONSTRUCTION AREA AND HAVE NOT BEEN FIELD LOCATED. CONTRACTOR TO VERIFY EXACT LOCATION AND DEPTH PRIOR TO ANY DIGGING AND/OR BORING.

\*\*\*\*\* NOTE \*\*\*\*\*  
 ALL UTILITIES MUST BE VERIFIED BY POT-HOLING A MINIMUM OF 48" BELOW EXISTING WISDOT CONDUITS AND 18" BELOW THE REMAINING SOIL WILL BE REMOVED BY VACUUM EXCAVATION ONLY!

CAUTION !!!  
 CONTRACTOR TO LOCATE & VERIFY ALL EXISTING UTILITIES PRIOR TO CONSTRUCTION.

NOTE: UNIDENTIFIED FIBER, TELEPHONE, CATV, GAS, ELECTRIC, WATER, SANITARY SEWER, & STORM SEWER FACILITIES IN CONSTRUCTION AREA AND HAVE NOT BEEN FIELD LOCATED. CONTRACTOR TO VERIFY EXACT LOCATION AND DEPTH PRIOR TO ANY DIGGING AND/OR BORING.

PROJECT: 074672-004  
 1711APIG.23  
 MUKWONAGO, WI

Mcmetro  
 ACCESS TRANSMISSION SERVICES, LLC  
 OUTSIDE PLANT CONSTRUCTION  
 MUKWONAGO, WI  
 PLANT VIEW CONSTRUCTION SHEET

DATE: 5/10/2023  
 ENGINEER: MD  
 DRAWN BY: PB  
 REVISIONS  
 DATE DESCRIPTION INITIAL

SCALE  
 HORIZONTAL: 1"=50'  
 VERTICAL: 1"=50'

MP TO MP  
 SHEET 32 OF 33  
 FILE: 1711APIG.23.DWG

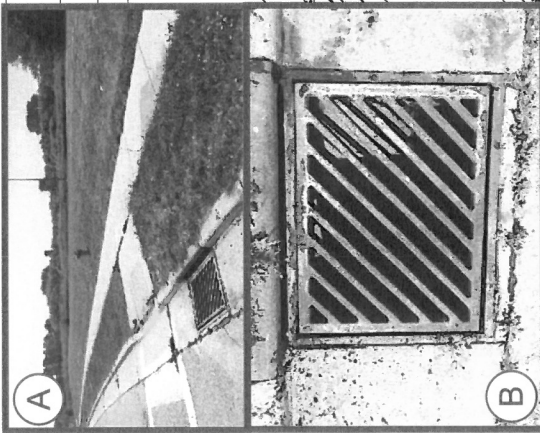
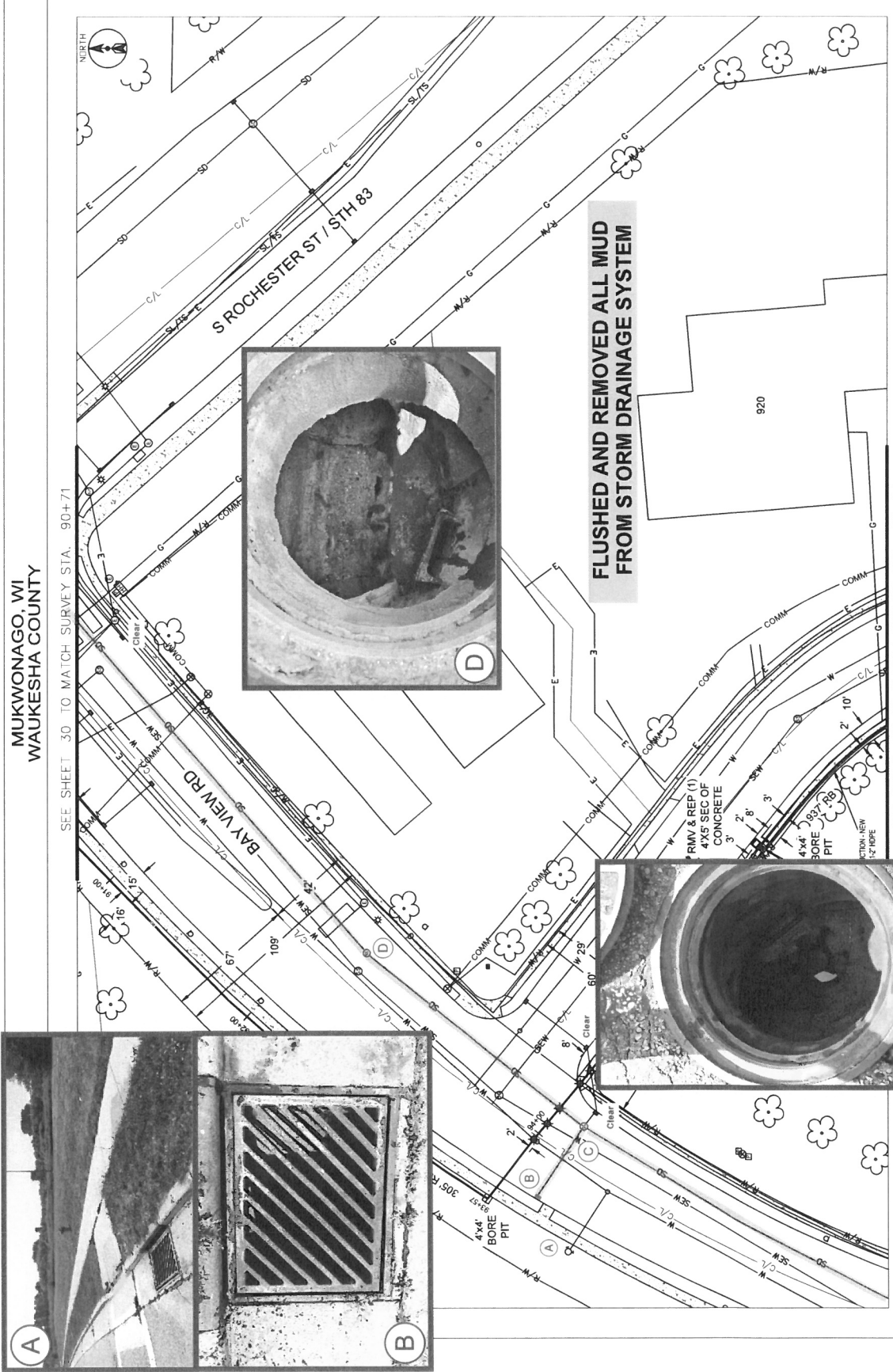

**FLUSHED AND REMOVED ALL MUD  
 FROM STORM DRAINAGE SYSTEM**



**CAUTION!!**  
 EXIST BURIED UTILITIES TELEPHONE, GAS, ELECTRIC, WATER,  
 AND OTHER SERVICES ARE LOCATED IN THIS UTILITY AREA  
 AND HAVE NOT BEEN FIELD LOCATED. CONTRACTOR TO VERIFY EXACT  
 LOCATION AND DEPTH PRIOR TO ANY DIGGING AND/OR BORING.

\*\*\*\* NOTE \*\*\*\*  
 ALL UTILITIES MUST BE VERIFIED BY POT-HOLING  
 A 12" MAXIMUM DIAMETER CORE BORE WILL BE MADE  
 THEN THE REMAINING SOIL WILL BE REMOVED BY VACUUM EXCAVATION ONLY. V

\*\*\*\* NOTE \*\*\*\*  
 UTILITY PLANS ARE PRESENTED ON  
 THESE PLANS ARE BASED ON RECORDS  
 INFORMATION. NOT BASED ON  
 BOUNDARY SURVEY & FIELD EXPOSURES.



Village of Mukwonago Police

Incident Report

Incident: Administrative/Informational

Incident Report Number: 23-031125 Between: Date - Time And/At: Date-Time 7/24/23 15:49

Incident Location: Bay View Rd/Greenwald Ct, Mukwonago, WI, 53149

CFS Code-1: 9001 CFS Code-2: CFS Code-3: Offense Code-4: CFS Code-5: CFS Code-6: CFS Code-7: CFS Code-8:

CM Name (Last, First, Middle) Bittner, Ronald DOB: Race/Sex W/M

Address: (Address, City, State, Zip) 630 CTH NN, Mukwonago, WI, 53149 Phone 1 (262) 363-6447

Employer Phone 2 (414) 550-7507

Employer Address Work Phone #

Name (Last, First, Middle) DOB: Race/Sex

Address: (Address, City, State, Zip) Phone 1

Employer Phone 2

Employer Address Work Phone #

SUMMARY

On the above listed date and time, at the above listed location, the listed complainant reported a business working in the area that was illegally dumping slurry into a storm sewer. The listed contact had arranged for cleanup. This report is for informational purposes, and no further investigation is needed.

Vehicle Information: (Year, Make, Model, Style, Color)

License Number: State: Expiration Year: Vin: Insurance Company:

Other Vehicle Information: NCIC#

Reporting Officer(s): Cieszynski, Brian Payroll Number : bcie45 Report Date: 07/25/2023

Time Received: 15:49:35 Time Cleared: 16:15:33 Unit(s) Assigned: 1245 Pages: 1 Of 3

Reviewed by: Kubiak, Michael L. Payroll Number : mkub41 Copy To

Date: 07/25/2023 CFS Code-1: 9001 Incident Report Number: 23-031125

**Village of Mukwonago Police****Continuation**

Incident Report Number

23-031125

Incident Location:

Bay View Rd/Greenwald Ct, Mukwonago, WI, 53149

Incident Date:

07/24/2023

**NAMES****Business**

Utility Underground Construction of 8231 McGregor Rd, Rockford, IL, 61102  
Phone 1: (815) 670-4652

**Contact**

Camargo Medina, Joel W/M-47 of 8231 E McGregor Rd, Rockford, IL, 61102  
DOB: 07/18/1976  
HT: 510 WT: 220 Hair: Black  
Eyes: Brown

Phone 1: (815) 670-4652

=====

Reporting Officer(s):

Cieszynski, Brian

Payroll Number :

bcie45

Pages:

2 Of 3

**Village of Mukwonago Police****Continuation**

Incident Report Number 23-031125	Incident Location: Bay View Rd/Greenwald Ct, Mukwonago, WI, 53149	Incident Date: 07/24/2023
-------------------------------------	--	------------------------------

**NARRATIVE**

On Monday, July 24, 2023, at approximately 3:49pm, I was dispatched to meet with Public Works Director Ronald Bittner at the intersection of Bay View Road and Greenwald Court. Ronald reported he was in contact with a company working in the area, that was pouring slurry into a storm drain, in violation of Village ordinance. Ronald was requesting an officer respond.

Upon arrival, I met with Ronald and Joel Camargo Medina, who was the supervisor on scene for Utility Underground Construction. I noted a pale, tan colored muddy slurry in the gutter along the north side of Bay View Road at Greenwald Court, pouring into the nearby storm drain. Joel told me he had been contracted to do underground boring in the area, and did not realize so much water would be coming out of the bore holes. The water was flowing in the grass, over the sidewalk, and into the gutter. Ronald was speaking with Joel, and Joel told Ronald he had already contacted a "hydro-vac" apparatus to clear out the storm drain. Ronald gave Joel instructions on what needed to be done for a proper cleanup.

I provided non-emergency contact information for the Police Department to Joel, and told him to call us if any traffic control assistance was needed when the cleaning apparatus arrived.

Ronald wished for this incident to be documented. This report is for informational purposes only, and no further investigation is needed.

I have nothing further.

Reporting Officer(s): Cieszynski, Brian	Payroll Number : bcie45	Pages: 3 Of 3
--	----------------------------	------------------

### Work Order Form

<b>ID</b>	071423029	<b>Logged By</b>	Ron Bittner	07/14/2023 02:21 PM	<b>Status</b>	Closed	<b>Priority</b>	1
<b>Service Request</b>		<b>Type</b>	General		<b>Begin Date / Time</b>	<b>End Date / Time</b>		
		<b>Department</b>	Public Works		07/14/2023 08:00 AM	07/14/2023 09:00 AM		
<b>Activity Description</b>		<b>Group</b>	Pond/BMP		<b>Due Date / Time</b>			
	Illicit Discharge							
<b>Location</b>	Milwaukee Tool							
<b>Assigned To</b>	Ron Bittner			07/14/2023 02:21 PM	<b>Closed By</b>	Ron Bittner		<b>Date Closed</b>
<b>Description</b>								10/13/2023 11:50 AM

**Structure Number**

GSFO004

**Inspection Date**

10/10/2023

**Investigator**

Ron Bittner

**Form Completed By**

Ron Bittner

**Inspection Time**

11:33 AM

**Subwatershed**

Mukwonago

**DATA**

**Temperature**

51

**Rainfall in Last 24 hrs**

0

**Rainfall in Last 48 hrs**

0

**Land Use in Drainage Area**

Industrial

**Nearest Intersection**

Holz Pkwy and Swan Dr

**OUTFALL DESCRIPTION**

**Closed Pipe/Open Drainage**

Closed Pipe  Open Drainage

**Material**

**Shape**

**Submerged**

Yes  No

**Flow Description**

Trickle

**Depth**

FT

**Length**

FT

**Width**

FT

**Flow Present**

Yes  No

**Time of Travel**

SEC

**Time to Fill**

SEC

**Total Flow Volume**

CU FT

**PHYSICAL INDICATORS**

**Odor**

**Color**

**Turbidity**

**Floatables**

**Odor Description**

**Color Description**

**Turbidity Description**

**Floatables Description**

**Physical Indicators Description - Other**

**Outfall Damage**

**Deposits**

**Abnormal Vegetation**

**Poor Pool Quality**

**Outfall Damage Description**

**Deposits Description**

**Abnormal Vegetation Desc.**

**Poor Pool Quality Description**

**Other Description**

**LAB**

**Sample Collected**

 Yes  No

**Collected From**

 Flow  Pool

**Sample Temperature**

**Sample pH**

**Ammonia**

 mg/l

**Copper**

 mg/l

**Chlorine**

 mg/l

**Phenols**

 mg/l

**Surfactants**

 mg/l

**Detergents**

 mg/l

**Total Coliform**

 Positive  Negative

**Lab Notes**

**Assets**

Asset ID	Layer or Facility	GIS Location	Label / Name
----------	-------------------	--------------	--------------





### Work Order Form

<b>ID</b>	071423030	<b>Logged By</b>	Ron Bittner	07/14/2023 02:23 PM	<b>Status</b>	Closed	<b>Priority</b>	1
<b>Service Request</b>		<b>Type</b>	General		<b>Begin Date / Time</b>	07/14/2023 08:00 AM		
		<b>Department</b>	Public Works		<b>End Date / Time</b>	07/14/2023 09:00 AM		
<b>Activity Description</b>		<b>Group</b>	Pond/BMP		<b>Due Date / Time</b>			
	Illicit Discharge							
<b>Location</b>	909 Perkins							
<b>Assigned To</b>	Ron Bittner	07/14/2023 02:23 PM						
<b>Description</b>								
		<b>Closed By</b>	Ron Bittner		<b>Date Closed</b>	10/13/2023 11:49 AM		

**Structure Number**

GSFO002

**Inspection Date**

10/10/2023

**Investigator**

Ron Bittner

**Form Completed By**

Ron Bittner

**Inspection Time**

11:19 AM

**Subwatershed**

Mukwonago

**DATA**

**Temperature**

51

**Rainfall in Last 24 hrs**

0

**Rainfall in Last 48 hrs**

0

**Land Use in Drainage Area**

Industrial and Residential

**Nearest Intersection**

Holz Pkwy and Perkins Dr.

**OUTFALL DESCRIPTION**

**Closed Pipe/Open Drainage**

Closed Pipe  Open Drainage

**Material**

**Shape**

**Submerged**

Yes  No

**Flow Description**

Trickle

**Depth**

FT

**Length**

FT

**Width**

FT

**Flow Present**

Yes  No

**Time of Travel**

SEC

**Time to Fill**

SEC

**Total Flow Volume**

CU FT

**PHYSICAL INDICATORS**

**Odor**

**Color**

**Turbidity**

**Floatables**

**Odor Description**

**Color Description**

**Turbidity Description**

**Floatables Description**

**Physical Indicators Description - Other**

**Outfall Damage**

**Deposits**

**Abnormal Vegetation**

**Poor Pool Quality**

**Outfall Damage Description**

**Deposits Description**

**Abnormal Vegetation Desc.**

**Poor Pool Quality Description**

**Other Description**

**LAB**

**Sample Collected**

 Yes  No

**Collected From**

 Flow  Pool

**Sample Temperature**

**Sample pH**

**Ammonia**

 mg/l

**Copper**

 mg/l

**Chlorine**

 mg/l

**Phenols**

 mg/l

**Surfactants**

 mg/l

**Detergents**

 mg/l

**Total Coliform**

 Positive  Negative

**Lab Notes**

**Assets**

Asset ID	Layer or Facility	GIS Location	Label / Name
----------	-------------------	--------------	--------------



Work Order Form

<b>ID</b> 071423032	<b>Logged By</b> Ron Bittner	07/14/2023 02:26 PM	<b>Status</b> Closed	<b>Priority</b> 1
<b>Service Request</b>	<b>Type</b> General		<b>Begin Date / Time</b>	<b>End Date / Time</b>
	<b>Department</b> Public Works		07/14/2023 08:00 AM	07/14/2023 09:00 AM
<b>Activity Description</b>	<b>Group</b> Pond/BMP		<b>Due Date / Time</b>	
Illicit Discharge				
<b>Location</b> Dewey Dr. West Termini			<b>Closed By</b>	<b>Date Closed</b>
<b>Assigned To</b> Ron Bittner	07/14/2023 02:27 PM		Ron Bittner	02/05/2024 08:32 AM
<b>Description</b>				

Structure Number

ST363008

Inspection Date

10/10/2023

Investigator

Ron Bittner

Form Completed By

Ron Bittner

Inspection Time

08:58 AM

Subwatershed

Mukwonago

DATA

Temperature

46

Rainfall in Last 24 hrs

0

Rainfall in Last 48 hrs

0

Land Use in Drainage Area

industrial

Nearest Intersection

S. Rochester St. and Dewey Dr.

OUTFALL DESCRIPTION

Closed PipeOpen Drainage

Material

Concrete

Shape

Round

Submerged

Yes  No

Flow Description

Moderate

Depth

FT

Length

FT

Width

FT

Flow Present

Yes  No

Time of Travel

SEC

Time to Fill

SEC

Total Flow Volume

CU FT

**PHYSICAL INDICATORS**

**Odor**

**Color**

**Turbidity**

**Floatables**

**Odor Description**

**Color Description**

**Turbidity Description**

**Floatables Description**

**Physical Indicators Description - Other**

**Outfall Damage**

**Deposits**

**Abnormal Vegetation**

**Poor Pool Quality**

**Outfall Damage Description**

**Deposits Description**

**Abnormal Vegetation Desc.**

**Poor Pool Quality Description**

**Other Description**

**LAB**

**Sample Collected**  
 Yes  No

**Collected From**  
 Flow  Pool

**Sample Temperature**

**Sample pH**

**Ammonia**  
 mg/l

**Copper**  
 mg/l

**Chlorine**  
 mg/l

**Phenols**  
 mg/l

**Surfactants**  
 mg/l

**Detergents**  
 mg/l

**Total Coliform**  
 Positive  Negative

**Lab Notes**

SAMPLE WAS COLLECTED FROM AN UPSTREM MANHOLE PAST THE ONLY BUSSINESS IN THE DEVELOPMENT. GROUND WATER ENTERS THE SYSTEM FROM A STREET UNDERDRAIN.

**Assets**

Asset ID	Layer or Facility	GIS Location	Label / Name
----------	-------------------	--------------	--------------





### Work Order Form

<b>ID</b>	071423028	<b>Logged By</b>	Ron Bittner	07/14/2023 02:19 PM	<b>Status</b>	Closed	<b>Priority</b>	1
<b>Service Request</b>		<b>Type</b>	General		<b>Begin Date / Time</b>	<b>End Date / Time</b>		
		<b>Department</b>	Public Works		07/14/2023 08:00 AM	07/14/2023 09:00 AM		
<b>Activity Description</b>		<b>Group</b>	Pond/BMP		<b>Due Date / Time</b>			
Illicit Discharge								
<b>Location</b>	106 McKenzie Rd.							
<b>Assigned To</b>	Ron Bittner	07/14/2023 02:20 PM			<b>Closed By</b>		<b>Date Closed</b>	
<b>Description</b>		Ron Bittner		10/13/2023 11:52 AM				

**Structure Number**

ST252001

**Inspection Date**

10/10/2023

**Investigator**

Ron Bittner

**Form Completed By**

Ron Bittner

**Inspection Time**

10:53 AM

**Subwatershed**

Mukwonago

**DATA**

**Temperature**

49

**Rainfall in Last 24 hrs**

0

**Rainfall in Last 48 hrs**

0

**Land Use in Drainage Area**

Industrial, Residential

**Nearest Intersection**

McKenzie Rd and Plank Rd

**OUTFALL DESCRIPTION**

**Closed Pipe/Open Drainage**

**Material**

Concrete

**Shape**

Round

**Submerged**

Yes  No

**Flow Description**

Trickle

**Depth**

FT

**Length**

FT

**Width**

FT

**Flow Present**

Yes  No

**Time of Travel**

SEC

**Time to Fill**

SEC

**Total Flow Volume**

CU FT



**PHYSICAL INDICATORS**

**Odor**

**Color**

**Turbidity**

**Floatables**

**Odor Description**

**Color Description**

**Turbidity Description**

**Floatables Description**

**Physical Indicators Description - Other**

**Outfall Damage**

**Deposits**

**Abnormal Vegetation**

**Poor Pool Quality**

**Outfall Damage Description**

**Deposits Description**

**Abnormal Vegetation Desc.**

**Poor Pool Quality Description**

**Other Description**

**LAB**

**Sample Collected**  
 Yes  No

**Collected From**  
 Flow  Pool

**Sample Temperature**

**Sample pH**

**Ammonia**  
 mg/l

**Copper**  
 mg/l

**Chlorine**  
 mg/l

**Phenols**  
 mg/l

**Surfactants**  
 mg/l

**Detergents**  
 mg/l

**Total Coliform**  
 Positive  Negative

**Lab Notes**

**Assets**

Asset ID	Layer or Facility	GIS Location	Label / Name
----------	-------------------	--------------	--------------



### Work Order Form

<b>ID</b>	071423026	<b>Logged By</b>	Ron Bittner	07/14/2023 02:16 PM	<b>Status</b>	Closed	<b>Priority</b>	1
<b>Service Request</b>		<b>Type</b>	General		<b>Begin Date / Time</b>	<b>End Date / Time</b>		
		<b>Department</b>	Public Works		07/14/2023 08:00 AM	07/14/2023 09:00 AM		
<b>Activity Description</b>		<b>Group</b>	Pond/BMP		<b>Due Date / Time</b>			
Illicit Discharge								
<b>Location</b>	STH 83 CNN Trestle							
<b>Assigned To</b>	Ron Bittner	07/14/2023 02:16 PM			<b>Closed By</b>	<b>Date Closed</b>		
<b>Description</b>					Ron Bittner	10/13/2023 11:54 AM		

**Structure Number**

ST351002

**Inspection Date**

10/10/2023

**Investigator**

Ron Bittner

**Form Completed By**

Ron Bittner

**Inspection Time**

08:24 AM

**Subwatershed**

Mukwonago

**DATA**

**Temperature**

46

**Rainfall in Last 24 hrs**

0

**Rainfall in Last 48 hrs**

0

**Land Use in Drainage Area**

Commercial, Residential

**Nearest Intersection**

S Rochester and Front St.

**OUTFALL DESCRIPTION**

**Closed Pipe/Open Drainage**

**Material**

Concrete

**Shape**

Round

**Submerged**

Yes  No

**Flow Description**

Trickle

**Depth**

FT

**Length**

FT

**Width**

FT

**Flow Present**

Yes  No

**Time of Travel**

SEC

**Time to Fill**

SEC

**Total Flow Volume**

CU FT

**PHYSICAL INDICATORS**

**Odor**

**Color**

**Turbidity**

**Floatables**

**Odor Description**

**Color Description**

**Turbidity Description**

**Floatables Description**

**Physical Indicators Description - Other**

**Outfall Damage**

**Deposits**

**Abnormal Vegetation**

**Poor Pool Quality**

**Outfall Damage Description**

**Deposits Description**

**Abnormal Vegetation Desc.**

**Poor Pool Quality Description**

**Other Description**

**LAB**

**Sample Collected**  
 Yes  No

**Collected From**  
 Flow  Pool

**Sample Temperature**

**Sample pH**

**Ammonia**  
 mg/l

**Copper**  
 mg/l

**Chlorine**  
 mg/l

**Phenols**  
 mg/l

**Surfactants**  
 mg/l

**Detergents**  
 mg/l

**Total Coliform**  
 Positive  Negative

**Lab Notes**

**Assets**

Asset ID	Layer or Facility	GIS Location	Label / Name
----------	-------------------	--------------	--------------



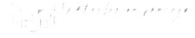
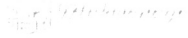

## Pretreatment Report

<u>Begin Date</u>	<u>Staff involved</u>	<u>Staff Involved</u>	<u>Anti-Icing</u>
11/24/2023		DPW-Riechert	500 Gallons
2/23/2024	DPW-Schick	DPW-Broberg	3,000 Gallons
3/21/2024		DPW-Broberg	3,000 Gallons
	Total:		6,500 Gallons

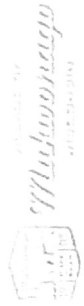

# Snow Event Summary Report

## November 2023 Snow Events

**Snow Event** 11/30/2023 8:00:00 AM ID: 113023004

**Snow Event Type:** salting **Average Temp:** 31 **Windspeed:** 0 **Snowfall:** 1.0 **Start Time:** **End Time:** **Event Duration:** 4.0 Hours

TR5 Brine	0	Gallons	TR5 Salt	0	Pounds
TR7 Brine	0	Gallons	TR7 Salt	0	Pounds
TR8 Brine	0	Gallons	TR8 Salt	0	Pounds
TR9 Brine	10	Gallons	TR9 Salt	2,000	Pounds
TR10 Brine	25	Gallons	TR10 Salt	3,000	Pounds
TR11 Brine	0	Gallons	TR11 Salt	0	Pounds
TR12 Brine	0	Gallons	TR12 Salt	0	Pounds
<b>Total Brine Used:</b>	<b>35</b>	<b>Gallons</b>	<b>Total Salt Used:</b>	<b>5,000</b>	<b>Pounds</b>

**Snow Event** 11/30/2023 8:00:00 AM ID: 113023006

**Snow Event Type:** ice and salt **Average Temp:** 25 **Windspeed:** 0 **Snowfall:** 0 **Start Time:** **End Time:** **Event Duration:** 0 Hours

TR5 Brine	0	Gallons	TR5 Salt	0	Pounds
TR7 Brine	15	Gallons	TR7 Salt	3,000	Pounds
TR8 Brine	0	Gallons	TR8 Salt	0	Pounds
TR9 Brine	0	Gallons	TR9 Salt	0	Pounds
TR10 Brine	0	Gallons	TR10 Salt	0	Pounds
TR11 Brine	0	Gallons	TR11 Salt	0	Pounds
TR12 Brine	0	Gallons	TR12 Salt	0	Pounds
<b>Total Brine Used:</b>	<b>15</b>	<b>Gallons</b>	<b>Total Salt Used:</b>	<b>3,000</b>	<b>Pounds</b>



# Snow Event Summary Report



## December 2023 Snow Events

**Snow Event** 12/11/2023 5:00:00 PM ID: 120423001

**Snow Event Type:** salting and plowing **Average Temp:** 32 **Windspeed:** 5 **Snowfall:** 1.5 **Start Time:** 04:00 PM **End Time:** 06:00 PM **Event Duration:** 2.0 Hours

TR5 Brine	0	Gallons	TR5 Salt	0	Pounds
TR7 Brine	0	Gallons	TR7 Salt	8,000	Pounds
TR8 Brine	70	Gallons	TR8 Salt	8,000	Pounds
TR9 Brine	62	Gallons	TR9 Salt	6,219	Pounds
TR10 Brine	0	Gallons	TR10 Salt	0	Pounds
TR11 Brine	68	Gallons	TR11 Salt	5,447	Pounds
TR12 Brine	19	Gallons	TR12 Salt	3,180	Pounds
<b>Total Brine Used:</b>	<b>219</b>	<b>Gallons</b>	<b>Total Salt Used:</b>	<b>30,846</b>	<b>Pounds</b>

## January 2024 Snow Events

**Snow Event** 1/10/2024 12:00:00 AM ID: 010824001

**Snow Event Type:** salting and plowing **Average Temp:** 0 **Windspeed:** 0 **Snowfall:** 6.0 **Start Time:** **End Time:** **Event Duration:** 6.0 Hours

TR5 Brine	0	Gallons	TR5 Salt	2,000	Pounds
TR7 Brine	180	Gallons	TR7 Salt	18,000	Pounds
TR8 Brine	220	Gallons	TR8 Salt	22,000	Pounds
TR9 Brine	200	Gallons	TR9 Salt	20,324	Pounds
TR10 Brine	85	Gallons	TR10 Salt	10,000	Pounds
TR11 Brine	150	Gallons	TR11 Salt	20,592	Pounds
TR12 Brine	115	Gallons	TR12 Salt	20,251	Pounds
<b>Total Brine Used:</b>	<b>950</b>	<b>Gallons</b>	<b>Total Salt Used:</b>	<b>111,167</b>	<b>Pounds</b>



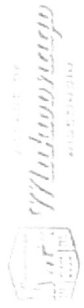

# Snow Event Summary Report

**Snow Event** 1/16/2024 5:30:00 AM ID: 010824002

Snow Event Type: salting Average Temp: 32 Windspeed: 0 Snowfall: 0.5 Start Time: 03:00 AM End Time: 12:30 PM Event Duration: 4.0 Hours

Snow Event Type	Average Temp	Windspeed	Snowfall	Start Time	End Time	Event Duration
TR5 Brine	0 Gallons	TR5 Salt	0 Pounds			
TR7 Brine	70 Gallons	TR7 Salt	12,000 Pounds			
TR8 Brine	65 Gallons	TR8 Salt	9,000 Pounds			
TR9 Brine	51 Gallons	TR9 Salt	5,138 Pounds			
TR10 Brine	27 Gallons	TR10 Salt	4,622 Pounds			
TR11 Brine	150 Gallons	TR11 Salt	8,500 Pounds			
TR12 Brine	33 Gallons	TR12 Salt	5,238 Pounds			
Total Brine Used:	396 Gallons	Total Salt Used:	44,498 Pounds			

**Snow Event** 1/12/2024 5:00:00 AM ID: 011524001

Snow Event Type: Snow Event Average Temp: 30 Windspeed: 0 Snowfall: 14.0 Start Time: 04:00 AM End Time: 09:00 AM Event Duration: 29.0 Hours

Snow Event Type	Average Temp	Windspeed	Snowfall	Start Time	End Time	Event Duration
TR5 Brine	0 Gallons	TR5 Salt	2,500 Pounds			
TR7 Brine	180 Gallons	TR7 Salt	18,000 Pounds			
TR8 Brine	220 Gallons	TR8 Salt	22,000 Pounds			
TR9 Brine	200 Gallons	TR9 Salt	20,324 Pounds			
TR10 Brine	60 Gallons	TR10 Salt	10,000 Pounds			
TR11 Brine	151 Gallons	TR11 Salt	20,592 Pounds			
TR12 Brine	115 Gallons	TR12 Salt	20,251 Pounds			
Total Brine Used:	926 Gallons	Total Salt Used:	111,167 Pounds			



# Snow Event Summary Report



**Snow Event** 1/23/2024 8:00:00 AM ID: 013124151

Snow Event Type: ice - curb to curb Average Temp: 31 Windspeed: 0 Snowfall: 0.0 Start Time: End Time: Event Duration: 0 Hours

TR5 Brine	0	Gallons	TR5 Salt	0	Pounds
TR7 Brine	115	Gallons	TR7 Salt	12,000	Pounds
TR8 Brine	155	Gallons	TR8 Salt	16,500	Pounds
TR9 Brine	108	Gallons	TR9 Salt	12,986	Pounds
TR10 Brine	107	Gallons	TR10 Salt	13,497	Pounds
TR11 Brine	40	Gallons	TR11 Salt	13,639	Pounds
TR12 Brine	63	Gallons	TR12 Salt	11,367	Pounds
Total Brine Used:		588	Total Salt Used:		79,989
		Gallons			Pounds

**Snow Event** 1/22/2024 8:00:00 AM ID: 013124152

Snow Event Type: ice - curb to curb Average Temp: 25 Windspeed: 0 Snowfall: 0.0 Start Time: End Time: Event Duration: 0 Hours

TR5 Brine	0	Gallons	TR5 Salt	0	Pounds
TR7 Brine	50	Gallons	TR7 Salt	5,000	Pounds
TR8 Brine	45	Gallons	TR8 Salt	7,200	Pounds
TR9 Brine	40	Gallons	TR9 Salt	3,993	Pounds
TR10 Brine	35	Gallons	TR10 Salt	4,908	Pounds
TR11 Brine	0	Gallons	TR11 Salt	0	Pounds
TR12 Brine	36	Gallons	TR12 Salt	6,304	Pounds
Total Brine Used:		206	Total Salt Used:		27,405
		Gallons			Pounds



# Snow Event Summary Report

**Snow Event** 1/19/2024 8:00:00 AM ID: 013124153

<b>Snow Event Type:</b> Snow Event	<b>Average Temp:</b> 5	<b>Windspeed:</b> 0	<b>Snowfall:</b> 2.0	<b>Start Time:</b>	<b>End Time:</b>	<b>Event Duration:</b> 0	<b>Hours</b>
------------------------------------	------------------------	---------------------	----------------------	--------------------	------------------	--------------------------	--------------

Snow Event Type	Snow Event	Average Temp	Windspeed	Snowfall	Start Time	End Time	Event Duration	Hours
TR5 Brine	0	Gallons	TR5 Salt	0	Pounds			
TR7 Brine	0	Gallons	TR7 Salt	0	Pounds			
TR8 Brine	65	Gallons	TR8 Salt	9,600	Pounds			
TR9 Brine	42	Gallons	TR9 Salt	4,154	Pounds			
TR10 Brine	0	Gallons	TR10 Salt	0	Pounds			
TR11 Brine	50	Gallons	TR11 Salt	9,381	Pounds			
TR12 Brine	0	Gallons	TR12 Salt	8,928	Pounds			
<b>Total Brine Used:</b>	<b>157</b>	<b>Gallons</b>	<b>Total Salt Used:</b>	<b>32,063</b>	<b>Pounds</b>			

**Snow Event** 1/12/2024 8:00:00 AM ID: 013124154

<b>Snow Event Type:</b> Snow Event	<b>Average Temp:</b> 0	<b>Windspeed:</b> 0	<b>Snowfall:</b> 0	<b>Start Time:</b>	<b>End Time:</b>	<b>Event Duration:</b> 0	<b>Hours</b>
------------------------------------	------------------------	---------------------	--------------------	--------------------	------------------	--------------------------	--------------

Snow Event Type	Snow Event	Average Temp	Windspeed	Snowfall	Start Time	End Time	Event Duration	Hours
TR5 Brine	0	Gallons	TR5 Salt	3,000	Pounds			
TR7 Brine	50	Gallons	TR7 Salt	9,500	Pounds			
TR8 Brine	50	Gallons	TR8 Salt	9,500	Pounds			
TR9 Brine	53	Gallons	TR9 Salt	13,211	Pounds			
TR10 Brine	60	Gallons	TR10 Salt	10,000	Pounds			
TR11 Brine	60	Gallons	TR11 Salt	9,686	Pounds			
TR12 Brine	50	Gallons	TR12 Salt	8,718	Pounds			
<b>Total Brine Used:</b>	<b>323</b>	<b>Gallons</b>	<b>Total Salt Used:</b>	<b>60,615</b>	<b>Pounds</b>			

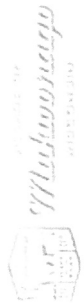

# Snow Event Summary Report

## February 2024 Snow Events

**Snow Event** 2/1/2024 4:00:00 AM ID: 020124001

Snow Event Type: salting Average Temp: 33 Windspeed: 5 Snowfall: 0.0 Start Time: 03:00 AM End Time: 04:00 AM Event Duration: 0.0 Hours

TR5 Brine	0	Gallons	TR5 Salt	0	Pounds
TR7 Brine	0	Gallons	TR7 Salt	0	Pounds
TR8 Brine	0	Gallons	TR8 Salt	0	Pounds
TR9 Brine	0	Gallons	TR9 Salt	0	Pounds
TR10 Brine	0	Gallons	TR10 Salt	0	Pounds
TR11 Brine	0	Gallons	TR11 Salt	0	Pounds
TR12 Brine	0	Gallons	TR12 Salt	8,607	Pounds
Total Brine Used:		0	Total Salt Used:		8,607

**Snow Event** 2/6/2024 8:00:00 AM ID: 020624001

Snow Event Type: salting Average Temp: 31 Windspeed: 0 Snowfall: 0.0 Start Time: End Time: Event Duration: 0.0 Hours

TR5 Brine	0	Gallons	TR5 Salt	0	Pounds
TR7 Brine	0	Gallons	TR7 Salt	0	Pounds
TR8 Brine	0	Gallons	TR8 Salt	0	Pounds
TR9 Brine	0	Gallons	TR9 Salt	0	Pounds
TR10 Brine	0	Gallons	TR10 Salt	0	Pounds
TR11 Brine	0	Gallons	TR11 Salt	0	Pounds
TR12 Brine	0	Gallons	TR12 Salt	58	Pounds
Total Brine Used:		0	Total Salt Used:		58



# Snow Event Summary Report

**Snow Event** 2/15/2024 8:00:00 AM ID: 021524001

Snow Event Type: snow and slush      Average Temp: 34      Windspeed: 15      Snowfall: 2.0      Start Time:      End Time:      Event Duration: 0 Hours

TR5 Brine	0	Gallons	TR5 Salt	2,000	Pounds
TR7 Brine	45	Gallons	TR7 Salt	4,500	Pounds
TR8 Brine	40	Gallons	TR8 Salt	4,400	Pounds
TR9 Brine	42	Gallons	TR9 Salt	4,291	Pounds
TR10 Brine	36	Gallons	TR10 Salt	4,582	Pounds
TR11 Brine	0	Gallons	TR11 Salt	0	Pounds
TR12 Brine	33	Gallons	TR12 Salt	6,446	Pounds
Total Brine Used:		196	Total Salt Used:		24,219
		Gallons			Pounds

**Snow Event** 2/28/2024 8:00:00 AM ID: 022824001

Snow Event Type: salting      Average Temp: 19      Windspeed: 25      Snowfall: 0.0      Start Time:      End Time:      Event Duration: 0 Hours

TR5 Brine	0	Gallons	TR5 Salt	0	Pounds
TR7 Brine	0	Gallons	TR7 Salt	0	Pounds
TR8 Brine	0	Gallons	TR8 Salt	0	Pounds
TR9 Brine	0	Gallons	TR9 Salt	0	Pounds
TR10 Brine	0	Gallons	TR10 Salt	0	Pounds
TR11 Brine	0	Gallons	TR11 Salt	0	Pounds
TR12 Brine	4	Gallons	TR12 Salt	769	Pounds
Total Brine Used:		4	Total Salt Used:		769
		Gallons			Pounds



# Snow Event Summary Report



## March 2024 Snow Events

**Snow Event**      3/22/2024 8:00:00 AM      ID: 032524002

**Snow Event Type:** salting and plowing      **Average Temp:** 31      **Windspeed:** 5      **Snowfall:** 3.0      **Start Time:** 11:59 PM      **End Time:** 08:00 AM      **Event Duration:** 8.0 Hours

TR5 Brine	0	Gallons	TR5 Salt	2,000	Pounds
TR7 Brine	60	Gallons	TR7 Salt	9,000	Pounds
TR8 Brine	70	Gallons	TR8 Salt	10,000	Pounds
TR9 Brine	102	Gallons	TR9 Salt	10,145	Pounds
TR10 Brine	72	Gallons	TR10 Salt	8,276	Pounds
TR11 Brine	164	Gallons	TR11 Salt	11,504	Pounds
TR12 Brine	56	Gallons	TR12 Salt	8,270	Pounds
<b>Total Brine Used:</b>	<b>524</b>	<b>Gallons</b>	<b>Total Salt Used:</b>	<b>57,195</b>	<b>Pounds</b>

**Total Brine Used:**      4,539      Gallons      **Total Salt Used:**      596,598      Pounds

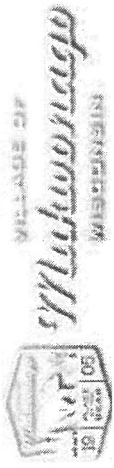

## BMP Inspection Summary Report

Work Order ID	Description	BMP Name	Location	Date
071423012	BMP Inspection - Infiltration Basin		MCL Division St.	10/2/2023 1:56:11 PM
071423014	BMP Inspection - Infiltration Basin		Chapman Farm BLVD	10/3/2023 10:05:51 AM
071423015	BMP Inspection - Infiltration Basin		Chapman Farm BLVD W	10/3/2023 9:20:00 AM

No

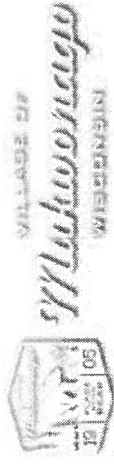

# BMP Inspection Summary Report

<b>Work Order ID</b>	<b>Description</b>	<b>BMP Name</b>	<b>Location</b>	<b>Date</b>
071423011	BMP Inspection - Dry Pond		1111 Fox St.	9/15/2023 2:29:00 PM

No





## BMP Inspection Summary Report

Work Order ID	Description	BMP Name	Location	Date
071423001	BMP Inspection - Wet Pond		Boxhorn Dr. South	10/3/2023 10:25:00 AM
071423002	BMP Inspection - Wet Pond		Box Horn Dr. North	10/3/2023 11:03:00 AM
071423003	BMP Inspection - Wet Pond		Dewey Dr East Termini	10/2/2023 2:11:00 PM
071423004	BMP Inspection - Wet Pond		Wolf Run East	10/3/2023 11:45:00 AM
071423005	BMP Inspection - Wet Pond		Holz Parkway South	10/2/2023 10:34:00 AM
071423006	BMP Inspection - Wet Pond		Holz Parkway N S	9/15/2023 2:45:40 PM
071423007	BMP Inspection - Wet Pond		Holz Parkway NN	7/14/2023 8:00:00 AM
071423008	BMP Inspection - Wet Pond		Miniwaukan East	10/2/2023 11:31:00 AM
071423009	BMP Inspection - Wet Pond		Miniwakan Middle	10/2/2023 11:42:00 AM
071423010	BMP Inspection - Wet Pond		Minwaukan West	10/2/2023 1:32:00 PM
071423013	BMP Inspection - Wet Pond		Veterans Way East P&S	10/3/2023 1:30:00 PM
071423016	BMP Inspection - Wet Pond		Robert Dr. W. Termini	10/3/2023 9:08:00 AM

No

# THE VILLAGE OF MUKWONAGO

## Fourth Quarter 2023 Recycling Report

Single Stream, Tons	Year Total	1st Qtr	2nd Qtr	3rd Qtr	4th Qtr
Mixed Paper	341.9	91.5	81.7	86.3	82.4
Cardboard	157.8	42.2	37.7	39.8	38.0
Glass	179.7	48.1	42.9	45.4	43.3
#1 Plastic	26.3	7.0	6.3	6.6	6.3
#2 Natural HDPE	8.7	2.3	2.1	2.2	2.1
#2 Colored HDPE	8.9	2.4	2.1	2.2	2.1
#3-7 Plastic	7.0	1.9	1.7	1.8	1.7
Rigid Plastic***	3.5	0.9	0.8	0.9	0.8
Tin Cans	21.9	5.9	5.2	5.5	5.3
Al Cans	7.0	1.9	1.7	1.8	1.7
<b>Single Stream Total</b>	<b>763</b>	<b>204</b>	<b>182</b>	<b>193</b>	<b>184</b>
Recycled Bulk, Tons*	Year Total	1st Qtr	2nd Qtr	3rd Qtr	4th Qtr
Antifreeze	0.07	0.00	0.02	0.01	0.04
Appliances	2.27	0.25	1.20	0.54	0.29
Batteries	0.77	0.00	0.12	0.06	0.59
Cardboard	2.58	0.33	0.68	0.66	0.91
Metal	3.47	0.46	1.32	0.78	0.91
Oil	1.80	0.05	0.39	0.45	0.92
Tires	6.86	0.32	1.49	1.73	3.31
<b>Recycled Bulk Total</b>	<b>17.82</b>	<b>1.41</b>	<b>5.21</b>	<b>4.23</b>	<b>6.97</b>
<b>Total Recyclables</b>	<b>780</b>	<b>206</b>	<b>187</b>	<b>197</b>	<b>191</b>
<b>Total Garbage**</b>	<b>2531</b>	<b>535</b>	<b>657</b>	<b>663</b>	<b>676</b>

\*Please note that JOHNS does not recycle polystyrene foam.

\*\*Total garbage weight includes weekly garbage and residual garbage removed from recyclables.

\*\*\*Rigid Plastic is not to be included in grant reporting

Population	8126	<i>Year to date pounds per capita recycled. WI DNR requires 107 pounds per year.</i>	187.7
------------	------	--	-------

Yard Waste	Year Total	1st Qtr	2nd Qtr	3rd Qtr	4th Qtr
	82.2	0.0	31.2	20.1	31.0

Recycling Compliance	Year Total	1st Qtr	2nd Qtr	3rd Qtr	4th Qtr
Warning Tags	5	0	4	1	0
Written Warnings	2	0	0	0	2

Report completed by:  
 Johns Disposal Service, Inc.  
 107 Co Rd U  
 Whitewater, WI 53190  
 (262) 473-4700



Whitewater & Franksville, WI



: JOHNS DISPOSAL SVC. INC.  
 : 7311 OMEGA C\*RCLE  
 : FRANKSVILLE, 53126  
 : 2624734700

# Invoice

Date	Invoice
2023	
	Invoice Total

Billing Address
EMAIL INVOICES VILLAGE OF MUKWONAGO 440 RIVER CREST COURT MUKWONAGO 53149

Service Address:
VILLAGE OF MUKWONAGO VILLAGE OF MUKWONAGO MUKWONAGO WI 53149

DATE	DESCRIPTION	QUANTITY	AMOUNT	TOTAL
06/23'23 06/23123	" SUB ACCT: 01- 2546 VILLAGE OF MUKWONAGO 630 HWY NN WORK ORDER* 1124636 20YD EMPTY & RETURN LANDFILL CHARGES <b>Sub-Account:</b> <b>Total</b> 726.50	1.00 10.93	180.00 50.00	180.00 546.50
			Total Invoice:	

For proper credit please. return this port-oh.

Previous Balance payments & CreditsCurrent Cha



# Invoice

JOHNS DISPOSAL SVC. INC.  
7311 OMEGA CIRCLE

FRANKSVILLE, WI 53126  
2624734700

**DISPOSAL  
SERVICE**  
INC

Date	Invoice #
10/26/2023	
	Invoice Total

Bill To:  
EMAIL INVOICES  
VILLAGE OF  
MUKWONAGO  
440 RIVER CREST COURT  
MUKWONAGO WI 53149

Service Address:  
VILLAGE OF  
MUKWONAGO  
VILLAGE OF  
MUKWONAGO  
MUKWONAGO WI 53149

DATE	DESCRIPTION	QUANTITY	AMOUNT	TOTAL
10/09/23	SUB ACCT: 01- 2546 VILLAGE OF MUKWONAGO			
10/09/23	630 HM NN			
	WORK ORDER#: 1199025			
	20YD EMPTY &			
	RETURN LANDFILL	1.00	180.00	180.00
	CHARGES Sub-	11.35	50.00	567.50
	Account:			
	Total 747.50			
			Total Invoice:	

For proper credit please return this portion.

Previous Balance	Payments & Credits	Current Charges
------------------	--------------------	-----------------



JOHNS DISPOSAL SVC. INC.  
 7311 OMEGA CIRCLE  
 FRANKSVILLE, WI 53126

# Invoice

**DISPOSAL  
 SERVICE**  
 INC

262473-4700

Bill To:  
 EMAIL INVOICES  
 VILLAGE OF  
 MUKWONAGO  
 440 RIVER CREST COURT  
 MUKWONAGO WI 53149

Service Address:  
 VILLAGE OF  
 MUKWONAGO  
 VILLAGE OF  
 MUKWONAGO  
 MUKWONAGO WI 53149

Date	Invoice #
	Invoice Total

DATE	DESCRIPTION	QUANTITY	AMOUNT	TOTAL
11/08/23	SUB ACCT: 01- 2546 VILLAGE OF MUKWONAGO 630 1-1M NN WORK ORDER#: 1218237 20YD EMPTY & RETURN LF QTY INCL 4 TON LIMIT WORK	1.00		180.00
11/08/23	ORDER#: 1224344 20YD EMPTY & RETURN	8.52	180.00	248.60
11/10/23	LANDFILL CHARGES	1.00		180.00
11/14/23	WORK ORDER#: 1230132 20YD EMPTY & RETURN LANDFILL CHARGES WORK	5.90	180.00	295.00
11/20/23	ORDER#: 1231874 20YD RIO REMOVAL LANDFILL CHARGES Sub- Account:	1.00		180.00
11/24/23		10.68	180.00	534.00
11/24/23			50.00	
	Total	2,357.60		

(CONT.)

## JOHNS DISPOSAL SVC. INC

Account No.: 01-1655 9 Service Dates: NOVEMBER 2023 Billing Name: VILLAGE OF  
MUKWONAGO Due Date: 12/28/2023

Invoice #: 1236778

## STORM WATER POLLUTION PREVENTION PLAN (SWPPP) INSPECTION FORM FOR MUNICIPAL FACILITIES

Site:	Village of Mukwonago DPW Yard
Location:	630 Veterans Way E.
Inspector/Title:	Ron Bittner
Date:	4/4/23
Last Inspection (Date):	11/8/22

### Storm Water Pollution Prevention Plan

Has a storm water pollution prevention plan been developed for this site? Yes  No

Title of Plan: Village of Mukwonago SWPPP for Municipal Facilities

Date of Plan: April 2016

Does the SWPP include a site map, list of pollutant sources, pollutant control practices to be inspected, and maintenance procedures? Yes  No

(Indicate any items that are *not* included):

### Vehicle Maintenance, Washing and Fueling

	Activity/Practice	Inspected?	Activity/ Practice Adequate?	Corrective Action Needed & Notes
1	Vehicle maintenance area drains to sanitary sewer system	Yes <input checked="" type="checkbox"/> No <input type="checkbox"/> N/A <input type="checkbox"/>	Yes <input checked="" type="checkbox"/> No <input type="checkbox"/>	
2	Vehicle maintenance area has oil-grease separator in floor drains	Yes <input checked="" type="checkbox"/> No <input type="checkbox"/> N/A <input type="checkbox"/>	Yes <input checked="" type="checkbox"/> No <input type="checkbox"/>	
3	Floor drains are clean	Yes <input checked="" type="checkbox"/> No <input type="checkbox"/> N/A <input type="checkbox"/>	Yes <input checked="" type="checkbox"/> No <input type="checkbox"/>	
4	Vehicle washing completed inside building	Yes <input checked="" type="checkbox"/> No <input type="checkbox"/> N/A <input type="checkbox"/>	Yes <input checked="" type="checkbox"/> No <input type="checkbox"/>	
5	Vehicle washing drains to sanitary system	Yes <input checked="" type="checkbox"/> No <input type="checkbox"/> N/A <input type="checkbox"/>	Yes <input checked="" type="checkbox"/> No <input type="checkbox"/>	
6	Vehicle fueling center has canopy/cover	Yes <input type="checkbox"/> No <input checked="" type="checkbox"/> N/A <input checked="" type="checkbox"/>	Yes <input type="checkbox"/> No <input type="checkbox"/>	
7	Vehicle fueling center has clearly labeled spill kit nearby	Yes <input checked="" type="checkbox"/> No <input type="checkbox"/> N/A <input type="checkbox"/>	Yes <input checked="" type="checkbox"/> No <input type="checkbox"/>	
8	Vehicle fueling center has oil-grease separators in nearby storm drains	Yes <input checked="" type="checkbox"/> No <input type="checkbox"/> N/A <input type="checkbox"/>	Yes <input checked="" type="checkbox"/> No <input type="checkbox"/>	



8	Vehicle fueling center has oil-grease separators in nearby storm drains	Yes <input checked="" type="checkbox"/> No <input type="checkbox"/> N/A <input type="checkbox"/>	Yes <input checked="" type="checkbox"/> No <input type="checkbox"/>	
---	---	--	---	--

### Hazardous Waste Management

	Activity/Practice	Inspected?	Activity/Practice Adequate?	Corrective Action Needed & Notes
1	Hazardous materials and containers are stored indoors	Yes <input checked="" type="checkbox"/> No <input type="checkbox"/> N/A <input type="checkbox"/>	Yes <input checked="" type="checkbox"/> No <input type="checkbox"/>	
2	Containers of hazardous materials are in good condition	Yes <input checked="" type="checkbox"/> No <input type="checkbox"/> N/A <input type="checkbox"/>	Yes <input checked="" type="checkbox"/> No <input type="checkbox"/>	

### Waste Management

	Activity/Practice	Inspected?	Activity/Practice Adequate?	Corrective Action Needed & Notes
1	Dumpsters are covered	Yes <input checked="" type="checkbox"/> No <input type="checkbox"/> N/A <input type="checkbox"/>	Yes <input checked="" type="checkbox"/> No <input type="checkbox"/>	
2	Full dumpsters are hauled out on a regular basis	Yes <input checked="" type="checkbox"/> No <input type="checkbox"/> N/A <input type="checkbox"/>	Yes <input checked="" type="checkbox"/> No <input type="checkbox"/>	
3	Piles of miscellaneous debris are sorted and disposed of on a regular basis	Yes <input checked="" type="checkbox"/> No <input type="checkbox"/> N/A <input type="checkbox"/>	Yes <input checked="" type="checkbox"/> No <input type="checkbox"/>	
4	Street sweepings are covered	Yes <input checked="" type="checkbox"/> No <input type="checkbox"/> N/A <input type="checkbox"/>	Yes <input checked="" type="checkbox"/> No <input type="checkbox"/>	
5	Street sweepings are stored in containers or have barriers or perimeter controls to minimize runoff impacts	Yes <input checked="" type="checkbox"/> No <input type="checkbox"/> N/A <input type="checkbox"/>	Yes <input checked="" type="checkbox"/> No <input type="checkbox"/>	

### Material Storage

	Activity/Practice	Inspected?	Activity/Practice Adequate?	Corrective Action Needed & Notes
1	Runoff from bulk storage is contained on low side by barriers, bays or other perimeter controls	Yes <input checked="" type="checkbox"/> No <input type="checkbox"/> N/A <input type="checkbox"/>	Yes <input checked="" type="checkbox"/> No <input type="checkbox"/>	
2	Bulk storage piles are stabilized/vegetated	Yes <input checked="" type="checkbox"/> No <input type="checkbox"/> N/A <input type="checkbox"/>	Yes <input checked="" type="checkbox"/> No <input type="checkbox"/>	
3	Materials stored under cover/inside buildings	Yes <input checked="" type="checkbox"/> No <input type="checkbox"/> N/A <input type="checkbox"/>	Yes <input checked="" type="checkbox"/> No <input type="checkbox"/>	

4	Area near salt shed is clear of excess/spilled/tracked salt	Yes <input checked="" type="checkbox"/> No <input type="checkbox"/> N/A <input type="checkbox"/>	Yes <input checked="" type="checkbox"/> No <input type="checkbox"/>	
5	Excess/spilled/tracked salt is swept up and added to bulk salt pile	Yes <input checked="" type="checkbox"/> No <input type="checkbox"/> N/A <input type="checkbox"/>	Yes <input checked="" type="checkbox"/> No <input type="checkbox"/>	
6	Underground runoff containment is emptied on a regular basis	Yes <input checked="" type="checkbox"/> No <input type="checkbox"/> N/A <input type="checkbox"/>	Yes <input checked="" type="checkbox"/> No <input type="checkbox"/>	

### Runoff Controls

	Activity/Practice	Inspected?	Activity/ Practice Adequate?	Corrective Action Needed & Notes
1	Grass filter strips have at least 70% uniform vegetation growth	Yes <input type="checkbox"/> No <input type="checkbox"/> N/A <input checked="" type="checkbox"/>	Yes <input type="checkbox"/> No <input type="checkbox"/>	
2	Grass filter strips typically have 6 inches or more of vegetation	Yes <input type="checkbox"/> No <input type="checkbox"/> N/A <input checked="" type="checkbox"/>	Yes <input type="checkbox"/> No <input type="checkbox"/>	
3	Storm water pond inlets/outlets are stable	Yes <input type="checkbox"/> No <input type="checkbox"/> N/A <input checked="" type="checkbox"/>	Yes <input type="checkbox"/> No <input type="checkbox"/>	
4	Storm water berms are vegetated	Yes <input type="checkbox"/> No <input type="checkbox"/> N/A <input checked="" type="checkbox"/>	Yes <input type="checkbox"/> No <input type="checkbox"/>	
5	Storm water pond berms are stable (no erosion, tree roots or animal boroughs)	Yes <input type="checkbox"/> No <input type="checkbox"/> N/A <input checked="" type="checkbox"/>	Yes <input type="checkbox"/> No <input type="checkbox"/>	
6	Infiltration basins/rain gardens have at least 70% plant growth	Yes <input type="checkbox"/> No <input type="checkbox"/> N/A <input checked="" type="checkbox"/>	Yes <input type="checkbox"/> No <input type="checkbox"/>	
7	Infiltration basins/rain gardens are maintained regularly, and in the spring and fall	Yes <input type="checkbox"/> No <input type="checkbox"/> N/A <input checked="" type="checkbox"/>	Yes <input type="checkbox"/> No <input type="checkbox"/>	
8	Infiltration basins/rain gardens drain down within 24 hours ( <i>based on post-rain event observations</i> )	Yes <input type="checkbox"/> No <input type="checkbox"/> N/A <input checked="" type="checkbox"/>	Yes <input type="checkbox"/> No <input type="checkbox"/>	

### Spills Program

	Activity/Practice	Inspected?	Activity/ Practice Adequate?	Corrective Action Needed & Notes
1	Written program is available for employees	Yes <input checked="" type="checkbox"/> No <input type="checkbox"/> N/A <input type="checkbox"/>	Yes <input checked="" type="checkbox"/> No <input type="checkbox"/>	
2	Employees know where written program is located	Yes <input checked="" type="checkbox"/> No <input type="checkbox"/> N/A <input type="checkbox"/>	Yes <input checked="" type="checkbox"/> No <input type="checkbox"/>	
3	Written program is evaluated annually	Yes <input checked="" type="checkbox"/> No <input type="checkbox"/> N/A <input type="checkbox"/>	Yes <input checked="" type="checkbox"/> No <input type="checkbox"/>	

### Employee Training

	Activity/Practice	Inspected?	Activity/ Practice Adequate?	Corrective Action Needed & Notes
1	New employees are trained on SWPPP	Yes <input checked="" type="checkbox"/> No <input type="checkbox"/> N/A <input type="checkbox"/>	Yes <input checked="" type="checkbox"/> No <input type="checkbox"/>	
2	Annual or more frequent training provided to employees on SWPPP	Yes <input checked="" type="checkbox"/> No <input type="checkbox"/> N/A <input type="checkbox"/>	Yes <input checked="" type="checkbox"/> No <input type="checkbox"/>	

This inspection was used as annual training for seven staff members.

	Recommendations/Correction	Completed On (Date)	Initials
1			
2			
3			
4			
5			
6			
7			
8			
9			
10			

## STORM WATER POLLUTION PREVENTION PLAN (SWPPP) INSPECTION FORM FOR MUNICIPAL FACILITIES

Site:	Village of Mukwonago DPW Yard
Location:	630 Veterans Way E.
Inspector/Title:	Mike Wilharms & Dwane Broberg
Date:	7/18/23
Last Inspection (Date):	4/4/23

### Storm Water Pollution Prevention Plan

Has a storm water pollution prevention plan been developed for this site? Yes  No

Title of Plan: Village of Mukwonago SWPPP for Municipal Facilities

Date of Plan: April 2016

Does the SWPP include a site map, list of pollutant sources, pollutant control practices to be inspected, and maintenance procedures? Yes  No

(Indicate any items that are *not* included):

### Vehicle Maintenance, Washing and Fueling

	Activity/Practice	Inspected?	Activity/ Practice Adequate?	Corrective Action Needed & Notes
1	Vehicle maintenance area drains to sanitary sewer system	Yes <input checked="" type="checkbox"/> No <input type="checkbox"/> N/A <input type="checkbox"/>	Yes <input checked="" type="checkbox"/> No <input type="checkbox"/>	
2	Vehicle maintenance area has oil-grease separator in floor drains	Yes <input checked="" type="checkbox"/> No <input type="checkbox"/> N/A <input type="checkbox"/>	Yes <input checked="" type="checkbox"/> No <input type="checkbox"/>	
3	Floor drains are clean	Yes <input checked="" type="checkbox"/> No <input type="checkbox"/> N/A <input type="checkbox"/>	Yes <input checked="" type="checkbox"/> No <input type="checkbox"/>	
4	Vehicle washing completed inside building	Yes <input checked="" type="checkbox"/> No <input type="checkbox"/> N/A <input type="checkbox"/>	Yes <input checked="" type="checkbox"/> No <input type="checkbox"/>	
5	Vehicle washing drains to sanitary system	Yes <input checked="" type="checkbox"/> No <input type="checkbox"/> N/A <input type="checkbox"/>	Yes <input checked="" type="checkbox"/> No <input type="checkbox"/>	
6	Vehicle fueling center has canopy/cover	Yes <input type="checkbox"/> No <input checked="" type="checkbox"/> N/A <input checked="" type="checkbox"/>	Yes <input type="checkbox"/> No <input type="checkbox"/>	
7	Vehicle fueling center has clearly labeled spill kit nearby	Yes <input checked="" type="checkbox"/> No <input type="checkbox"/> N/A <input type="checkbox"/>	Yes <input checked="" type="checkbox"/> No <input type="checkbox"/>	
8	Vehicle fueling center has oil-grease separators in nearby storm drains	Yes <input checked="" type="checkbox"/> No <input type="checkbox"/> N/A <input type="checkbox"/>	Yes <input checked="" type="checkbox"/> No <input type="checkbox"/>	

### Hazardous Waste Management

	Activity/Practice	Inspected?	Activity/ Practice Adequate?	Corrective Action Needed & Notes
1	Hazardous materials and containers are stored indoors	Yes <input checked="" type="checkbox"/> No <input type="checkbox"/> N/A <input type="checkbox"/>	Yes <input checked="" type="checkbox"/> No <input type="checkbox"/>	
2	Containers of hazardous materials are in good condition	Yes <input checked="" type="checkbox"/> No <input type="checkbox"/> N/A <input type="checkbox"/>	Yes <input checked="" type="checkbox"/> No <input type="checkbox"/>	

### Waste Management

	Activity/Practice	Inspected?	Activity/ Practice Adequate?	Corrective Action Needed & Notes
1	Dumpsters are covered	Yes <input checked="" type="checkbox"/> No <input type="checkbox"/> N/A <input type="checkbox"/>	Yes <input checked="" type="checkbox"/> No <input type="checkbox"/>	
2	Full dumpsters are hauled out on a regular basis	Yes <input checked="" type="checkbox"/> No <input type="checkbox"/> N/A <input type="checkbox"/>	Yes <input checked="" type="checkbox"/> No <input type="checkbox"/>	
3	Piles of miscellaneous debris are sorted and disposed of on a regular basis	Yes <input checked="" type="checkbox"/> No <input type="checkbox"/> N/A <input type="checkbox"/>	Yes <input checked="" type="checkbox"/> No <input type="checkbox"/>	
4	Street sweepings are covered	Yes <input checked="" type="checkbox"/> No <input type="checkbox"/> N/A <input type="checkbox"/>	Yes <input checked="" type="checkbox"/> No <input type="checkbox"/>	
5	Street sweepings are stored in containers or have barriers or perimeter controls to minimize runoff impacts	Yes <input checked="" type="checkbox"/> No <input type="checkbox"/> N/A <input type="checkbox"/>	Yes <input checked="" type="checkbox"/> No <input type="checkbox"/>	

### Material Storage

	Activity/Practice	Inspected?	Activity/ Practice Adequate?	Corrective Action Needed & Notes
1	Runoff from bulk storage is contained on low side by barriers, bays or other perimeter controls	Yes <input checked="" type="checkbox"/> No <input type="checkbox"/> N/A <input type="checkbox"/>	Yes <input checked="" type="checkbox"/> No <input type="checkbox"/>	
2	Bulk storage piles are stabilized/vegetated	Yes <input checked="" type="checkbox"/> No <input type="checkbox"/> N/A <input type="checkbox"/>	Yes <input checked="" type="checkbox"/> No <input type="checkbox"/>	
3	Materials stored under cover/inside buildings	Yes <input checked="" type="checkbox"/> No <input type="checkbox"/> N/A <input type="checkbox"/>	Yes <input checked="" type="checkbox"/> No <input type="checkbox"/>	
4	Area near salt shed is clear of excess/spilled/tracked salt	Yes <input checked="" type="checkbox"/> No <input type="checkbox"/> N/A <input type="checkbox"/>	Yes <input checked="" type="checkbox"/> No <input type="checkbox"/>	

5	Excess/spilled/tracked salt is swept up and added to bulk salt pile	Yes <input checked="" type="checkbox"/> No <input type="checkbox"/> N/A <input type="checkbox"/>	Yes <input checked="" type="checkbox"/> No <input type="checkbox"/>	
6	Underground runoff containment is emptied on a regular basis	Yes <input checked="" type="checkbox"/> No <input type="checkbox"/> N/A <input type="checkbox"/>	Yes <input checked="" type="checkbox"/> No <input type="checkbox"/>	

### Runoff Controls

	Activity/Practice	Inspected?	Activity/Practice Adequate?	Corrective Action Needed & Notes
1	Grass filter strips have at least 70% uniform vegetation growth	Yes <input type="checkbox"/> No <input type="checkbox"/> N/A <input checked="" type="checkbox"/>	Yes <input type="checkbox"/> No <input type="checkbox"/>	
2	Grass filter strips typically have 6 inches or more of vegetation	Yes <input type="checkbox"/> No <input type="checkbox"/> N/A <input checked="" type="checkbox"/>	Yes <input type="checkbox"/> No <input type="checkbox"/>	
3	Storm water pond inlets/outlets are stable	Yes <input type="checkbox"/> No <input type="checkbox"/> N/A <input checked="" type="checkbox"/>	Yes <input type="checkbox"/> No <input type="checkbox"/>	
4	Storm water berms are vegetated	Yes <input type="checkbox"/> No <input type="checkbox"/> N/A <input checked="" type="checkbox"/>	Yes <input type="checkbox"/> No <input type="checkbox"/>	
5	Storm water pond berms are stable (no erosion, tree roots or animal boroughs)	Yes <input type="checkbox"/> No <input type="checkbox"/> N/A <input checked="" type="checkbox"/>	Yes <input type="checkbox"/> No <input type="checkbox"/>	
6	Infiltration basins/rain gardens have at least 70% plant growth	Yes <input type="checkbox"/> No <input type="checkbox"/> N/A <input checked="" type="checkbox"/>	Yes <input type="checkbox"/> No <input type="checkbox"/>	
7	Infiltration basins/rain gardens are maintained regularly, and in the spring and fall	Yes <input type="checkbox"/> No <input type="checkbox"/> N/A <input checked="" type="checkbox"/>	Yes <input type="checkbox"/> No <input type="checkbox"/>	
8	Infiltration basins/rain gardens drain down within 24 hours ( <i>based on post-rain event observations</i> )	Yes <input type="checkbox"/> No <input type="checkbox"/> N/A <input checked="" type="checkbox"/>	Yes <input type="checkbox"/> No <input type="checkbox"/>	

### Spills Program

	Activity/Practice	Inspected?	Activity/Practice Adequate?	Corrective Action Needed & Notes
1	Written program is available for employees	Yes <input checked="" type="checkbox"/> No <input type="checkbox"/> N/A <input type="checkbox"/>	Yes <input checked="" type="checkbox"/> No <input type="checkbox"/>	
2	Employees know where written program is located	Yes <input checked="" type="checkbox"/> No <input type="checkbox"/> N/A <input type="checkbox"/>	Yes <input checked="" type="checkbox"/> No <input type="checkbox"/>	
3	Written program is evaluated annually	Yes <input checked="" type="checkbox"/> No <input type="checkbox"/> N/A <input type="checkbox"/>	Yes <input checked="" type="checkbox"/> No <input type="checkbox"/>	

### Employee Training

	Activity/Practice	Inspected?	Activity/Practice Adequate?	Corrective Action Needed & Notes

1	New employees are trained on SWPPP	Yes <input checked="" type="checkbox"/> No <input type="checkbox"/> N/A <input type="checkbox"/>	Yes <input checked="" type="checkbox"/> No <input type="checkbox"/>	
2	Annual or more frequent training provided to employees on SWPPP	Yes <input checked="" type="checkbox"/> No <input type="checkbox"/> N/A <input type="checkbox"/>	Yes <input checked="" type="checkbox"/> No <input type="checkbox"/>	

This inspection was used as annual training for seven staff members.

	Recommendations/Correction	Completed On (Date)	Initials
1	<b>One new staff member was trained as part of todays inspection.</b>		
2			
3			
4			
5			
6			
7			
8			
9			
10			

## STORM WATER POLLUTION PREVENTION PLAN (SWPPP) INSPECTION FORM FOR MUNICIPAL FACILITIES

Site:	Village of Mukwonago DPW Yard
Location:	630 Veterans Way E.
Inspector/Title:	Ron Bittner/Public Works Director
Date:	9/21/23
Last Inspection (Date):	7/18/23

### Storm Water Pollution Prevention Plan

Has a storm water pollution prevention plan been developed for this site? Yes  No

Title of Plan: Village of Mukwonago SWPPP for Municipal Facilities

Date of Plan: April 2016

Does the SWPP include a site map, list of pollutant sources, pollutant control practices to be inspected, and maintenance procedures? Yes  No

(Indicate any items that are *not* included):

### Vehicle Maintenance, Washing and Fueling

	Activity/Practice	Inspected?	Activity/ Practice Adequate?	Corrective Action Needed & Notes
1	Vehicle maintenance area drains to sanitary sewer system	Yes <input checked="" type="checkbox"/> No <input type="checkbox"/> N/A <input type="checkbox"/>	Yes <input checked="" type="checkbox"/> No <input type="checkbox"/>	
2	Vehicle maintenance area has oil-grease separator in floor drains	Yes <input checked="" type="checkbox"/> No <input type="checkbox"/> N/A <input type="checkbox"/>	Yes <input checked="" type="checkbox"/> No <input type="checkbox"/>	
3	Floor drains are clean	Yes <input checked="" type="checkbox"/> No <input type="checkbox"/> N/A <input type="checkbox"/>	Yes <input checked="" type="checkbox"/> No <input type="checkbox"/>	
4	Vehicle washing completed inside building	Yes <input checked="" type="checkbox"/> No <input type="checkbox"/> N/A <input type="checkbox"/>	Yes <input checked="" type="checkbox"/> No <input type="checkbox"/>	
5	Vehicle washing drains to sanitary system	Yes <input checked="" type="checkbox"/> No <input type="checkbox"/> N/A <input type="checkbox"/>	Yes <input checked="" type="checkbox"/> No <input type="checkbox"/>	
6	Vehicle fueling center has canopy/cover	Yes <input type="checkbox"/> No <input checked="" type="checkbox"/> N/A <input type="checkbox"/>	Yes <input type="checkbox"/> No <input type="checkbox"/>	
7	Vehicle fueling center has clearly labeled spill kit nearby	Yes <input checked="" type="checkbox"/> No <input type="checkbox"/> N/A <input type="checkbox"/>	Yes <input checked="" type="checkbox"/> No <input type="checkbox"/>	
8	Vehicle fueling center has oil-grease separators in nearby storm drains	Yes <input type="checkbox"/> No <input type="checkbox"/> N/A <input checked="" type="checkbox"/>	Yes <input type="checkbox"/> No <input type="checkbox"/>	



### Hazardous Waste Management

	Activity/Practice	Inspected?	Activity/ Practice Adequate?	Corrective Action Needed & Notes
1	Hazardous materials and containers are stored indoors	Yes <input checked="" type="checkbox"/> No <input type="checkbox"/> N/A <input type="checkbox"/>	Yes <input checked="" type="checkbox"/> No <input type="checkbox"/>	
2	Containers of hazardous materials are in good condition	Yes <input checked="" type="checkbox"/> No <input type="checkbox"/> N/A <input type="checkbox"/>	Yes <input checked="" type="checkbox"/> No <input type="checkbox"/>	

### Waste Management

	Activity/Practice	Inspected?	Activity/ Practice Adequate?	Corrective Action Needed & Notes
1	Dumpsters are covered	Yes <input checked="" type="checkbox"/> No <input type="checkbox"/> N/A <input type="checkbox"/>	Yes <input checked="" type="checkbox"/> No <input type="checkbox"/>	
2	Full dumpsters are hauled out on a regular basis	Yes <input checked="" type="checkbox"/> No <input type="checkbox"/> N/A <input type="checkbox"/>	Yes <input checked="" type="checkbox"/> No <input type="checkbox"/>	
3	Piles of miscellaneous debris are sorted and disposed of on a regular basis	Yes <input checked="" type="checkbox"/> No <input type="checkbox"/> N/A <input type="checkbox"/>	Yes <input checked="" type="checkbox"/> No <input type="checkbox"/>	
4	Street sweepings are covered	Yes <input checked="" type="checkbox"/> No <input type="checkbox"/> N/A <input type="checkbox"/>	Yes <input checked="" type="checkbox"/> No <input type="checkbox"/>	
5	Street sweepings are stored in containers or have barriers or perimeter controls to minimize runoff impacts	Yes <input checked="" type="checkbox"/> No <input type="checkbox"/> N/A <input type="checkbox"/>	Yes <input checked="" type="checkbox"/> No <input type="checkbox"/>	

### Material Storage

	Activity/Practice	Inspected?	Activity/ Practice Adequate?	Corrective Action Needed & Notes
1	Runoff from bulk storage is contained on low side by barriers, bays or other perimeter controls	Yes <input type="checkbox"/> No <input type="checkbox"/> N/A <input type="checkbox"/>	Yes <input checked="" type="checkbox"/> No <input type="checkbox"/>	
2	Bulk storage piles are stabilized/vegetated	Yes <input checked="" type="checkbox"/> No <input type="checkbox"/> N/A <input type="checkbox"/>	Yes <input checked="" type="checkbox"/> No <input type="checkbox"/>	
3	Materials stored under cover/inside buildings	Yes <input checked="" type="checkbox"/> No <input type="checkbox"/> N/A <input type="checkbox"/>	Yes <input checked="" type="checkbox"/> No <input type="checkbox"/>	
4	Area near salt shed is clear of excess/spilled/tracked salt	Yes <input checked="" type="checkbox"/> No <input type="checkbox"/> N/A <input type="checkbox"/>	Yes <input checked="" type="checkbox"/> No <input type="checkbox"/>	

5	Excess/spilled/tracked salt is swept up and added to bulk salt pile	Yes <input checked="" type="checkbox"/> No <input type="checkbox"/> N/A <input type="checkbox"/>	Yes <input checked="" type="checkbox"/> No <input type="checkbox"/>	
6	Underground runoff containment is emptied on a regular basis	Yes <input type="checkbox"/> No <input type="checkbox"/> N/A <input checked="" type="checkbox"/>	Yes <input type="checkbox"/> No <input type="checkbox"/>	

### Runoff Controls

	Activity/Practice	Inspected?	Activity/Practice Adequate?	Corrective Action Needed & Notes
1	Grass filter strips have at least 70% uniform vegetation growth	Yes <input type="checkbox"/> No <input type="checkbox"/> N/A <input checked="" type="checkbox"/>	Yes <input type="checkbox"/> No <input type="checkbox"/>	
2	Grass filter strips typically have 6 inches or more of vegetation	Yes <input type="checkbox"/> No <input type="checkbox"/> N/A <input checked="" type="checkbox"/>	Yes <input type="checkbox"/> No <input type="checkbox"/>	
3	Storm water pond inlets/outlets are stable	Yes <input type="checkbox"/> No <input type="checkbox"/> N/A <input checked="" type="checkbox"/>	Yes <input type="checkbox"/> No <input type="checkbox"/>	
4	Storm water berms are vegetated	Yes <input type="checkbox"/> No <input type="checkbox"/> N/A <input checked="" type="checkbox"/>	Yes <input type="checkbox"/> No <input type="checkbox"/>	
5	Storm water pond berms are stable (no erosion, tree roots or animal borrows)	Yes <input type="checkbox"/> No <input type="checkbox"/> N/A <input checked="" type="checkbox"/>	Yes <input type="checkbox"/> No <input type="checkbox"/>	
6	Infiltration basins/rain gardens have at least 70% plant growth	Yes <input type="checkbox"/> No <input type="checkbox"/> N/A <input checked="" type="checkbox"/>	Yes <input type="checkbox"/> No <input type="checkbox"/>	
7	Infiltration basins/rain gardens are maintained regularly, and in the spring and fall	Yes <input type="checkbox"/> No <input type="checkbox"/> N/A <input checked="" type="checkbox"/>	Yes <input type="checkbox"/> No <input type="checkbox"/>	
8	Infiltration basins/rain gardens drain down within 24 hours ( <i>based on post-rain event observations</i> )	Yes <input type="checkbox"/> No <input type="checkbox"/> N/A <input checked="" type="checkbox"/>	Yes <input type="checkbox"/> No <input type="checkbox"/>	

### Spills Program

	Activity/Practice	Inspected?	Activity/Practice Adequate?	Corrective Action Needed & Notes
1	Written program is available for employees	Yes <input checked="" type="checkbox"/> No <input type="checkbox"/> N/A <input type="checkbox"/>	Yes <input checked="" type="checkbox"/> No <input type="checkbox"/>	
2	Employees know where written program is located	Yes <input checked="" type="checkbox"/> No <input type="checkbox"/> N/A <input type="checkbox"/>	Yes <input checked="" type="checkbox"/> No <input type="checkbox"/>	
3	Written program is evaluated annually	Yes <input checked="" type="checkbox"/> No <input type="checkbox"/> N/A <input type="checkbox"/>	Yes <input checked="" type="checkbox"/> No <input type="checkbox"/>	

### Employee Training

	Activity/Practice	Inspected?	Activity/Practice Adequate?	Corrective Action Needed & Notes

1	New employees are trained on SWPPP	Yes <input checked="" type="checkbox"/> No <input type="checkbox"/> N/A <input type="checkbox"/>	Yes <input checked="" type="checkbox"/> No <input type="checkbox"/>	
2	Annual or more frequent training provided to employees on SWPPP	Yes <input type="checkbox"/> No <input type="checkbox"/> N/A <input type="checkbox"/>	Yes <input type="checkbox"/> No <input type="checkbox"/>	

This inspection was used as annual training for seven staff members.

	Recommendations/Correction	Completed On (Date)	Initials
1			
2			
3			
4			
5			
6			
7			
8			
9			
10			

## STORM WATER POLLUTION PREVENTION PLAN (SWPPP) INSPECTION FORM FOR MUNICIPAL FACILITIES

Site:	Village of Mukwonago DPW Yard
Location:	630 Veterans Way E.
Inspector/Title:	Ron Bittner/Public Works Director
Date:	12/4/23
Last Inspection (Date):	9/21/23

### Storm Water Pollution Prevention Plan

Has a storm water pollution prevention plan been developed for this site? Yes  No

Title of Plan: Village of Mukwonago SWPPP for Municipal Facilities

Date of Plan: April 2016

Does the SWPP include a site map, list of pollutant sources, pollutant control practices to be inspected, and maintenance procedures? Yes  No

(Indicate any items that are *not* included):

### Vehicle Maintenance, Washing and Fueling

	Activity/Practice	Inspected?	Activity/ Practice Adequate?	Corrective Action Needed & Notes
1	Vehicle maintenance area drains to sanitary sewer system	Yes <input checked="" type="checkbox"/> No <input type="checkbox"/> N/A <input type="checkbox"/>	Yes <input checked="" type="checkbox"/> No <input type="checkbox"/>	
2	Vehicle maintenance area has oil-grease separator in floor drains	Yes <input checked="" type="checkbox"/> No <input type="checkbox"/> N/A <input type="checkbox"/>	Yes <input checked="" type="checkbox"/> No <input type="checkbox"/>	
3	Floor drains are clean	Yes <input checked="" type="checkbox"/> No <input type="checkbox"/> N/A <input type="checkbox"/>	Yes <input checked="" type="checkbox"/> No <input type="checkbox"/>	
4	Vehicle washing completed inside building	Yes <input checked="" type="checkbox"/> No <input type="checkbox"/> N/A <input type="checkbox"/>	Yes <input checked="" type="checkbox"/> No <input type="checkbox"/>	
5	Vehicle washing drains to sanitary system	Yes <input checked="" type="checkbox"/> No <input type="checkbox"/> N/A <input type="checkbox"/>	Yes <input checked="" type="checkbox"/> No <input type="checkbox"/>	
6	Vehicle fueling center has canopy/cover	Yes <input type="checkbox"/> No <input checked="" type="checkbox"/> N/A <input type="checkbox"/>	Yes <input type="checkbox"/> No <input type="checkbox"/>	
7	Vehicle fueling center has clearly labeled spill kit nearby	Yes <input checked="" type="checkbox"/> No <input type="checkbox"/> N/A <input type="checkbox"/>	Yes <input checked="" type="checkbox"/> No <input type="checkbox"/>	
8	Vehicle fueling center has oil-grease separators in nearby storm drains	Yes <input type="checkbox"/> No <input type="checkbox"/> N/A <input checked="" type="checkbox"/>	Yes <input type="checkbox"/> No <input type="checkbox"/>	

### Hazardous Waste Management

	Activity/Practice	Inspected?	Activity/ Practice Adequate?	Corrective Action Needed & Notes
1	Hazardous materials and containers are stored indoors	Yes <input checked="" type="checkbox"/> No <input type="checkbox"/> N/A <input type="checkbox"/>	Yes <input checked="" type="checkbox"/> No <input type="checkbox"/>	
2	Containers of hazardous materials are in good condition	Yes <input checked="" type="checkbox"/> No <input type="checkbox"/> N/A <input type="checkbox"/>	Yes <input checked="" type="checkbox"/> No <input type="checkbox"/>	

### Waste Management

	Activity/Practice	Inspected?	Activity/ Practice Adequate?	Corrective Action Needed & Notes
1	Dumpsters are covered	Yes <input checked="" type="checkbox"/> No <input type="checkbox"/> N/A <input type="checkbox"/>	Yes <input checked="" type="checkbox"/> No <input type="checkbox"/>	
2	Full dumpsters are hauled out on a regular basis	Yes <input checked="" type="checkbox"/> No <input type="checkbox"/> N/A <input type="checkbox"/>	Yes <input checked="" type="checkbox"/> No <input type="checkbox"/>	
3	Piles of miscellaneous debris are sorted and disposed of on a regular basis	Yes <input checked="" type="checkbox"/> No <input type="checkbox"/> N/A <input type="checkbox"/>	Yes <input checked="" type="checkbox"/> No <input type="checkbox"/>	
4	Street sweepings are covered	Yes <input checked="" type="checkbox"/> No <input type="checkbox"/> N/A <input type="checkbox"/>	Yes <input checked="" type="checkbox"/> No <input type="checkbox"/>	
5	Street sweepings are stored in containers or have barriers or perimeter controls to minimize runoff impacts	Yes <input checked="" type="checkbox"/> No <input type="checkbox"/> N/A <input type="checkbox"/>	Yes <input checked="" type="checkbox"/> No <input type="checkbox"/>	

### Material Storage

	Activity/Practice	Inspected?	Activity/ Practice Adequate?	Corrective Action Needed & Notes
1	Runoff from bulk storage is contained on low side by barriers, bays or other perimeter controls	Yes <input checked="" type="checkbox"/> No <input type="checkbox"/> N/A <input type="checkbox"/>	Yes <input checked="" type="checkbox"/> No <input type="checkbox"/>	
2	Bulk storage piles are stabilized/vegetated	Yes <input checked="" type="checkbox"/> No <input type="checkbox"/> N/A <input type="checkbox"/>	Yes <input checked="" type="checkbox"/> No <input type="checkbox"/>	
3	Materials stored under cover/inside buildings	Yes <input checked="" type="checkbox"/> No <input type="checkbox"/> N/A <input type="checkbox"/>	Yes <input checked="" type="checkbox"/> No <input type="checkbox"/>	
4	Area near salt shed is clear of excess/spilled/tracked salt	Yes <input type="checkbox"/> No <input checked="" type="checkbox"/> N/A <input type="checkbox"/>	Yes <input type="checkbox"/> No <input checked="" type="checkbox"/>	Material needs to be cleaned up after delivery and loading.

5	Excess/spilled/tracked salt is swept up and added to bulk salt pile	Yes <input type="checkbox"/> No <input checked="" type="checkbox"/> N/A <input type="checkbox"/>	Yes <input type="checkbox"/> No <input checked="" type="checkbox"/>	Material needs to be cleaned up after delivery and loading.
6	Underground runoff containment is emptied on a regular basis	Yes <input type="checkbox"/> No <input type="checkbox"/> N/A <input checked="" type="checkbox"/>	Yes <input type="checkbox"/> No <input type="checkbox"/>	

### Runoff Controls

	Activity/Practice	Inspected?	Activity/Practice Adequate?	Corrective Action Needed & Notes
1	Grass filter strips have at least 70% uniform vegetation growth	Yes <input type="checkbox"/> No <input type="checkbox"/> N/A <input checked="" type="checkbox"/>	Yes <input type="checkbox"/> No <input type="checkbox"/>	
2	Grass filter strips typically have 6 inches or more of vegetation	Yes <input type="checkbox"/> No <input type="checkbox"/> N/A <input checked="" type="checkbox"/>	Yes <input type="checkbox"/> No <input type="checkbox"/>	
3	Storm water pond inlets/outlets are stable	Yes <input type="checkbox"/> No <input type="checkbox"/> N/A <input checked="" type="checkbox"/>	Yes <input type="checkbox"/> No <input type="checkbox"/>	
4	Storm water berms are vegetated	Yes <input type="checkbox"/> No <input type="checkbox"/> N/A <input checked="" type="checkbox"/>	Yes <input type="checkbox"/> No <input type="checkbox"/>	
5	Storm water pond berms are stable (no erosion, tree roots or animal borrows)	Yes <input type="checkbox"/> No <input type="checkbox"/> N/A <input checked="" type="checkbox"/>	Yes <input type="checkbox"/> No <input type="checkbox"/>	
6	Infiltration basins/rain gardens have at least 70% plant growth	Yes <input type="checkbox"/> No <input type="checkbox"/> N/A <input checked="" type="checkbox"/>	Yes <input type="checkbox"/> No <input type="checkbox"/>	
7	Infiltration basins/rain gardens are maintained regularly, and in the spring and fall	Yes <input type="checkbox"/> No <input type="checkbox"/> N/A <input checked="" type="checkbox"/>	Yes <input type="checkbox"/> No <input type="checkbox"/>	
8	Infiltration basins/rain gardens drain down within 24 hours ( <i>based on post-rain event observations</i> )	Yes <input type="checkbox"/> No <input type="checkbox"/> N/A <input checked="" type="checkbox"/>	Yes <input type="checkbox"/> No <input type="checkbox"/>	

### Spills Program

	Activity/Practice	Inspected?	Activity/Practice Adequate?	Corrective Action Needed & Notes
1	Written program is available for employees	Yes <input checked="" type="checkbox"/> No <input type="checkbox"/> N/A <input type="checkbox"/>	Yes <input checked="" type="checkbox"/> No <input type="checkbox"/>	
2	Employees know where written program is located	Yes <input checked="" type="checkbox"/> No <input type="checkbox"/> N/A <input type="checkbox"/>	Yes <input checked="" type="checkbox"/> No <input type="checkbox"/>	
3	Written program is evaluated annually	Yes <input checked="" type="checkbox"/> No <input type="checkbox"/> N/A <input type="checkbox"/>	Yes <input checked="" type="checkbox"/> No <input type="checkbox"/>	

### Employee Training

	Activity/Practice	Inspected?	Activity/Practice Adequate?	Corrective Action Needed & Notes

1	New employees are trained on SWPPP	Yes <input checked="" type="checkbox"/> No <input type="checkbox"/> N/A <input type="checkbox"/>	Yes <input checked="" type="checkbox"/> No <input type="checkbox"/>	
2	Annual or more frequent training provided to employees on SWPPP	Yes <input type="checkbox"/> No <input type="checkbox"/> N/A <input type="checkbox"/>	Yes <input type="checkbox"/> No <input type="checkbox"/>	

This inspection was used as annual training for seven staff members.

	Recommendations/Correction	Completed On (Date)	Initials
1	Better housekeeping on spilled salt needs to be practiced. The area needs to be swept and cleaned up the day of the spill.	12/4/23	RRB
2			
3			
4			
5			
6			
7			
8			
9			
10			

2.6.1 Village of Mukwonago Structure List

\*Facilities with Storm Water Maintenance Agreements (SWMA) are included in the Village's water quality reduction calculations.

Device ID	Device Type	Year Constructed	Subdivision	Location	Name	Email Address	Contacts Name	Address	City, State, Zip	SWMA on File	Drawing on File
3	WET POND	2017	Fairwinds	Stoker Farm Ave. & Rosewood Dr.	1F4-K20194F4-K128F4-K21F4-K22F4-K23F4-K24F4-K128	Fairwinds.Mukwonago@villageofmukwonago.com	David Schultz	522 WESTLAWN AVE	Mukwonago, WI 53149	Yes	Yes
4	WET POND	2017	Fairwinds	Stoker Farm Ave. & Rosewood Dr.		Fairwinds.Mukwonago@villageofmukwonago.com	David Schultz	522 WESTLAWN AVE	Mukwonago, WI 53149	Yes	Yes
2	WET POND	2001	Fairwinds	Fairwinds BLVD. & Stoker Farm Ave.		Fairwinds.Mukwonago@villageofmukwonago.com	David Schultz	522 WESTLAWN AVE	Mukwonago, WI 53149	Yes	No
1	WET POND	2001	Fairwinds	Fairwinds BLVD. & Stoker Farm Ave.		Fairwinds.Mukwonago@villageofmukwonago.com	David Schultz	522 WESTLAWN AVE	Mukwonago, WI 53149	Yes	No
18	WET POND	2012	Minors Estates ADD #3 Minors West HOA	Augusta Dr.	MINORS HOMESTEAD WEST HOMEOWNERS ASSOC	minorswest@yahoo.com	KEVIN C TRAPP	724 PNEHURST DR	MUKWONAGO, WI 53145-0683	Yes	Yes
15	WET POND	2005	Minors Estates ADD #1 Minors West HOA	Brookway Dr.	MINORS HOMESTEAD WEST HOMEOWNERS ASSOC	minorswest@yahoo.com	KEVIN C TRAPP	724 PNEHURST DR	MUKWONAGO, WI 53145-0683	Yes	No
14	WET POND	2005	Minors Estates ADD #1 Minors West HOA	Brookway Dr. & North of CTH LO	MINORS HOMESTEAD WEST HOMEOWNERS ASSOC	minorswest@yahoo.com	KEVIN C TRAPP	724 PNEHURST DR	MUKWONAGO, WI 53145-0683	Yes	No
13	WET POND	2005	Minors Estates ADD #1 Minors West HOA	Brookway Dr. & CTH LO	MINORS HOMESTEAD WEST HOMEOWNERS ASSOC	minorswest@yahoo.com	KEVIN C TRAPP	724 PNEHURST DR	MUKWONAGO, WI 53145-0683	Yes	No
12	WET POND	2003	Minors Homesstead	Minors Dr. & CTH LO	MINORS HOMESTEAD WEST HOMEOWNERS ASSOC	minorswest@yahoo.com	KEVIN C TRAPP	724 PNEHURST DR	MUKWONAGO, WI 53145-0683	Yes	No
17	WET POND	2005	Minors Estates ADD #2 Minors West HOA	Vallhalla Dr.	MINORS HOMESTEAD WEST HOMEOWNERS ASSOC	minorswest@yahoo.com	KEVIN C TRAPP	724 PNEHURST DR	MUKWONAGO, WI 53145-0683	Yes	No
16	WET POND	2005	Minors Estates ADD #2 Minors West HOA	Vallhalla Dr.	MINORS HOMESTEAD WEST HOMEOWNERS ASSOC	minorswest@yahoo.com	KEVIN C TRAPP	724 PNEHURST DR	MUKWONAGO, WI 53145-0683	Yes	No
20	INFILTRATION BASIN	2003	Honey Meadow	W Side Ave	ASSOC 88-00-VESMIK-442		Real Estate Specialists	PO BOX 7571	HICKSVILLE, NY 11802-7571	Yes	No
47	WET POND	2003	State of WI	S. Rochester St. & Front St.	WISCONSIN HWY COMMISSION		Brooklife Church	PO BOX 7910	MADISON, WI 53707-7910	Yes	No
8	WET POND	2005	The Glen of Mukwonago	Black Bear Dr	Real Estate Specialists	RealEstateSpecialists@gmail.com	Real Estate Specialists	131 E. Wisconsin Ave	Pewaukee WI 53072	Yes	Yes
5	WET POND	ORIG2001 RETROFIT2020	Village Owned	E. Veterans Way	Village of Mukwonago	villageofmukwonago@gmail.com	Brooklife Church	440 River Crest Ct	Mukwonago, WI 53149	Yes	Yes
45	WET POND	1993	Brooklife Church	877 S. Rochester St	Brooklife Church	villageofmukwonago@gmail.com	Brooklife Church	440 River Crest Ct	Mukwonago, WI 53149	Yes	Yes
46	WET POND	2003	State of WI	S. Rochester St. & Mukwonago River	WISCONSIN HWY COMMISSION		Brooklife Church	440 River Crest Ct	Mukwonago, WI 53149	Yes	No
48	WET POND	1999	State of WI	Holz Pkwy. & Park and Ride	WISCONSIN HWY COMMISSION		Brooklife Church	440 River Crest Ct	Mukwonago, WI 53149	Yes	No
53	WET POND	1995	Village Owned	Minwaukan Park Middle	Village of Mukwonago	villageofmukwonago@gmail.com	Brooklife Church	440 River Crest Ct	Mukwonago, WI 53149	Yes	Yes
52	WET POND	1995	Village Owned	Minwaukan Park East	Village of Mukwonago	villageofmukwonago@gmail.com	Brooklife Church	440 River Crest Ct	Mukwonago, WI 53149	Yes	Yes
54	WET POND	1995	Village Owned	Minwaukan Park West	Village of Mukwonago	villageofmukwonago@gmail.com	Brooklife Church	440 River Crest Ct	Mukwonago, WI 53149	Yes	Yes
49	WET POND	1999	Village Owned	Holz Pkwy. South of Mukwonago River	Village of Mukwonago	villageofmukwonago@gmail.com	Brooklife Church	440 River Crest Ct	Mukwonago, WI 53149	Yes	No
37	WET POND	2003	WalmarHome Depot	250 East Wolf Run	WAL-MART REAL ESTATE BUSINESS TRUST	walmartrealstatebusiness@gmail.com	WAL-MART REAL ESTATE BUSINESS TRUST	PO BOX 8056	BENTONVILLE, AR 72712-8056	NO	No
40	WET POND	2003	Village Owned	Earl Termini of E. Wolf Run	HOME DEPOT USA INC PARTNERSHIP	home depot usa inc	HOME DEPOT USA INC.	PO 2440	SPOKANE WA 99210	NO	No
51	WET POND	1999	Village Owned	Holz Pkwy. N. of Mukwonago River	Village of Mukwonago	villageofmukwonago@gmail.com	GREENWALD FAMILY LIMITED PARTNERSHIP	632 OAKLAND AVE	MUKWONAGO, WI 53148-1246	NO	No
50	WET POND	1999	Village Owned	Holz Pkwy. N. of Mukwonago River	Village of Mukwonago	villageofmukwonago@gmail.com	GREENWALD FAMILY LIMITED PARTNERSHIP	440 River Crest Ct	Mukwonago, WI 53149	Village Owned	Yes
21	WET POND	1992	Whispering Bay Corobas	1024 Bay View Ct	Village of Mukwonago	villageofmukwonago@gmail.com	Real Estate Specialists	440 River Crest Ct	Mukwonago, WI 53149	Village Owned	No
23	WET POND	2016	Premier Woods Acrs	540 Phantom Woods Rd.	Real Estate Specialists	RealEstateSpecialists@gmail.com	Real Estate Specialists	131 E Wisconsin Ave	Pewaukee WI 53072	NO	No
28	WET POND	2006	Orchards #1	1414 Applewood Cr	HOMEOWNERS ASSOC		Jason Christensen	3120 GATEWAY RD	BROOKFIELD, WI 53045-5112	Yes	No
30	WET POND	2007	Orchards #1	1304 Orchardview Ln	ORCHARDS OF MUKWONAGO HOMEOWNERS ASSOC		Jason Christensen	Address	City, State, Zip	SWMA on File	SWMA on File
31	WET POND	2007	Orchards #1	1334 Cider Circle	ORCHARDS OF MUKWONAGO HOMEOWNERS ASSOC		Jason Christensen	1331 CIDER CIRCLE	MUKWONAGO, WI 53149	Yes	No
28	WET POND	2006	Orchards #1	1414 Applewood Cr	HOMEOWNERS ASSOC		Jason Christensen	1331 CIDER CIRCLE	MUKWONAGO, WI 53149	Yes	No



Device ID	Device Type	Subdivision	Location	Name 1	Address	City, State, Zip	Yes	No
29	WET POND	Orchards #1	1446 Applewood Cr.	ORCHARDS OF MUKWONAGO HOMEOWNERS ASSOC	Jason Christensen	MUKWONAGO, WI 53149	Yes	No
33	WET POND	Legend Meadows	Bear Pass	LEGEND MEADOWS ASSOC	LEGEND MEADOWS ASSOC INC	Waukesha, WI 53189	Yes	No
36	WET POND	Pro Health	DNG Medical Ct, 240 Maple Ave	WAUKESHA MEMORIAL HOSPITAL	WAUKESHA MEMORIAL HOSPITAL	WAUKESHA, WI 53188	Yes	No
58	WET POND	Fox River View	1623 Fox River Run	Fox River View HOA	LARRY ALBER	WAUKESHA, WI 53187-0955	Yes	No
59	WET POND	Edgewood Condos	Grey Fox Trail	EDGEWOOD MEADOWS CONDO ASSN	Urban Land & Property Management	Waukesha, WI 53225	Yes	Yes
61	WET POND	Edgewood Condos	Grey Fox Trail	EDGEWOOD MEADOWS CONDO ASSN	Urban Land & Property Management	Waukesha, WI 53225	Yes	Yes
7	INFILTRATION BASIN	The Glen of Mukwonago	Black Bear Dr.	Real Estate Specialists	Real Estate Specialists	Pewaukee WI 53072	Yes	Yes
11	INFILTRATION BASIN	Minors Homestead	Minors Dr.	MINORS HOMESTEAD HOMEOWNERS ASSOC	BBB INVESTMENT PROPERTIES	MUKWONAGO, WI 53149-0412	Yes	No
43	WET POND	400 Bay View Rd.	400 Bay View Rd.	B&E INVESTMENT PROPERTIES	BBB INVESTMENT PROPERTIES	GREENDALE, WI 53129-2135	Yes	No
41	WET POND	Chelsea Lynn Parkway	325 Bayview Rd - Chelsea Lynn Parkway	MB KLUM INVESTMENTS LLC	MB KLUM INVESTMENTS LLC	231 N. GRANDVIEW BLVD SUITE 222 PEWAUKEE, WI 53072-5585	Yes	No
35	WET POND	State of WI	STH 83 & E Wolf Run	WISCONSIN HWY COMMISSION		PO BOX 7910	Yes	No
34	WET POND	Drewy Dr. Industrial Park	Drewy Drive	Village of Mukwonago	JAMES PAUER	MADISON, WI 53707-7910	Yes	No
32	WET POND	Orchards #2	CTH ES/Regressa Rd	The Orchard's 2 Owners Assoc		440 River Crest Ct	Yes	Yes
25	WET POND	Premier Apts	540 Phantom Woods Rd.	TW PHANTOM WOODS LLC		Mukwonago, WI 53149	Yes	Yes
22	WET POND	Premier Apts	540 Phantom Woods Rd	TW PHANTOM WOODS LLC		Mukwonago, WI 53149	Yes	Yes
24	WET POND	Premier Apts	540 Phantom Woods Rd	TW PHANTOM WOODS LLC		Mukwonago, WI 53149	Yes	Yes
9	INFILTRATION BASIN	Hawks Ridge East	E. Veterans Way	HAWKS RIDGE EAST		700 LARRY COURT	Yes	No
38	WET POND	Mukwonago YMCA	245 E. Wolf Run	MUKWONAGO YMCA		245 EAST WOLF RUN	Yes	Yes
39	INFILTRATION BASIN	Mukwonago YMCA	245 E. Wolf Run	MUKWONAGO YMCA		245 EAST WOLF RUN	Yes	Yes
27	INFILTRATION BASIN	Mosler Properties	1340 Main St.	LOT OWNERS OF M&M PROPERTIES	LOT OWNERS OF M&M PROPERTIES	LOT OWNERS OF M&M PROPERTIES S107W04850 S SHORE DR	Yes	No
26	INFILTRATION BASIN	Mosler Properties	1340 Main St.	LOT OWNERS OF M&M PROPERTIES	LOT OWNERS OF M&M PROPERTIES	PO BOX 178	Yes	No
42	WET POND	SCHMIDT & BARTELT	930 Main St	SCHMIDT & BARTELT	SCHMIDT & BARTELT	MUKWONAGO, WI 53149	Yes	Yes
55	WET POND	IDC	600 Perkins Dr	NFC REPTAL ESTATE LLC	NFC REPTAL ESTATE LLC	ST JOSEPH, MO 64501-2337	Yes	Yes
56	WET POND	Ridgebow	708 Swan Dr.	BASETTI HOLDING GROUP INC	BASETTI HOLDING GROUP INC	MUKWONAGO, WI 53149	No	No
62	WET POND	Badger Color	1007 Fox St.	MADEY ENTERPRISES INC	MADEY ENTERPRISES INC	SAINT JAMES CITY, FL 33566-0075	No	No
63	INFILTRATION BASIN	MCL	Park Ave/Division St.	Village of Mukwonago		Mukwonago, WI 53149	Yes	No
10	INFILTRATION BASIN	District Office	E. Veteran Way	MUKWONAGO AREA SCHOOLS		MUKWONAGO, WI 53149	Yes	Yes
6	INFILTRATION BASIN	St Johns Church	E. Veterans Way	ST JOHNS CHURCH		MUKWONAGO, WI 53149	Yes	Yes
70	INFILTRATION BASIN	MINORS HOMESTEAD ADD 3	Medina Drive	MINORS HOMESTEAD WEST HOMEOWNERS ASSOC	KEVIN C TRAPP	MUKWONAGO, WI 53149-9683	Yes	Yes
71	INFILTRATION BASIN	MINORS HOMESTEAD ADD 3	Outlot 13	MINORS HOMESTEAD WEST HOMEOWNERS ASSOC	KEVIN C TRAPP	MUKWONAGO, WI 53149-9683	Yes	No
69	WET POND	ALDI	111 E WOLF RUN	ALDI Inc. Oak Creek Division	ALDI Inc. Oak Creek Division	Oak Creek, WI 53154	Yes	Yes
72	INFILTRATION BASIN	Fire Dept. Station 1	1111 Fox Street	Village of Mukwonago		440 River Crest Ct	Yes	No
64	INFILTRATION BASIN	MHS	Mukwonago Union High	Mukwonago Area Schools		385 CTH NN E	Yes	No

Device ID	Infiltration Basin	Year	MHS	Location	Subdivision	Location	Owner	Contact	Address	City, State, Zip	Ownership	Notes
63	INFILTRATION BASIN	2017	MUKWONAGO AREA SCHOOLS	Mukwonago Union High Schools	Mukwonago	122 Arrowhead Real Estate LLC	Mukwonago	John Somers - somersj@msk12.wi.us	385 CTH NE E	MUKWONAGO, WI 53149	Yes	No
65	INFILTRATION BASIN	2018	122 Arrowhead Real Estate LLC	122 Arrowhead Drive	Mukwonago	STORE MASTER FINDING V LLC	Mukwonago		PO Box 183	Lake Geneva, WI 53147-2183	Yes	Yes
66	INFILTRATION BASIN	2019	Chapman Farms	Chapman Farms	Chapman Farms	STORE MASTER FINDING V LLC	Chapman Farms		470 CHAPMAN FARM BLVD	Mukwonago, WI 53149	Yes	Yes
67	INFILTRATION BASIN	2019	Chapman Farms	Chapman Farms	Chapman Farms	STORE MASTER FINDING V LLC	Chapman Farms		430 CHAPMAN FARM BLVD	Mukwonago, WI 53149	Yes	Yes
68	WET POND	2015	KWIK TRIP	Black Bear Blvd Parkway	Chapman Farms	KWIK TRIP	Chapman Farms		1925 Oak Street	LA CROSSE, WI 54603	Yes	Yes
75	WET POND	2007	Chelsea Lynn Parkway	325 Bayview Rd - Chelsea Lynn Parkway	Chelsea Lynn Parkway	MB KLUM INVESTMENTS LLC	Chelsea Lynn Parkway		231 N. GRANDVIEW BLVD. SUITE 222	PEWAUKEE, WI 53072-5665	Yes/DA	No
73	INFILTRATION BASIN	2007	ANTIGUA REAL	365 BAYVIEW RD	Chelsea Lynn Parkway	JABE LLC	Chelsea Lynn Parkway		W341 S9275 CORNER ST	EAGLE, WI 53119	Yes/DA	No
76	WET POND	2007	Chelsea Lynn Parkway	325 Bayview Rd - Chelsea Lynn Parkway	Chelsea Lynn Parkway	MB KLUM INVESTMENTS LLC	Chelsea Lynn Parkway		231 N. GRANDVIEW BLVD. SUITE 222	PEWAUKEE, WI 53072-5665	Yes/DA	No
77	DRY POND	2004	Village Car Care	J&N Auto	Village Car Care	VILLAGE AUTOMOTIVE LLC	Village Car Care		447 BAY VIEW RD	MUKWONAGO, WI 53149	Yes	No
79	WET POND	2015	Village Owned	Mukwonago High School	Village Owned	Village AUTOMOTIVE LLC	Mukwonago		440 River Crest Ct	Mukwonago, WI 53149	Village Owned	Yes
78	DRY POND	2015	ALDI	111 E WOLF RUN	ALDI Inc. Oak Creek Division	ALDI Inc. Oak Creek Division	ALDI Inc. Oak Creek Division		9342 South 13th Street	Oak Creek, WI 53154	Yes	Yes
80	WET POND	2014	Mikwaukee Tool	Mikwaukee Tool	Mikwaukee Tool	Mikwaukee Tool At: Jeff Searl	Mikwaukee Tool		929 PERKINS DRIVE	MUKWONAGO, WI 53149	Yes	Yes
81	BIOFILTRATION DEVICE	2018	Village Owned	Chapman Farms	Village Owned	Chapman Farms	Chapman Farms		440 River Crest Ct	Mukwonago, WI 53149	Village Owned	Yes
83	WET POND	2019	Village Owned	TD#5 Pond 1	Village Owned	Village AUTOMOTIVE LLC	Chapman Farms		440 River Crest Ct	Mukwonago, WI 53149	Village Owned	Yes
84	WET POND	2019	Box Self Storage	TD# 46 Pond 2	Box Self Storage	THE BOX SELF STORAGE LLC	Chapman Farms		440 River Crest Ct	Mukwonago, WI 53149	Village Owned	Yes
85	WET POND	2019	Box Self Storage	Van Buren Dr.	Box Self Storage	THE BOX SELF STORAGE LLC	Chapman Farms		1955 N. WATER ST.	MILWAUKEE, WI 53202-2061	Yes	Yes
86	WET POND	2018	Village Owned	Chapman Blvd	Village Owned	THE BOX SELF STORAGE LLC	Chapman Farms		1955 N. WATER ST.	MILWAUKEE, WI 53202-2061	Yes	Yes
87	WET POND	2018	Village Owned	Chapman Blvd	Village Owned	THE BOX SELF STORAGE LLC	Chapman Farms		440 River Crest Ct	Mukwonago, WI 53149	Village Owned	In Process
88	WET POND	2018	Village Owned	Chapman Blvd	Village Owned	THE BOX SELF STORAGE LLC	Chapman Farms		440 River Crest Ct	Mukwonago, WI 53149	Village Owned	In Process
89	WET POND	2020	Chapman Farms	Chapman Farms	Chapman Farms	BIELINSKI HOMES INC	Chapman Farms		1830 MEADOW LN STE A	PEWAUKEE, WI 53072	Yes	In Process
90	WET POND	2020	Chapman Farms	Chapman Farms	Chapman Farms	BIELINSKI HOMES INC	Chapman Farms		1830 MEADOW LN STE A	PEWAUKEE, WI 53072	Yes	In Process
92	WET POND	2020	Chapman Farms	Chapman Farms	Chapman Farms	BIELINSKI HOMES INC	Chapman Farms		1830 MEADOW LN STE A	PEWAUKEE, WI 53072	Yes	In Process
89	WET POND	2020	Chapman Farms	Chapman Farms	Chapman Farms	BIELINSKI HOMES INC	Chapman Farms		1830 MEADOW LN STE A	PEWAUKEE, WI 53072	Yes	In Process
93	WET POND	2020	Chapman Farms	Chapman Farms	Chapman Farms	BIELINSKI HOMES INC	Chapman Farms		1830 MEADOW LN STE A	PEWAUKEE, WI 53072	Yes	In Process
94	WET POND	2020	Chapman Farms	Chapman Farms	Chapman Farms	BIELINSKI HOMES INC	Chapman Farms		1830 MEADOW LN STE A	PEWAUKEE, WI 53072	Yes	In Process
95	WET POND	2019	Edgewood Village	Edgewood Ave	Edgewood Village	WEH PROPERTIES	Edgewood Village		PO BOX 437	ELKHORN, WI 53121	Yes	Yes
100	WET POND	2020	Hill Ct	Hill Court Multi-Tenant	Hill Ct	STAG Industrial	STAG Industrial		One Federal Street, FL 23	Boston, MA 02110	Yes	Yes
101	WET POND	2020	Hill Ct	Hill Court Multi-Tenant	Hill Ct	STAG Industrial	STAG Industrial		One Federal Street, FL 23	Boston, MA 02110	Yes	Yes
97	WET POND	2020	Meadowland Townhomes	CTH NN & CTH EE	Meadowland Townhomes	BIELINSKI LLC	Chapman Farms		1830 MEADOW LN STE A	PEWAUKEE, WI 53072	Yes	In Process
98	WET POND	2020	Meadowland Townhomes	CTH NN & CTH EE	Meadowland Townhomes	BIELINSKI LLC	Chapman Farms		1830 MEADOW LN STE A	PEWAUKEE, WI 53072	Yes	In Process
99	WET POND	2019	Meadowland Townhomes	CTH NN & CTH EE	Meadowland Townhomes	BIELINSKI LLC	Chapman Farms		1830 MEADOW LN STE A	PEWAUKEE, WI 53072	Yes	In Process
96	WET POND	2019	Phantom Lakes	Phantom Lakes Preserve	Phantom Lakes	THE POINTE APARTMENTS LLC	Phantom Lakes		142 Phantom Lake Ct	Mukwonago, WI 53149	Yes	Yes
102	WET POND	2019	Pointe Apartments	Pointe Apartments	Pointe Apartments	THE POINTE APARTMENTS LLC	Pointe Apartments		W2468 County Road J	EAST TROY, WI 53120-757	Yes	Yes
103	WET POND	2019	Pointe Apartments	Pointe Apartments	Pointe Apartments	THE POINTE APARTMENTS LLC	Pointe Apartments		W3468 County Road J	EAST TROY, WI 53120-757	Yes	Yes
104	WET POND	2019	Pointe Apartments	Pointe Apartments	Pointe Apartments	THE POINTE APARTMENTS LLC	Pointe Apartments		W3468 County Road J	EAST TROY, WI 53120-757	Yes	Yes
105	WET POND	2019	Storage Works	Mukwonago Dr	Storage Works	STORAGE WORKS MUKWONAGO	Mukwonago Dr		W232 N5040 Quarry Corners Parkway	Lupton, WI 53089	Yes	Yes
106	WET POND	2019	Storage Works	Mukwonago Dr	Storage Works	STORAGE WORKS MUKWONAGO	Mukwonago Dr		W232 N5040 Quarry Corners Parkway	Lupton, WI 53089	Yes	Yes
107	WET POND	2020	Goodwill	101 Arrowhead Dr	Goodwill	SOUTHEASTERN WISCONSIN, INC	Goodwill of SE Wisconsin		101 Arrowhead Dr	Mukwonago, WI 53149	Yes	Yes

